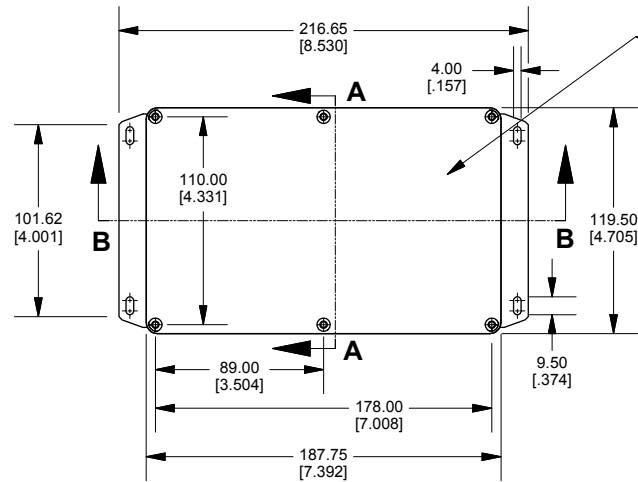
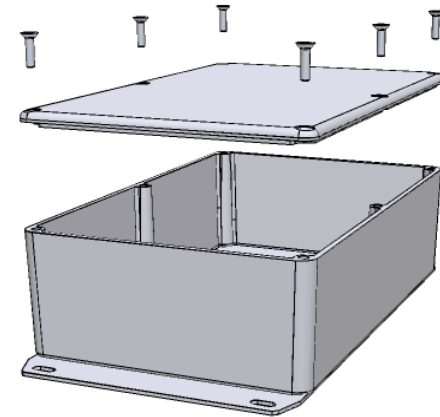
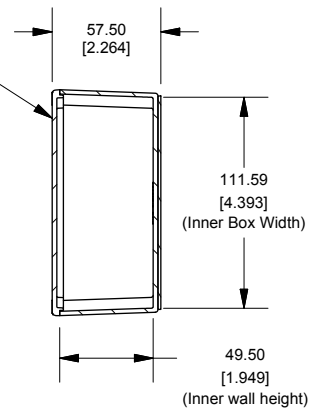
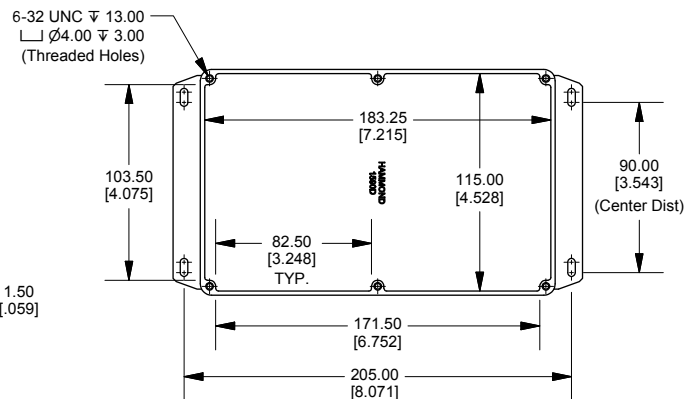
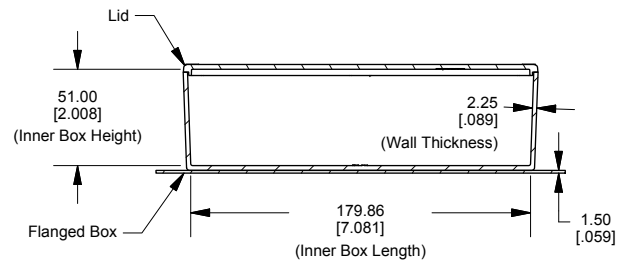

Top View of Assembly

SECTION A-A
End View of Assembly

Top View Looking Inside Box

SECTION B-B
Side View of Assembly

Lid

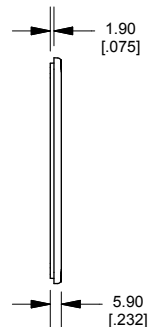
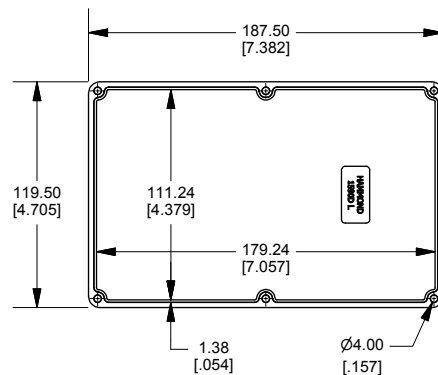

Enclosures can be Factory Modified (Milling, Drilling, Printing etc.)
Contact Factory mjm@hammondmg.com for quotes
Solid models of this enclosure available in STEP or IGES.

NOTE

Purchased assembly includes box, lid and 6 cover screws.
Box and lid are made from Diecast Aluminum Alloy.
Silicone Gasket supplied with liquid resistant enclosure.
Bottom Flange is Welded.

PART NUMBERS**1590DF Enclosure**

Natural Finish Enclosure	1590DF
Black Textured Enclosure	1590DFBK

1590DF Liquid Resistant Enclosure (Silicone Gasket)	
Natural Finish Enclosure	1590W DF
Black Textured Enclosure	1590WDFBK

ACCESSORIES

Recommended Torque: 75 ozf.in / 55 cN.m

Liquid Resistant Cover Screws

Stainless Steel Cover Screws (Pkg 100)	1590W MS 100
[6-32 x 1/2" With O-Ring]	
Black Stainless Steel Cover Screws (Pkg 100)	1590W MS 100BK
[6-32 x 1/2" With O-Ring]	

Standard Cover Screws

Plated Cover Screws (Pkg 100)	1590MS 100
[6-32 x 1/2"]	
Black Cover Screws (Pkg 100)	1590MS 100BK
[6-32 x 1/2"]	

Dimensions:
mm
[inches]

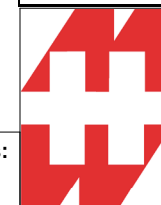

**HAMMOND
MANUFACTURING™**

1590DF

www.hammondmg.com

Mouser Electronics

Authorized Distributor

Click to View Pricing, Inventory, Delivery & Lifecycle Information:

Hammond:

[1590WDFBK](#) [1590WDF](#) [1590DFBK](#) [1590DF](#)