

Visit Sloan's Website at www.sloancorp.com

LED Lamps

— NEW —

T-1 PCB Horizontal Mount LED Bi-Level (Fig. 1)

Stock No.	Mfr.'s Type	Color	Lens Color	Wavelength (nm)	Iv (mcd) Typ.	Viewing Angle	EACH		
							1-99	100-499	500-999
265-8200	493018-G	Green	Diffused	575	10	60	.36	.33	.30
265-8202	493018-Y	Yellow	Diffused	591	25	60	.36	.33	.30
265-8204	493018-R	Red	Diffused	632	20	60	.36	.33	.30

T-1 3/4 PCB Horizontal Mount LED (Fig. 2)

265-8210	493017-G	Yellow Green	Diffused	575	120	30	.19	.17	.16
265-8212	493017-Y	Yellow	Diffused	591	380	30	.19	.17	.16
265-8214	493017-R	Red	Diffused	632	310	30	.19	.17	.16

T-1 3/4 Blinking LED (Frequency = 2.0 Hz) (Fig. 3)

265-8220	493019-G	Green	Diffused	575	100	—	.51	.46	.42
265-8222	493019-Y	Yellow	Diffused	591	300	—	.51	.46	.42
265-8224	493019-A	Amber	Diffused	611	250	—	.51	.46	.42
265-8226	493019-R	Red	Diffused	632	200	—	.51	.46	.42

T-1 (Bi-Color) Multi-Color LED (Fig. 4)

265-8240	493016-G/R	Super Yellow Green	White	575	32	30	.28	.26	.24
		Hyper Red	Diffused	632	50	30			
265-8242	493016-G/Y	Super Yellow Green	White	575	32	30	.28	.26	.24
		Super Yellow	Diffused	591	50	30			

T-1 3/4 (Bi-Color) Multi-Color LED (Fig. 5)

265-8230	SL925RGDE	Super Yellow Green	White	575	63	30	.26	.24	.22
		Hyper Red	Diffused	632	100	30			
265-8232	SL925GYDE	Super Yellow Green	White	575	63	30	.26	.24	.22
		Super Yellow	Diffused	591	100	30			

High Performance, High Voltage LEDs with Built In Resistor
T-1 5 Volt

265-8270	493022-5VG	Green	Water Clear	575	120	40	.31	.28	.26
265-8272	493022-5VR	Red	Water Clear	632	350	40	.33	.30	.27
265-8274	493022-5VY	Yellow	Water Clear	591	385	40	.33	.30	.27
265-8276	493022-5VA	Amber	Water Clear	621	420	40	.33	.30	.27

T-1 12 Volt

265-8280	493023-12VG	Green	Water Clear	575	120	40	.31	.28	.26
265-8282	493023-12VR	Red	Water Clear	632	350	40	.33	.30	.27
265-8284	493023-12VY	Yellow	Water Clear	591	385	40	.33	.30	.27
265-8286	493023-12VA	Amber	Water Clear	621	420	40	.32	.29	.27

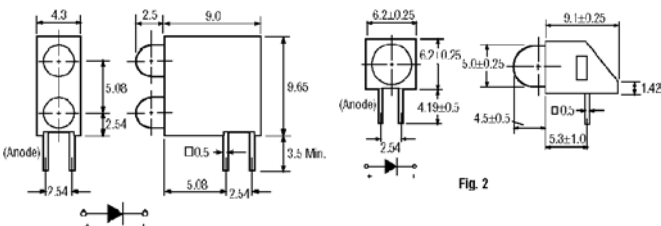

High Performance, High Voltage LEDs with Built In Resistor
T-1 3/4 5 Volt

Stock No.	Mfr.'s Type	Color	Lens Color	Wavelength (nm)	Iv (mcd) Typ.	Viewing Angle	EACH		
							1-99	100-499	500-999
265-8250	493020-5VG	Green	Water Clear	575	2200	10	.31	.28	.26
265-8252	493020-5VR	Red	Water Clear	632	7300	6	.33	.30	.27
265-8254	493020-5VY	Yellow	Water Clear	591	8900	6	.33	.30	.27
265-8256	493020-5VA	Amber	Water Clear	621	9900	6	.33	.30	.27

T-1 3/4 12 Volt

265-8260	493021-12VG	Green	Water Clear	575	2200	10	.31	.28	.26
265-8262	493021-12VR	Red	Water Clear	632	7300	6	.33	.30	.27
265-8264	493021-12VY	Yellow	Water Clear	591	8900	6	.33	.30	.27
265-8266	493021-12VA	Amber	Water Clear	621	9900	6	.33	.30	.27

High Performance LEDs

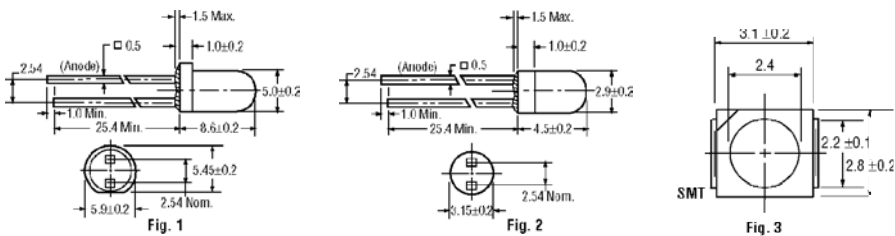

Super Bright 5 mm Round (Fig. 1)

Stock No.	Mfr.'s Type	Color	Lens Color	Wavelength (nm)	Iv (mcd) Typ.	Viewing Angle	EACH	
							1-99	100-499
265-9051	SL905WCE-13	Pure White	Water Clear	—	3700	13°	2.04	1.84
265-9052	SL905WCE-20	Pure White	Water Clear	—	3300	20°	2.04	1.84
265-9057	SL905GCE	Green	Water Clear	575	2200	20°	1.90	1.74
265-9058	SL905BCE	Blue	Water Clear	430	400	20°	1.90	1.74
265-9059	SL905RCE	Red	Water Clear	635	7300	13°	.22	.20
265-9060	SL905YCE	Yellow	Water Clear	590	8900	13°	.22	.18
265-9061	SL905ACE	Amber	Water Clear	620	9900	13°	.22	.18

Super Bright 3 mm Round (Fig. 2)

265-9054	SL903WCE	Pure White	Water Clear	—	630	40°	2.04	1.84
265-9062	SL903GCE	Green	Water Clear	575	120	40°	1.92	1.74
265-9063	SL903BCE	Blue	Water Clear	430	100	40°	1.92	1.74
265-9064	SL903RCE	Red	Water Clear	635	350	40°	.23	.20
265-9065	SL903YCE	Yellow	Water Clear	590	385	40°	.23	.20
265-9066	SL903ACE	Amber	Water Clear	620	420	40°	.23	.20

Super Bright 3.5 x 2.8 mm SMT (Fig. 3)

265-9067	SL902WCE	Pure White	Water Clear	—	150	120°	2.13	1.93
265-9068	SL902GCE	Green	Water Clear	575	53	120°	1.90	1.74
265-9069	SL902BCE	Blue	Water Clear	430	45	120°	1.90	1.74
265-9070	SL902RCE	Red	Water Clear	635	180	120°	.22	.20
265-9071	SL902YCE	Yellow	Water Clear	590	180	120°	.23	.20
265-9072	SL902ACE	Amber	Water Clear	620	190	120°	.23	.20

LED Tester



Handheld LED Tester

- Tests All 2 Lead LEDs
- 2-50 mA Test Range
- Ideal For Testing LED Color and Brightness
- Runs On 9 Volt Battery (Not Included)
- Dimensions: 2 1/4" x 3"

265-7009, 999-100, 1-4EACH 16.48

Check Pricing And Availability Of All Items On The Internet At www.alliedelec.com

ALLIED ► 567