

**CR-V3**

## ■ Dimensions(mm)

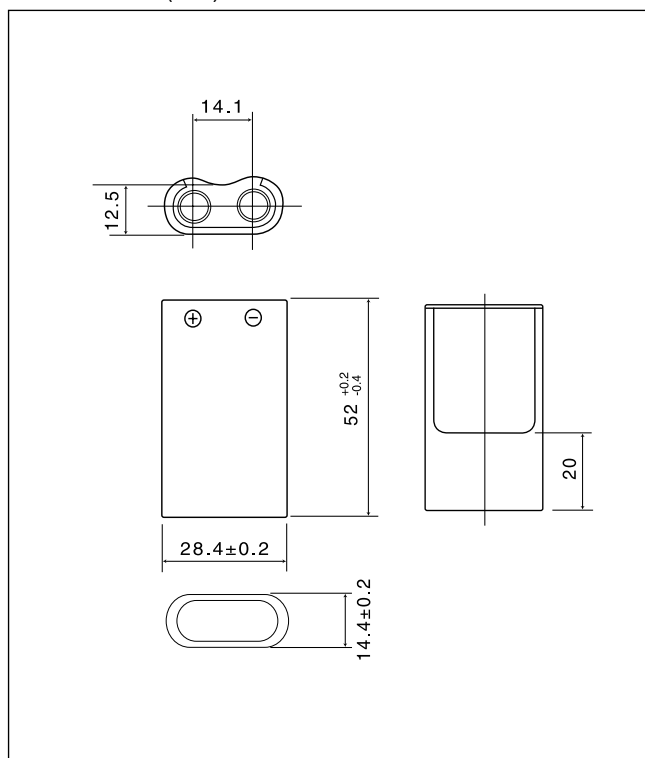

## ■ Specification

<b>Nominal voltage(V)</b>	3
<b>Nominal capacity(mAh)</b>	3,300
<b>Continuous drain(mA)</b>	200
<b>Operating temperature(°C)</b>	-40 to +70*

## ■ Discharge temperature characteristics

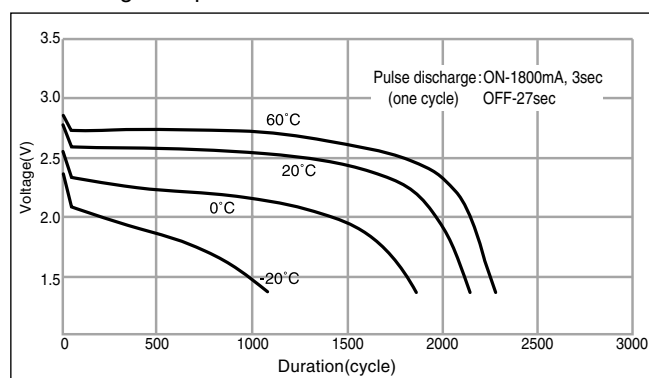

\* Please consult Panasonic for use below and above -20°C to +60°C.

# Mouser Electronics

Authorized Distributor

Click to View Pricing, Inventory, Delivery & Lifecycle Information:

Panasonic:

CR-V3