

Date	SYM	REVISION RECORD	AUTH	DR.	CK.
2/07/14	A	Updated Specification	T B	B S	

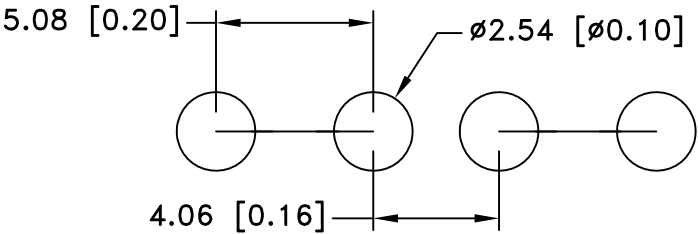
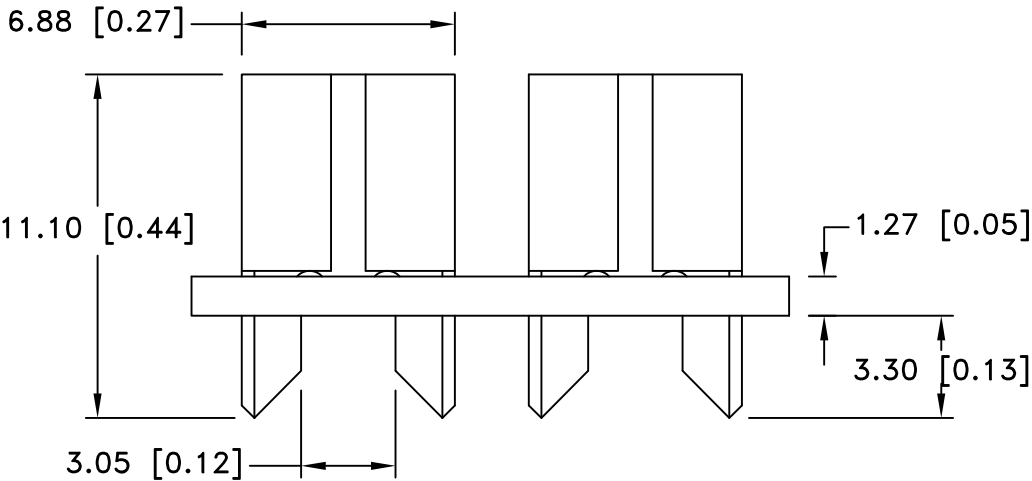
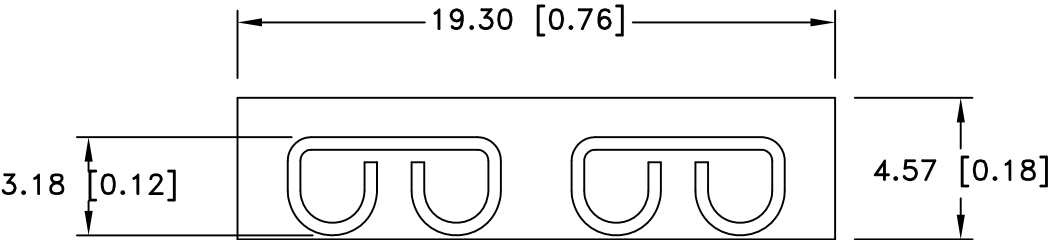

MOUNTING DETAIL

SPECIFICATION:
Current Rating: 30 Amps
Fuse Entry: Vertical
Fuse Type: Automotive
Material: Brass- Nickel Plate, Nylon 94V-0
Mounting: THM
Style: HOLDER
Fuse Reference: Littlefuse ATO 257, Bussmann ATC, APR
Fuse Size: Standard
ROHS 2 COMPLIANT

Tolerance (Except as noted)	<div><div><div></div><div>MPD</div></div><div>Memory Protection Devices, Inc 200 Broad Hollow Road, Farmingdale, New York 11735</div></div>		
decimal ±.5 (.020)		Scale	Drawn By B.S.
			Approved By T.B.
Fractional ± .8 (.030)	Title AUTO FUSE HOLDER FOR .205 x .025 STANDARD BLADE FUSES		
Angular ± 3°	Date 02/07/14	Drawing Number BK-6010	