

# Customer Information Sheet

DRAWING No.: M80-788XXX

SHEET 2 OF 2

IF IN DOUBT - ASK

(C)

NOT TO SCALE

THIRD ANGLE PROJECTION

ALL DIMENSIONS IN mm

**SPECIFICATION:****MATERIAL:**

MOULDING = GLASS-FILLED POLYAMIDE 46 UL94V-0, BLACK

CLIP = BERYLLIUM COPPER

SHELL = BRASS

**FINISH (ALL OVER NICKEL):****CONTACTS:**01 = 0.30 $\mu$  GOLD CLIP, 4.0 $\mu$  100% TIN SHELL05 = 0.30 $\mu$  GOLD CLIP, 0.28 $\mu$  GOLD SHELL**ELECTRICAL:**

CURRENT RATING AT 25°C = 3.0A MAX

CURRENT RATING AT 85°C = 2.2A MAX

WORKING VOLTAGE = 120V AC/DC

VOLTAGE PROOF = 360V AC/DC

**CONTACT RESISTANCE:**INITIAL = 20m $\Omega$  MAXAFTER CONDITIONING = 25m $\Omega$  MAX**INSULATION RESISTANCE:**INITIAL = 1000M $\Omega$  MINAFTER CONDITIONING = 100M $\Omega$  MIN**MECHANICAL:**

DURABILITY = 500 OPERATIONS

INSERTION FORCE = 2.8N MAX, 1.0N MIN

WITHDRAWAL FORCE = 1.8N MAX, 0.2N MIN

**ENVIRONMENTAL:**

TEMPERATURE RANGE = -55°C TO +125°C

**PACKING:**

BAG (CONTACTS AND MOULDINGS UN-ASSEMBLED)

FOR COMPLETE SPECIFICATION, SEE COMPONENT

SPECIFICATION C005XX (LATEST ISSUE)

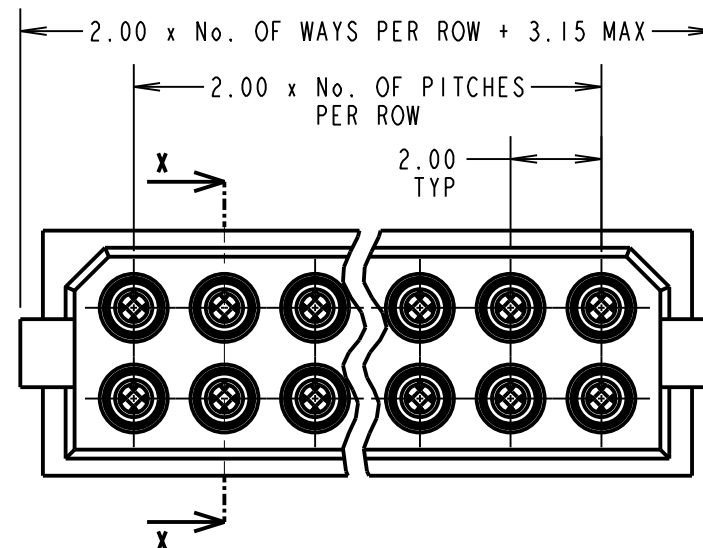
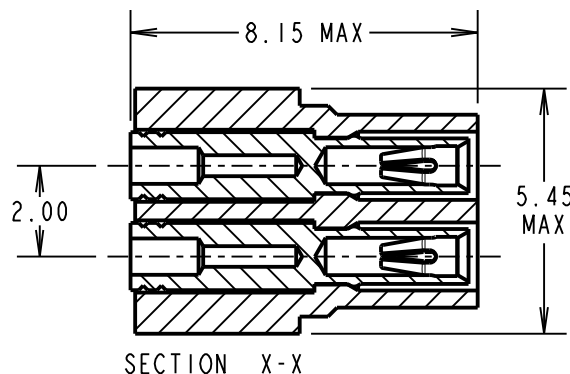
**NOTES:**

1. RECOMMENDED WIRE TYPE = PTFE INSULATED, 28 - 32 AWG BS3G210 TYPE A OR MIL-W-16878 TYPE ET WIRE.  
MAX INSULATION DIAMETER =  $\varnothing$ 0.75mm, STRIP WIRE BY 2.00mm.
2. RECOMMENDED HAND CRIMP TOOL = M22520/2-01 WITH POSITIONER T5747. REFER TO M22520/2-01 INSTRUCTION SHEET FOR COMPLETE CRIMPING INSTRUCTIONS.
3. CONTACT INSERTION AND EXTRACTION TOOL = Z80-280.
4. FOR EXTRA CONTACTS, USE ORDER CODE:  
M80-0190001 FOR M80-788XX01 & M80-0190005 FOR M80-788XX05

ORDER CODE:

**M80-788XXX**

TOTAL No. OF WAYS: \_\_\_\_\_

04 - 20, 26, 34

(EVEN No.S ONLY)

FINISH: \_\_\_\_\_

01 - GOLD CLIP, TIN SHELL

05 - GOLD CLIP, GOLD SHELL

SB	3	27.01.12	11637
NAME	ISS.	DATE	C/NOTE
APPROVED: S.BENNETT			
CHECKED: S.FLOWER			
DRAWN: S. MCCULLAGH			
CUSTOMER REF.:			
ASSEMBLY DRG:			

**HARWIN**www.harwin.com  
technical@harwin.com

THIS DRAWING AND ANY  
INFORMATION OR DESCRIPTIVE  
MATTER SET OUT HEREON ARE  
CONFIDENTIAL AND COPYRIGHT  
PROPERTY OF THE HARWIN  
GROUP AND MUST NOT BE  
DISCLOSED, LOANED, COPIED  
OR USED FOR MANUFACTURING,  
TENDERING OR FOR ANY  
OTHER PURPOSE WITHOUT  
THEIR WRITTEN PERMISSION.

**TOLERANCES**X. =  $\pm$ 1mm  
X.X =  $\pm$ 0.25mm  
X.XX =  $\pm$ 0.10mm  
X.XXX =  $\pm$ 0.01mmANGLES =  $\pm$ 5°

UNLESS STATED

**MATERIAL:**

SEE ABOVE

FINISH: SEE ABOVE

S/AREA: mm<sup>2</sup>**TITLE:**DATAMATE L-TEK  
DIL SOCKET CRIMP ASSY  
EXTRA SMALL BORE (28 - 32AWG)

DRAWING NUMBER:

**M80-788XXX**SHT  
2  
OF  
2