

THE INFORMATION CONTAINED IN THIS DRAWING IS CONFIDENTIAL AND MAY NOT BE DISCLOSED WITHOUT WRITTEN CONSENT FROM SOURIAU USA, INC.

**A**

DWG. NO.  
**JBXEA2G05FCSDSC**

ELECTRICAL:

EMI SHIELDING :	SHIELDED FOR THE RANGE 55dB UP TO 100MHz
INSULATION RESISTANCE :	>500M $\Omega$ PER ANSI-EIA-364-D METHOD 21
MAX. CURRENT RATING :	(SEE TABLE 1) MAXIMUM CURRENT THAT CAN BE APPLIED SIMULTANEOUSLY ON EACH LINE OF THE CONNECTOR MATED PAIR, CONTINUOUSLY DURING ITS LIFE TIME IN NORMAL CLIMATIC CONDITIONS.
CONNECTOR TESTING : VOLTAGE	1900 Vrms TEST VOLTAGE IS APPROXIMATELY 75% OF THE DWV VOLTAGE AT NORMAL CLIMATIC CONDITIONS. THIS VOLTAGE CAN BE ACHIEVED SEVERAL TIMES, BUT NOT APPLIED CONTINUOUSLY.
CONNECTOR WORKING : VOLTAGE	900/630 (Vdc/ Vrms) WORKING VOLTAGE IS APPROXIMATELY 1/3 OF THE TEST VOLTAGE. THIS VOLTAGE IS SUSTAINABLE FOR THE LIFE OF THE CONNECTOR IN ITS WORKING ENVIRONMENT.

PHYSICAL:  
MAXIMUM WIRE SIZE USED FOR CRIMPING : 18 AWG

ENVIRONMENTAL:

ENDURANCE:	1000 CYCLES AS PER MIL-STD 1344A, METHOD 2016.1
SHOCK:	100 g , DURATION 6 ms: AS PER MIL-STD 1344A, METHOD 2004.1
VIBRATIONS:	10 TO 2000Hz $\gamma$ = 20 g, AS PER MIL-STD 1344A, METHOD 2005.1
PROTECTION INDEX:	IP 40 AS PER CEI 529
OPERATING TEMPERATURE:	-55°C TO +200°C (-67°F TO +392°F)

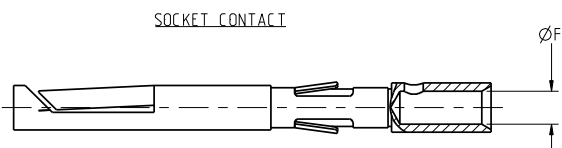

TABLE 1

TABLE 1						
CONTACT		USABLE CABLES			MAX. CURRENT RATING (A)	CONTACT RESISTANCE (mΩ)
ØC	ØF	CORE SECTION (mm <sup>2</sup> )		AWG		
		MIN.	MAX.			
-	1.4	0.326	0.823	18-20-22	15	3

DRAWING TITLE	
JBX, SIZE 2, 5 POSITION, EA RECEPTACLE	

CAT NO. **JBXEA2G05FCSDS**

CAGE NO: 09922	SIZE: C
----------------	---------

## CUSTOMER



**SOURIAU**  
Connection Technology

APPROVAL	DRAWN: RKO	12-30-16
	CHKD : TW	12-30-16
	DSGN : XXX	mm-dd-yy
	MFG : DH	12-30-16
	QC : DK	12-30-16

DRAWING SCALE: 5:1	
DRAWING NO.	REV

JBXEA2G05FCSDSC A

2 OF 2