

THA-188 Grip



Characteristic

Available as a screw type and nut type.

Application

Door for small boxes /
Door for small devices

Specification

There might be coppered parts on the screw which is the marks of metal plating.

Specification

Model No.	A	A1	A2	B	C	D	E	Net Weight(g)	Code No.
THA-188-1	M4	φ16	φ15	20	10	30		15.5	3927
THA-188-2	M3	φ11	φ10	20	8	28		6.0	3928
THA-188-3	M4	φ16	φ15		10		6	12.5	3931
THA-188-4	M3	φ11	φ10		8		4	4.0	3932

Parts List

No.	Part Name	Material	Finish	Quantity
1	Grip	C3604	Cr	1
2	Nut		Ni	1

THA-188-1
THA-188-2

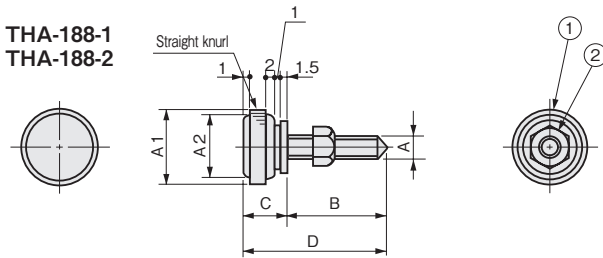

THA-188-3
THA-188-4

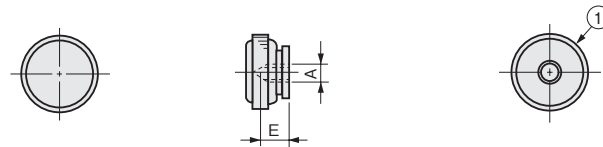

THA-184 Key Handle Latch



Characteristic

Heat, salt, chemical, and acid resistance latch.
A handle with detent mechanism, less extrusion from the fixing surface.

Application

Small distribution boards /
Small distribution panels /
Control boards

Specification

Model No.	Net Weight(g)	Code No.
THA-184	60.1	3920

Parts List

No.	Part Name	Material	Finish	Quantity
1	Rotational Axis	SUS304		1
2	Set Seat			1
3	Set Nut			1
4	Washer			1
5	Spring Washer	SUS	Barrel Polishing	1
6	Hexagon Bolt	SUS304		1
7	Key Handle			1

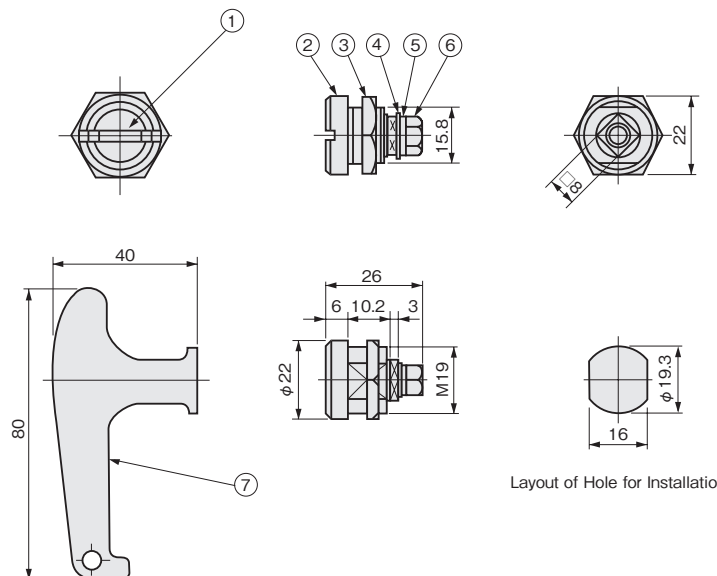

Layout of Hole for Installation