

HEYCO

Heyco® Turn-2-Lock Cordset Components

30 Amp

For Finished, Custom Turn-2-Lock Cord and Plug Sets, see pages 8-7 thru 8-16

PART DATA			PART NO.	APPLICATION TOOLING*				
Type	AWG Range	Material		Die**	Feeds	Tool Packs	Crimp Punch	Anvil
TL-L5-30-W	10-8	Brass	6120	6120UXX5	Bulk	B958/B959	C663	C667
TL-L5-30-B	10-8	Brass	6122	6122UXX5				
TL-L5-30-G	10-8	Brass	6124	6124UXX5				

* Use the Heyco Universal Applicator Die (indicated by "U" in the Die Part No.), page 8-63.

** "XX" represents Wire Gauge. Please specify Wire Gauge when ordering.

- .068" gauge material, cut-out shapes and radius are all UL Specified.

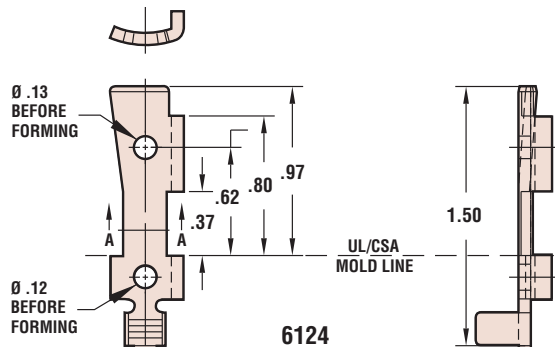
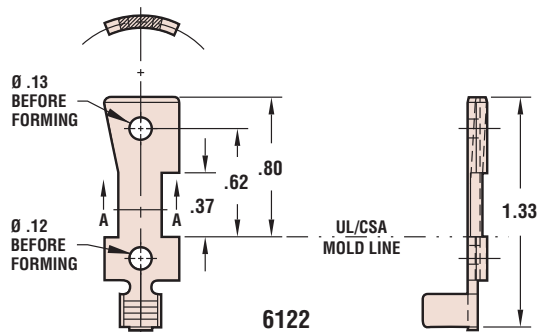
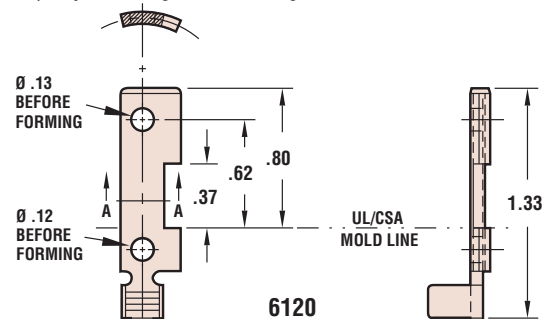

Heyco® Male Turn-2-Lock Nylon Premolds

- Nylon male premold for use with Heyco blades and pins (consult Heyco for details on our complete line of blades and pins).
- **Reduce PVC usage and increase molding efficiency.**
- Terminals in picture not included.

PART NO.	15 and 30 Amp	PART NO.	20 Amp
S7424	125V 15A Male TL Premold Black	S7426	125V 20A Male TL Premold Black
S7428	250V 15A Male TL Premold Black	S7422	277V 20A Male TL Premold Black
S7420	277V 15A Male TL Premold Black	S7432	347V 20A Male TL Premold Black
S7436	250V 30A Male TL Premold Black	S7434	480V 20A Male TL Premold Black

Materials	Alloy 260 Brass (70% Cu, 30% Zn. Higher Cu content resists dezincification) 6/6 Nylon
Certifications	UL Listed under UL File E217650 for use with Cordsets under UL 817 applications (Cordset Components only)

Quick Specs

Mouser Electronics

Authorized Distributor

Click to View Pricing, Inventory, Delivery & Lifecycle Information:

[Heyco:](#)

[S7200](#)