

3RU1116-1CB0 OVERLOAD RELAY, 1.8...2.5 A,

Technical / CAx data

☒ Technical Data ☐ CAx data

As of 2011-11-26

OVERLOAD RELAY, 1.8...2.5 A, 1NO+1NC, SIZE S00,
CLASS 10, FOR CONTACTOR MOUNTING



General technical details:

product brand name		SIRIUS
product designation		thermal overload relay
Protection class IP / on the front		IP20
Insulation voltage / with degree of pollution 3 / rated value	V	690
Installation altitude / at a height over sea level / maximum	m	2,000
Ambient temperature		
• during operating phase	°C	-20...70
• during storage	°C	-55...80
• during transport	°C	-55...80
Relative humidity / during operating phase / maximum	%	100
Resistance against shock		8g / 10 ms
Impulse voltage resistance / rated value	kV	6
Active power loss / total / typical	W	6.6
Item designation		
• according to DIN 40719 extendable after IEC 204-2 / according to IEC 750		F
• according to DIN EN 61346-2		F
Operating current / of the fuse link / rated value	A	10
Trip class		CLASS 10
Type of assignment		2
type of protection		DMT 98 ATEX G 001
Size of overload relay		S00
Size of the contactor / can be combined / company-specific		S00

Protection against electrical shock		finger-safe	
Main circuit:			
Number of poles / for main current circuit	3		
Operating voltage / at AC-3 / rated value <ul style="list-style-type: none">maximum	V	690	
Service power / at AC-3 <ul style="list-style-type: none">at 400 V	kW	0.75	
Adjustable response current <ul style="list-style-type: none">of the current-dependent overload release	A	1.8...2.5	
Auxiliary circuit:			
Contact reliability / of the auxiliary contacts	acceptability for PLC control (17 V, 5 mA)		
Number of NC contacts	1		
Number of NO contacts	1		
Number of change-over switches	0		
Operating current / of the auxiliary contacts / at AC-15 <ul style="list-style-type: none">at 24 Vat 110 Vat 120 Vat 125 Vat 230 Vat 400 V	A	3	
	A	3	
	A	3	
	A	3	
	A	2	
	A	1	
Operating current / of the auxiliary contacts / at DC-13 <ul style="list-style-type: none">at 24 Vat 110 Vat 125 Vat 220 V	A	1	
	A	0.22	
	A	0.22	
	A	0.11	
Short-circuit:			
Design of the fuse link / for short-circuit protection of the auxiliary switch / required	fuse gL/gG: 6 A, quick: 10 A		
Installation/mounting/dimensions:			
Built in orientation	with vertical mounting surface +/-135°rotatable, with vertical mounting surface +/- 45°tiltable to the front and back		
Type of mounting	direct mounting		
Height	mm	87	
Width	mm	45	
Depth	mm	78	
Distance, to be maintained, to the ranks assembly <ul style="list-style-type: none">upwardsdownwardsforwardsbackwardssideways	mm	0	
	mm	0	
	mm	0	
	mm	0	
	mm	0	
Distance, to be maintained, to earthed part <ul style="list-style-type: none">upwardsdownwardsforwardsbackwardssideways	mm	0	
	mm	0	
	mm	0	
	mm	0	
	mm	6	
Distance, to be maintained, conductive elements <ul style="list-style-type: none">upwardsdownwardsforwardsbackwards	mm	0	
	mm	0	
	mm	0	
	mm	0	

- sideways

mm 6

Connection type:

Product function

- removable terminal for auxiliary and control circuit

No

Design of the electrical connection

- for main current circuit
- for auxiliary and control current circuit

screw-type terminals

screw-type terminals

Type of the connectable conductor cross-section

- for main contacts
 - solid
 - stranded
 - finely stranded
 - with conductor end processing
- for auxiliary contacts
 - solid
 - finely stranded
 - with conductor end processing
 - without conductor final cutting
- for AWG conductors
 - for main contacts
 - for auxiliary contacts

2 x (0.5 ... 1.5 mm²), 2 x (0.75 ... 2.5 mm²), max. 2 x (1 ... 4 mm²)

2 x (0.5 ... 1.5 mm²), 2 x (0.75 ... 2.5 mm²), max. 2 x (1 ... 4 mm²)

2x (0.5 ... 1.5 mm²), 2x (0.75 ... 2.5 mm²)

2x (0.5 ... 1.5 mm²), 2x (0.75 ... 2.5 mm²)

2x (0.5 ... 1.5 mm²), 2x (0.75 ... 2.5 mm²)

2x (0.5 ... 1.5 mm²), 2x (0.75 ... 2.5 mm²)

2x (18 ... 14)

2x (18 ... 14)

Conductor cross section that can be connected

- for main contacts
 - solid
 - stranded
 - stranded wire
 - with conductor end processing
- for auxiliary contact
 - solid
 - stranded wire
 - with conductor end processing
 - without conductor final cutting

mm² 0.5...4

mm² 0.5...4

mm² 0.5...2.5

mm² 0.5...2.5

mm² 0.5...2.5

mm² 0.5...2.5

AWG number / as coded connectable conductor cross-section

- for main contacts / minimum
- for auxiliary contact

18

18...14

Certificates/approvals:

Verification of suitability

CSA / UL / CC / GL / LRS / BV / DNV / RMRS / RINA / PRS / ABS

Verification of suitability / ATEX

Yes

General Product Approval

CQC

☒ CSA

ROSTEST

☒

Shipping Approval

ABS

☒ BV (Bureau Veritas)

☒ DNV (Det Norske Veritas)

☒

Shipping Approval

other

☒ RINA (Registro Italiano Navale)

☒ RMRS (Russian Maritime Register)

Manufacturer

Further information:

Information- and Downloadcenter (Catalogs, Brochures,...)

<http://www.siemens.com/industrial-controls/catalogs>

Industry Mall (Online ordering system)

<http://www.siemens.com/industrial-controls/mall>

CAX-Online-Generator

<http://www.siemens.com/cax>

Service&Support (Manuals, Certificates, Characteristics, FAQs,...)

<http://support.automation.siemens.com/WW/view/en/3RU1116-1CB0/all>

Image database (product images, 2D dimension drawings, 3D models, device circuit diagrams, ...)

http://www.automation.siemens.com/bilddb/cax_en.aspx?mlfb=3RU1116-1CB0

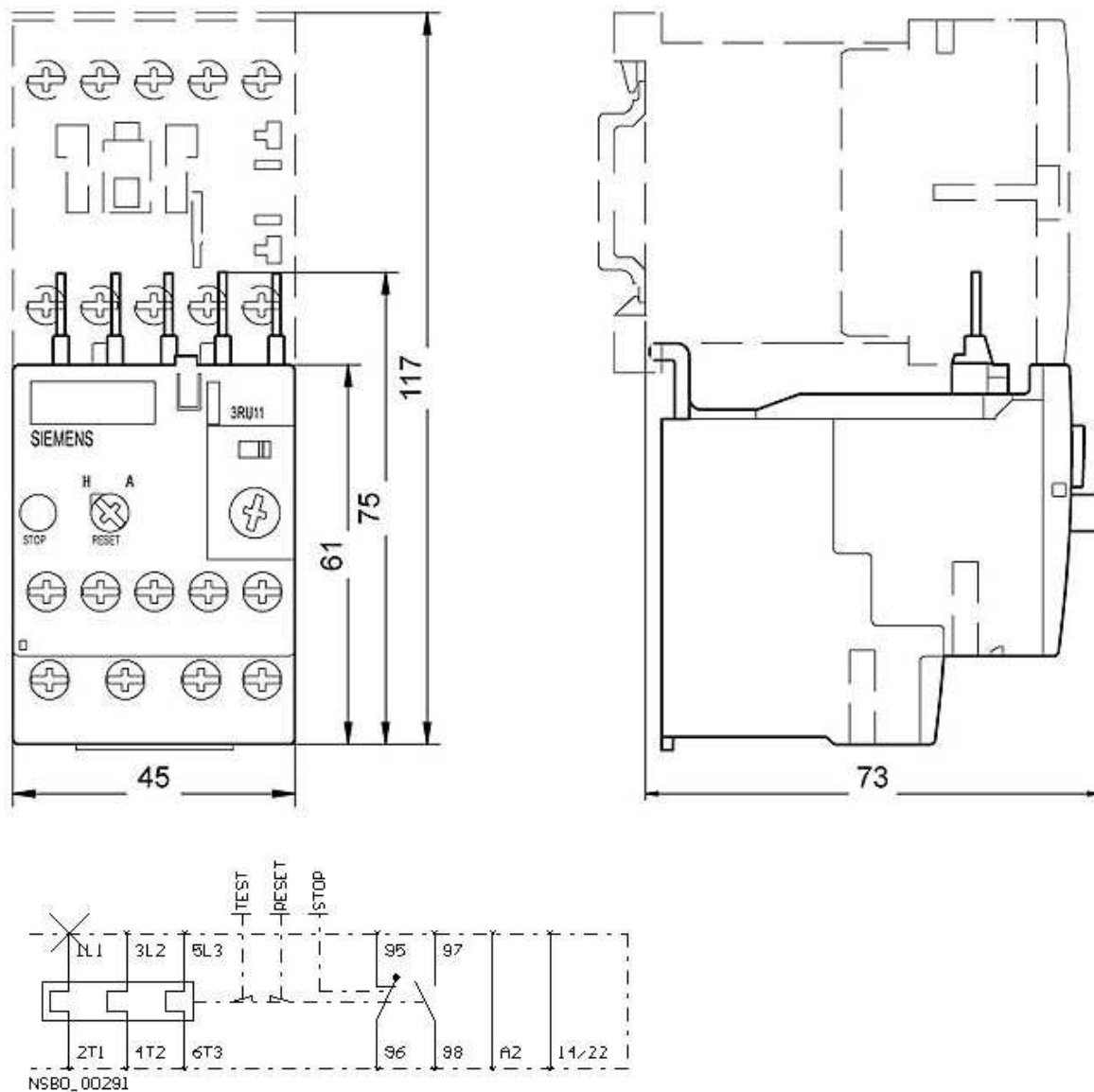

last change:

Jun 20, 2011