

PRODUCT NUMBER
91614-YXXZLF

RoHS COMPATIBLE PRODUCT, NOTE 7.

A: TAPE & REEL PACKAGING, PRODUCT AND CAP GREY, TA-856.

G: TAPE & REEL PACKAGING, PRODUCT AND CAP BLACK, TA-856.

AV: TAPE & REEL PACKAGING FOR CUSTOMER DEDICATED PART,
PRODUCT AND GREY CAP TA-856.

KV: TAPE & REEL PACKAGING WITHOUT PICK-UP CAP
FOR CUSTOMER DEDICATED PART GREY TA-856.

TV: TUBE WHITHOUT CAP FOR CUSTOMER DEDICATED PART, GREY COLOR.
: OMIT LETTER MEANS STD PACKAGING TUBE, NOTE 3.

NUMBER OF POSITIONS: 03 UP TO 25, OVER 25 POS ON REQUEST

PLATING CODE

3= 0.76µm GOLD ON CONTACT AREA.
2µm MIN MATTE TIN ON TAIL.

4= 2µm MIN MATTE TIN FULL PLATED

1.27µm Ni MIN UNDERPLATING

NOTES:

- HOUSING & PICK UP CAP MATERIAL: HIGH TEMPERATURE THERMOPLASTIC GLASS FILLED FLAME RETARDANT PER UL 94 COLOR: GREY or BLACK
- TERMINAL MATERIAL: PHOSPHOR BRONZE.
- 91614-YXXLF & 91614-YXXGLF ARE PACKED IN TUBE.
- TO DETERMINE DIMENSIONS:
N = NUMBER OF POSITIONS
EXAMPLE: 8 POS: $((N+2) \times 2.54) - 0.08 = 25.32$ mm.
- RECOMMENDED IR PROFILE PER TA842.
- Ø2.65 MINI FOR PICK & PLACE ASSEMBLY(=0 INSERTION FORCE).
- RoHS COMPATIBLE PRODUCT SPECIFICATIONS
 - PLATING:
 - "LF" MEANS THE PRODUCT IS LEAD-FREE,
2µm MINIMUM MATTE TIN OVER 1.27µm
MINIMUM NICKEL UNDERPLATE.
 - MANUFACTURING PROCESS COMPATIBILITY
 - THE HOUSING WILL WITHSTAND EXPOSURE TO
260°C PEAK TEMPERATURE FOR 30 SECONDS
MAX IN A CONVECTION, INFRA-RED OR VAPOR
PHASE OR REFLOW OVEN.
 - LABELING:
 - MEETS PACKAGING SPECS AS PER GS-14-920
 - LEGAL STATEMENT: SEE GS-47-0004

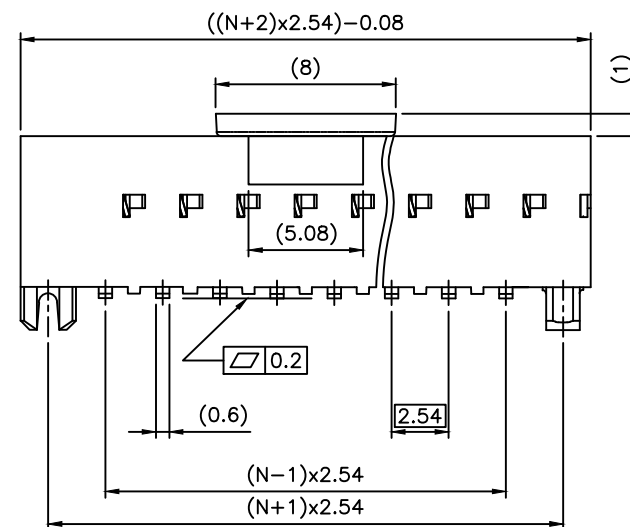
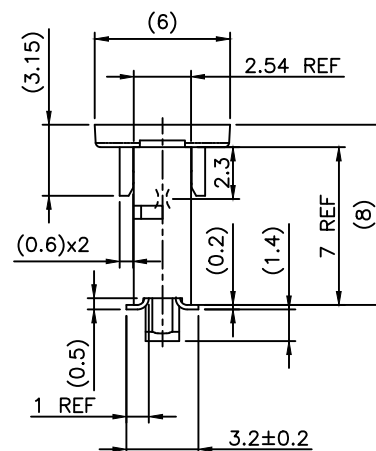
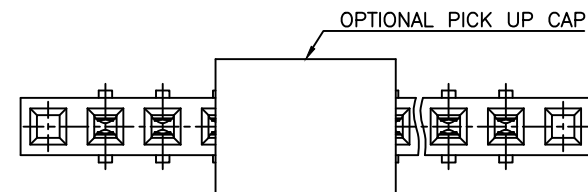

mat'l. code SEE NOTES				surface ISO 1302	tolerance ISO 406 ISO 1101	projection mm	product family DUBOX			
ltr	ecr	no	dr	date	tolerances unless otherwise specified		title			
X	F07	0245	PNZ	07.08.14	angles	.x ±0.3	BtB RECEPT. VERT SR SMT			
Y	F08	0102	PNZ	08.01.18	linear	.xx ±0.15				
AA	F11	0338	JCO	11.11.05	±2°	.xxx ±0.05				
AB	B	15631	JCO	13.07.26	dr	D LEGRAND	02.01.31	dwg no		sheet 1 of 2
AC	B	16805	JCO	14.01.21	enrg	P NIZZI	02.01.31	91614		A3
AD	B	19123	LMU	14.10.21	chr	DLE	02.01.31	type		CUSTOMER Drawing
AE	B	19716	BVE	14.12.11	appd	PNZ	02.01.31			
sheet	revision	AE	B							
index	sheet	1	2							



FCIconnect.com

Copyright FCI

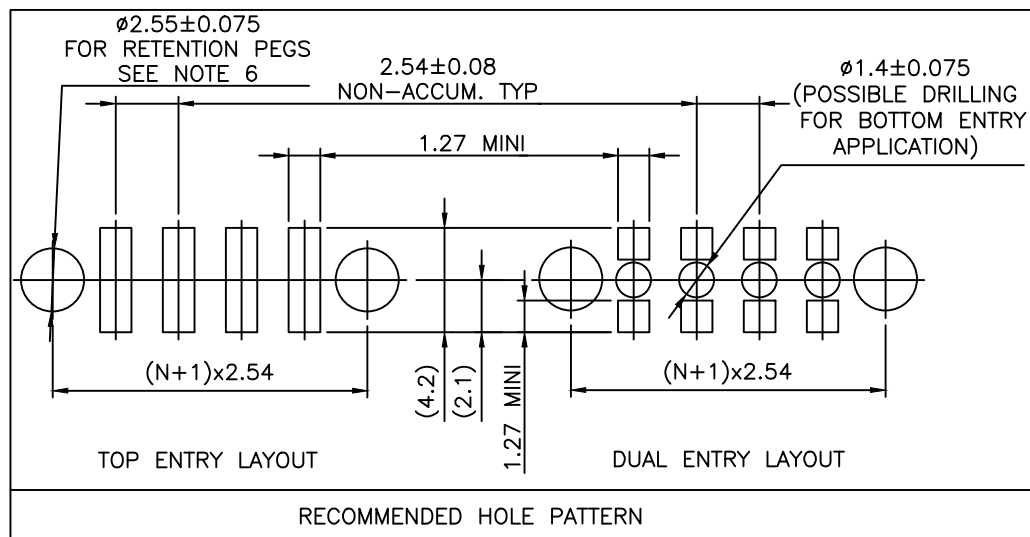

mat'l. code SEE NOTES				surface ISO 1302	tolerance ISO 406 ISO 1101	projection	product family DUBOX
ltr	ecn no	dr	date	tolerances unless otherwise specified			title
A	F04-0347	DLE	04.11.10	angles	linear	± 0.3	BtB RECEPT.
B	F06-0204	DLE	06.06.23	$\pm 2^\circ$		mm	VERT SR SMT
				dr	D LEGRAND	04.11.10	dwg no
				enr	P NIZZI	04.11.10	sheet 2 of -
				chr	D LEGRAND	04.11.10	size
				appd	P NZ	04.11.10	A3
sheet index	revision sheet						type
							CUSTOMER Drawing

Mouser Electronics

Authorized Distributor

Click to View Pricing, Inventory, Delivery & Lifecycle Information:

FCI:

91614-307LF