

Visit Chicago Miniature's Website at [www.sli-lighting.com](http://www.sli-lighting.com)

### Series 5300E, 5300H, 5302H, and 5308H

- Easy to Mount
- High Contrast Ratio
- Includes Board Standoff to Prevent Flux Entrapment — Permits Easy Washing
- TTL Compatible — Requires No External Current Limiting Resistors (Series 5302H-5 V Only)
- Housing: Black Nylon UL94V-0

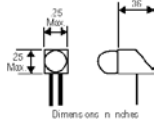

Stock No.	Mfr.'s Type	LED Color	Forward Volt @ mA	Brt. Med.	EACH
					1-99
679-7161	5300H1	Red	2.0 @ 20	30.0	.30
679-7162	5300H5	Green	2.2 @ 20	30.0	.30
679-7163	5300H7	Yellow	2.1 @ 20	25.0	.33
679-7240	5302H1-5V	Red	5.0 @ 10	5.0	.66
679-7241	5302H3-5V	Amber	5.0 @ 10	7.0	.66
679-7242	5302H5-5V	Green	5.0 @ 20	10.0	.66
679-7289	5308H1	Red	2.2 @ 20	120.0	.59
679-7291	5308H5	Green	2.2 @ 20	120.0	.59
679-7292	5308H7	Yellow	2.1 @ 20	120.0	.59
679-7239	5300H1/5	Red/Green	2.2 @ 10	6.0	.84
679-7210	5300H5/1	Green/Red	2.2 @ 10	6.0	.84
679-9970	5302H1-12V	Red	12.0 @ 12	4.0	.66
679-9972	5302H3-12V	Amber	12.0 @ 12	4.0	.66
679-9974	5302H5-12V	Green	12.0 @ 12	4.0	.66

### Series 5350T LEDs

- Small Size Enables These to be Stacked on 0.100" Center
- High-Intensity Light Output
- Ideal for Use Where LEDs Must Align with Opening in a Cover Panel
- Housing: Black Nylon UL94V-0
- Sub-Miniature 2.0 mm LED Right Angle Mounted Simplify PC Board Mounting — Saves Assembly Time and Costs
- Low Current — Only 2 mA
- Built-in Resistor Chip; Operates at 5 Volts Without External Resistor

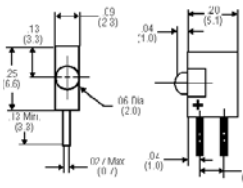

Stock No.	Mfr.'s Type	Lens Color	Forward Volt @ mA	EACH	
				1-99	100-499
679-8351	5352T1-5V	Red	5.0 @ 9.6	.82	.73
679-8352	5352T3-5V	Amber	5.0 @ 10	.82	.73
679-8353	5352T5-5V	Green	5.0 @ 10	.82	.73
679-8358	5350T1LC*	Red	1.8 @ 2	.86	.78
679-8359	5350T5LC*	Green	1.8 @ 2	.82	.73
679-8360	5350T7LC*	Yellow	1.9 @ 2	.86	.78
679-8354	5352T1-5VLC*	Red	5.0 @ 3.5	.86	.78
679-8355	5352T3-5VLC*	Amber	5.0 @ 3.5	.86	.78
679-8356	5352T5-5VLC*	Green	5.0 @ 3.5	.86	.78

\*LC = Low current, high efficiency.

### Circuit Board Indicators Series 5380E, 5380H

- Easy Mounting
- Includes Board Standoff to Prevent Flux Entrapment, Permits Easy Washing
- Needs Minimum Space
- Housing: Black Nylon UL94V-0

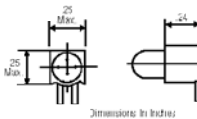

Stock No.	Mfr.'s Type	LED Color	Forward Volt @ mA	Brt. Med.	EACH
					1-99
679-7256	5380E1	Red	1.7 @ 20	3.0	.48
679-7260	5380H5*	Green	2.2 @ 20	30.0	.48
679-7261	5380H7	Yellow	2.1 @ 20	25.0	.48
679-9733	5380H1-5V†	Red	5.0 @ 10	5.5	.66
679-9734	5380H3-5V†	Amber	5.0 @ 10	7.0	.79
679-9735	5380H5-5V†	Green	5.0 @ 12	10.0	.66

\*Super Brite 30 mcd. †Built-in Resistor.

### Miniature Circuit Board Indicator LED T-1 Block Assembly Series 5600F, 5602F

- Easy to Mount
- Includes Board Standoff to Prevent Flux Entrapment, Permits Easy Washing
- T-1 Size High Intensity LED
- Housing: Black Nylon UL94V-0

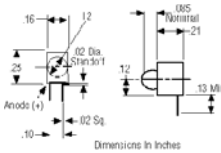

Stock No.	Mfr.'s Type	LED Color	Forward Volt @ mA	Brt. Med.	EACH
					1-99
679-7262	5600F1	Red	2.0 @ 10	6.0	.48
679-7263	5600F5	Green	2.2 @ 20	12.0	.48
679-7264	5600F7	Yellow	2.1 @ 20	20.0	.48
679-9761	5600F3	Amber	2.0 @ 10	5.0	.48
679-9765	5602F1-5V*	Red	5.0 @ 10	8.0	.66
679-9766	5602F3-5V*	Amber	5.0 @ 10	8.0	.66
679-9767	5602F5-5V*	Green	5.0 @ 12	8.0	.66

\*Resistor built-in 5 volts.

### Series 5640H Circuit Board Indicators

- Quad Assembly With Four T-1 1/4 LEDs Allowing For Easy Installation — Assures Matched Height and Center to Center Spacing — Reduces Assembly Time and Costs
- Low Current — Only 2 mA Available
- Super Brite LEDs Feature High Light Output and Diffused Lenses
- Standoffs Prevent Flux Entrapment
- Housing UL94V-0 Black Nylon

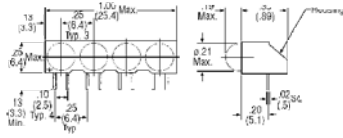

Stock No.	Mfr.'s Type	Output Color	Lum. Intensity		EACH	
			Min.	Typ.	1-99	100-499
679-1172	5640H1	Red	3.0	30.0	1.97	1.77
679-1173	5640H3	Amber	4.0	20.0	1.97	1.77
679-1174	5640H5	Green	3.0	30.0	1.97	1.77

### Circuit Board Indicator Super Brite LED Assemblies Series 5670H, 5680F

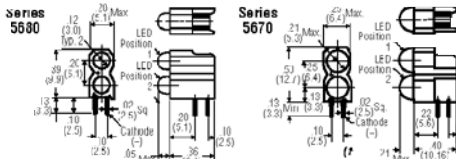

- Dual Mounted
- Allow Two LEDs in the Same Board Area Required for a Single LED
- High Contrast Ratio, High Intensity Light Output
- Includes Board Standoff to Prevent Flux Entrapment — Permits Easy Washing

Stock No.	Mfr.'s Type	LED Color	Forward Volt @ mA	Brt. Med.	EACH
					1-99
679-8670	5670H1:1*	Red/Red	2.0 @ 20	30	1.09
679-8671	5670H5:5*	Green/Green	2.0 @ 20	20	1.09
679-8672	5670H7:7	Yellow/Yellow	2.1 @ 20	25	1.09
679-9750	5670H3:3	Amber/Amber	2.0 @ 20	20	1.09
679-8680	5680F1:1	Red/Red	2.0 @ 10	6	1.09
679-8681	5680F5:5	Green/Green	2.2 @ 20	12	1.09
679-8682	5680F7:7	Yellow/Yellow	2.1 @ 20	20	1.09
679-9760	5680F3:3	Amber/Amber	2.0 @ 10	5	1.09

\*Super Brite 30 mcd. **Note:** Allied and Chicago Miniature can also supply the user who may have a special requirement, calling for various color/elec. specs.

### PC Board, 3-Up and 4-Up T-1 LED Lamps

High Density — Right Angle Mounting

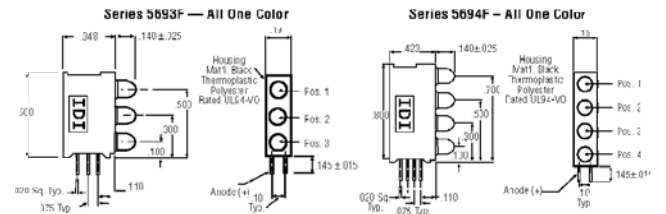
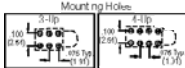

- 3 and 4 T-1 LEDs Stack Mounted in Single Block Saves Space and Assembly Time
- Black Plastic Mounting Block for High Contrast Ratio
- Colors Can be Mixed and Matched as MFG Specials
- High Brite and Super Brite Light Output
- Meets UL94V-0 and Bellicore Flammability Specifications
- Standoffs Prevent Flux Entrapment

Stock No.	Mfr.'s Type	LED Color Code No.	Color	Typical Intensity	Rated Current	Forward Voltage Typ.	EACH	
							1-99	100-499
679-9816	5693F1:1;1A	1	Red	10.0 mcd	10 mA	2.2 V	2.02	1.82
679-9820	5694F1:1;1;1A	1	Red	10.0 mcd	10 mA	2.2 V	2.81	2.53
679-9821	5694F3:3;3;3A	3	Red	6.5 mcd	10 mA	2.2 V	2.81	2.53
679-9822	5694F5:5;5;5A	5	Green	8.5 mcd	10 mA	2.3 V	2.67	2.41

### Also Available: Multi-Colored 3- and 4-Up LEDs

Call Allied at 1-800-433-5700 for Pricing: Quantity Pricing Available

**Color Code:** 1 = Red, 3 = Amber, 5 = Green, 7 = Yellow. **Ordering Information:** Insert number of color desired for each position to determine Mfr.'s Type.

**3-Up LEDs**

Example: 5693F

Pos. #1 Pos. #2 Pos. #3 -A

**4-Up LEDs**

Example: 5694F

Pos. #1 Pos. #2 Pos. #3 Pos. #4 -A

