



Quick Reference Guide AW Series Switches

The AW Series toggle switch features many circuit configurations, including SPST, SPDT, DPST, DPDT and 4PDT, with a choice of momentary or maintained circuits. The switch provides superior switching power through brass silver alloy contacts. This toggle is UL, CSA recognized for 20A at 30VDC and 20A at 250VAC. Electrical life is 20,000 cycles at full load. Other electrical parameters include contact resistance of 10 milliohms max., insulation resistance of 1,000 megohms and actuation force of 29.4 N max.

The AW Series switches have .250 quick connect terminals and all are panel mountable with 12 mm threaded bushing which is brass with chrome plating. The series mounting design conforms to standard panel cut outs, easing the task of installation.

Features

- IP67 panel mounting seal
- Sleeve and Frame perfect sealed
- Fixed contact molded-inserting construction
- Wide range switch functions available
- Meets requirements of industrial and outdoor environments

Applications

These devices are ideal for any design requiring human interface via toggle-style switch in harsh environments, including:

- Industrial equipment
- Heavy machinery
- Construction equipment
- Transportation vehicles
- Outdoor concert and lighting equipment
- Portable power tools

Typical Performance Characteristics

Number of Poles : 1, 2 and 4 pole
Switch Functions : ON-OFF, ON-ON, ON-(ON), ON-OFF-ON, ON-OFF-(ON), (ON)-OFF-(ON)
Contact Rating : 20 A @250 VAC, 20 A @125 VAC, 20 A @30 VDC
Electrical Life : 20,000 cycles
Mechanical Life : 40,000 cycles
Contact Resistance : Max. 10 mOhm at 2-4 VDC 1 A
Insulation Resistance : Min. 1,000 MOhm
Dielectric Strength : 1,500 VAC for 1 min.
Actuation Force : Max. 29.4 N
Panel Cut-out : D-cut, 12.5 mm
Standards and Specs : UL, CSA

Environmental Specification

Operating Temperature : -20 to +70°C
Storage Temperature : -20 to +70°C
Vibration Resistance : 1.5 mm 10-55 Hz
Shock Resistance : 50 g for 11±1 msec
Terminal Strength : 24.5 N

Material Specifications

Contacts : Brass silver alloy finish
Toggle : Brass chromium plated
Terminals : Brass plate
Case : Phenol resin
Cover : Steel zinc plated
Seal : Rubber “o” ring panel seal, insert molded internal toggle seal

Other Characteristics

Contact Timing : Break before Make
Right Angle Versions : No
Standard Number of Positions : 2 or 3
Terminals / Mounting Style : Quick connect
Actuator Style : Standard toggle
Dimensions Case (LxWxH) : 33 x 19.5 ... 36.5 x 24.5 mm
Packaging : Bulk
Choice of momentary or maintained circuits



1 Pole



2 Pole

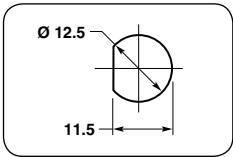

Panel Mounting Hole

Product Key

Typical Product Key				A	W	T	T	1	5	04
Type										
A				A Series power toggle switch, 1 & 2 pole						
Sealing										
W				Waterproof						
Actuator Style										
T				Toggle						
Switch Function & Poles										
1 pole				2 pole						
A				ON-OFF						
D				ON-ON						
E				ON-OFF-ON						
F				ON-(ON)						
G				(ON)-OFF-(ON)						
H				ON-OFF-(ON)						
N				ON-ON						
P				ON-OFF-ON						
R				ON-(ON)						
S				(ON)-OFF-(ON)						
T				ON-OFF-(ON)						
Power Rating										
1				20 A @ 125/250 VAC						
Terminal Type										
5				.250 Quick Connect Terminal						
Material										
04				RoHS Compliant						

PART NUMBERS						
Product Key	Sealing	Poles	Switch Function	Terminal	Rating	Part Number
AWTA1504	Waterproof	1 pole	ON-OFF	0.250 Quick Connect Terminal	20 A at 125/250 VAC	7-6437630-3
AWTD1504	Waterproof	1 pole	ON-ON	0.250 Quick Connect Terminal	20 A at 125/250 VAC	7-6437630-0
AWTE1504	Waterproof	1 pole	ON-OFF-ON	0.250 Quick Connect Terminal	20 A at 125/250 VAC	7-6437630-1
AWTF1504	Waterproof	1 pole	ON-(ON)	0.250 Quick Connect Terminal	20 A at 125/250 VAC	7-6437630-4
AWTG1504	Waterproof	1 pole	(ON)-OFF-(ON)	0.250 Quick Connect Terminal	20 A at 125/250 VAC	7-6437630-5
AWTH1504	Waterproof	1 pole	ON-OFF-(ON)	0.250 Quick Connect Terminal	20 A at 125/250 VAC	7-6437630-6
AWTN1504	Waterproof	2 poles	ON-ON	0.250 Quick Connect Terminal	20 A at 125/250 VAC	7-6437630-2
AWTP1504	Waterproof	2 poles	ON-OFF-ON	0.250 Quick Connect Terminal	20 A at 125/250 VAC	3-6437592-9
AWTR1504	Waterproof	2 poles	ON-(ON)	0.250 Quick Connect Terminal	20 A at 125/250 VAC	5-6437630-0
AWTS1504	Waterproof	2 poles	(ON)-OFF-(ON)	0.250 Quick Connect Terminal	20 A at 125/250 VAC	1-6437630-1
AWTT1504	Waterproof	2 poles	ON-OFF-(ON)	0.250 Quick Connect Terminal	20 A at 125/250 VAC	1-6437630-0

Product Key

Typical Product Key		A	4	T	K	1	5	W	04
Type									
A	A Series power toggle switch, 4 pole								
Poles									
4	4 pole								
Actuator Style									
T	Toggle								
Switch Function									
K	ON-OFF		P	ON-OFF-ON		S	(ON)-OFF-(ON)		
N	ON-ON		R	ON-(ON)					
Power Rating									
1	20 A @ 125/250 VAC								
Terminal Type									
5	.250 Quick Connect Terminal								
Sealing									
W	Waterproof								
Material									
04	RoHS Compliant								



4 Pole

PART NUMBERS						
Product Key	Sealing	Poles	Switch Function	Terminal	Rating	Part Number
A4TK15W04	Waterproof	4 poles	ON-OFF	0.250 Quick Connect Terminal	20 A at 125/250 VAC	8-6437630-0
A4TN15W04	Waterproof	4 poles	ON-ON	0.250 Quick Connect Terminal	20 A at 125/250 VAC	8-6437630-1
A4TP15W04	Waterproof	4 poles	ON-OFF-ON	0.250 Quick Connect Terminal	20 A at 125/250 VAC	8-6437630-2
A4TR15W04	Waterproof	4 poles	ON-(ON)	0.250 Quick Connect Terminal	20 A at 125/250 VAC	8-6437630-3
A4TS15W04	Waterproof	4 poles	(ON)-OFF-(ON)	0.250 Quick Connect Terminal	20 A at 125/250 VAC	8-6437630-4

How to Specify in a Switch

Electrical Considerations

Voltage of Applications: _____ Current of Application: _____

Circuitry Configuration: Number of Poles: _____ Number of Throws: _____

Number of Operations anticipated: _____

Agency Approvals or Listings Desired: _____

Mechanical Considerations

Type of Switch (Actuator Type): _____ Toggle _____ Pushbutton _____ Rotary _____ Rocker _____ Other

Switch Function (On/Off/On): _____ On/Off: _____ Momentary: _____

Termination: _____ Thru-Hole (PC) _____ Surface Mount _____ Wire Lug _____ Quick Connect _____ Other

Sealing Contamination Requirements: _____

Product Processing Considerations

Anticipated Soldering Process: _____ Hand _____ Wave _____ SMT _____ Other

FOR MORE INFORMATION

TE Technical Support Center

USA:	+1 (800) 522-6752
Canada:	+1 (905) 475-6222
Mexico:	+52 (0) 55-1106-0800
Latin/S. America:	+54 (0) 11-4733-2200
Germany:	+49 (0) 6251-133-1999
UK:	+44 (0) 800-267666
France:	+33 (0) 1-3420-8686
Netherlands:	+31 (0) 73-6246-999
China:	+86 (0) 400-820-6015

Part numbers in this brochure are RoHS Compliant*, unless marked otherwise.

*as defined www.te.com/leadfree

te.com

© 2011 Tyco Electronics Corporation, a TE Connectivity Ltd. Company. All Rights Reserved.

1-1773458-8 CIS LUG FP 1M 04/2011

ALCO, TE Connectivity, TE connectivity (logo) and TE (logo) are trademarks. Other logos, product and/or company names might be trademarks of their respective owners.

While TE has made every reasonable effort to ensure the accuracy of the information in this brochure, TE does not guarantee that it is error-free, nor does TE make any other representation, warranty or guarantee that the information is accurate, correct, reliable or current. TE reserves the right to make any adjustments to the information contained herein at any time without notice. TE expressly disclaims all implied warranties regarding the information contained herein, including, but not limited to, any implied warranties of merchantability or fitness for a particular purpose. The dimensions in this catalog are for reference purposes only and are subject to change without notice. Specifications are subject to change without notice. Consult TE for the latest dimensions and design specifications.



Mouser Electronics

Authorized Distributor

Click to View Pricing, Inventory, Delivery & Lifecycle Information:

TE Connectivity:

[AWTD1504](#) [AWTN1504](#) [AWTR1504](#) [AWTS1504](#) [AWTT1504](#) [A4TK15W04](#) [A4TN15W04](#) [A4TP15W04](#)
[A4TR15W04](#) [A4TS15W04](#) [ATP15W04](#) [AWTA1504](#) [AWTE1504](#) [AWTF1504](#) [AWTG1504](#) [AWTH1504](#)