

FLANGES

ISO-K Clamp Flange Components

BLANK FLANGE	DN ... ISO-K	Part No.	A	B
Steel nickel plated A570/-	63	212-001	95	12
	100	212-002	130	12
	160	212-003	180	12
	250	212-005	290	12
Stainless steel 304/-	63	212-011	95	12
	80	212-076	110	12
	100	212-012	130	12
	160	212-013	180	12
	200	212-014	240	12
	250	212-015	290	12
	320	212-016	370	17
	400	212-017	450	17
	500	212-018	550	17
	630	212-019	690	22



WELDING FLANGE	DN ... ISO-K	Part No.	A	B	C	D	E
Steel -/1.0570	63	212-021	95	76.1	70.3	12	6
	100	212-022	130	108	102.2	12	6
Steel A570/-	160	212-023	180	159	153.2	12	6
	250	212-025	290	267	261	12	6
Stainless steel 304/-	63	212-031	95	76.1	71.5	12	6
	80	212-078	110	88.9	84.9	12	6
	100	212-032	130	108	102	12	6
	160	212-033	180	159	155	12	6
	200	212-034	240	219.1	213.9	12	6
	250	212-035	290	267	261	12	6

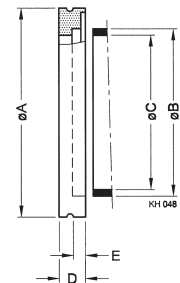

FLANGE WITH TUBE

	DN ... ISO-K	Part No.	A	B	C
Flange: Steel -/1.0570	63	212-041	100	76.1	70.3
Tube: Steel -/1.0831	100	212-042	100	108	102.2
	160	212-043	100	159	153.2
	250	212-045	100	267	261
	320	212-046	100	324	318
	400	212-047	100	406	400
	500	212-048	100	508	500
	630	212-049	100	660	650
Stainless steel 304/-	63	212-051	100	76.1	71.5
	100	212-052	100	108	104
	160	212-053	100	159	155
	200	212-054	100	219.1	213.1
	250	212-055	100	267	261
	320	212-056	100	324	318
	400	212-057	100	406	400
	500	212-058	100	508	500
	630	212-059	100	660	650

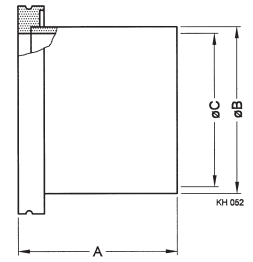

GLOBAL HEADQUARTERS:

Two Technology Place, East Syracuse, NY 13057 USA
Tel: +1.315.434.1100 Fax: +1.315.437.3803 E-mail: reachus@inficon.com

UNITED STATES FRANCE GERMANY LIECHTENSTEIN SWITZERLAND UNITED KINGDOM CHINA JAPAN KOREA SINGAPORE TAIWAN

Visit our website for contact information and other sales offices worldwide. www.inficon.com
Due to our continuing program of product improvements, specifications are subject to change without notice.
qiba10e1 (2004-04) ©2003 INFICON Inc.