

5

4

3

2

1

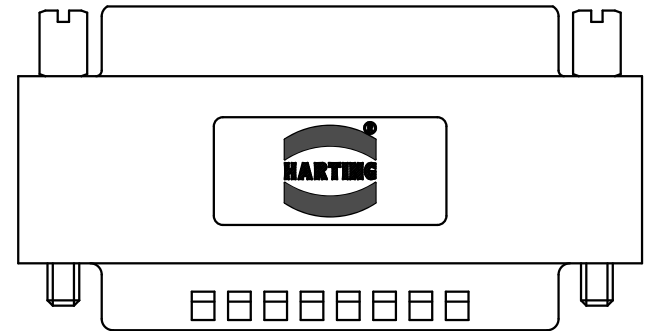
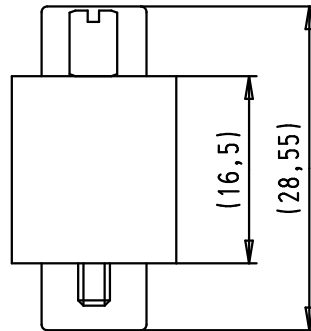
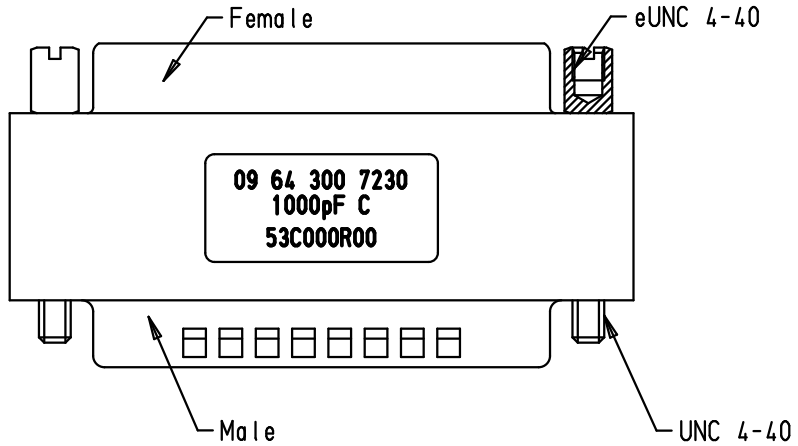

SPECIFICATIONS

Filter type	C
Capacitance	1000 pF±20%
Working voltage	100 V
Current rating	6,5 A

Minimum insertion loss

FREQUENCY (MHz)	ATTENUATION (dB)
5	1
10	3
50	12
100	20
500	34
1000	30

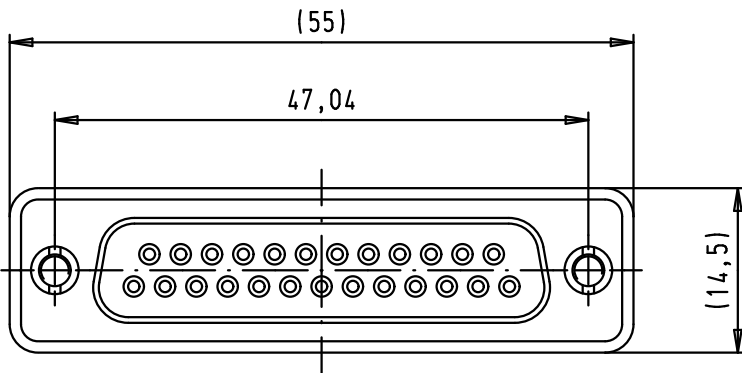

Note: Jack-screws are not pre-mounted to allow mounting from any ends

				Dot.	Name		Male / Female D-Sub filter adapter, 25 poles, 1000 pF	Maßstab/ Scale
			Detail.	03/09/07	JS			1,5:1
			Insp.			All Dim. in mm Orig. Size DIN A 4	TB 09 64 300 7230	Blatt/ Page
34901	01/04/08	BB	Stand.					1 / 1
34894	12/03/08	PK					Sub.	
	03/09/07	JS						
Mod.	Dot.	Name	HARTING EURL F-95972 Paris					