

Surface Mount 719.0MHz SAW Filter

AFS20A05-719.00-T3

Moisture Sensitivity Level (MSL) – This product is Hermetically Sealed and not Moisture Sensitive - MSL = N/A: Not Applicable



RoHS/RoHS II Compliant



2.0 x 1.6 x 0.75 mm

FEATURES:

- 2.0 x 1.6 x 0.75 mm low profile SMT package
- Low Insertion loss
- Excellent selectivity with high out-of-band rejection

APPLICATIONS:

- Wireless Communication
- Remote Control
- Cellular Phones

ELECTRICAL SPECIFICATIONS:

Maximum Ratings

Item	Value
Input Power Level	+10 dBm max.
DC Permissive Voltage	3V DC max.
Operating Temperature Range	-30°C to +85°C
Storage Temperature Range	-40°C to +85°C

Parameters	Minimum	Typical	Maximum	Units	Notes
Center Frequency (f_c)		719		MHz	
Insertion Loss (IL)		3.00	3.20	dB	716.5 ~ 721.5MHz
Effective Bandwidth		5.00		MHz	
Amplitude Ripple		0.90	2.20	dB	716.5 ~ 721.5MHz
Group Delay Variation		38	95	ns	716.5 ~ 721.5MHz
Worst-Case Input / Output Return Loss	5	8		dB	716.5 ~ 721.5MHz
Stop-band Attenuation (Referenced to 0.0 dB)	40	49		dB	DC ~ 690MHz
	35	44			690 ~ 704MHz
	30	44			704 ~ 710MHz
	25	30			728 ~ 734MHz
	27	40			734 ~ 750MHz
	37	50			750 ~ 824MHz
	45	51			824 ~ 960MHz
	32	35			960 ~ 2500MHz
Source Impedance (Z_S)		50		Ω	See note # 1
Load Impedance (Z_L)		50		Ω	See note # 1

Note #1: No matching network required for operation into 50 Ω 's

TEST CIRCUIT:

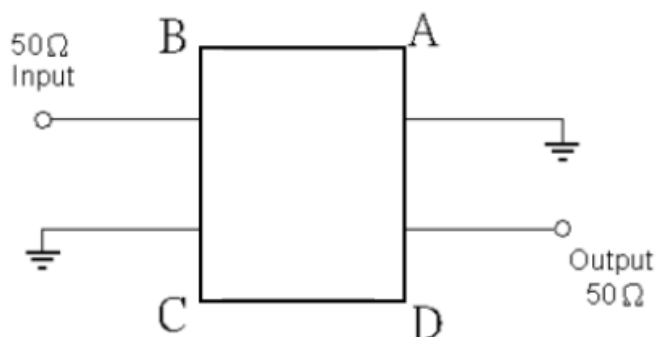

Surface Mount 719.0MHz SAW Filter

AFS20A05-719.00-T3



RoHS/RoHS II Compliant



2.0 x 1.6 x 0.75 mm

OUTLINE DIMENSIONS:

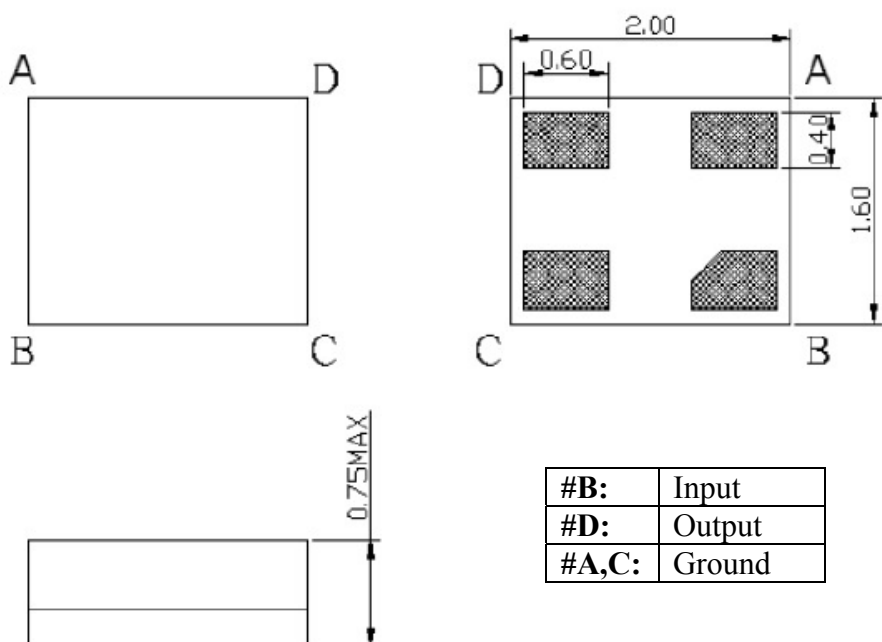

Recommended Land Pattern:

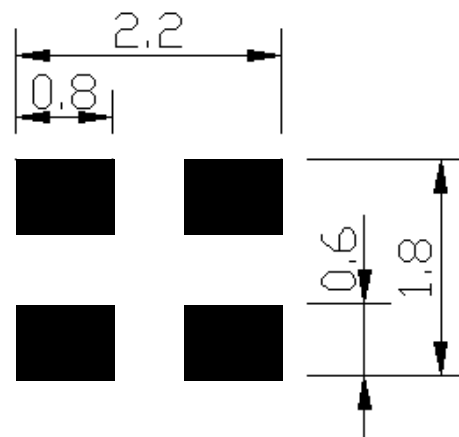

#B:	Input
#D:	Output
#A,C:	Ground

*All Dimensions are in mm

FREQUENCY CHARACTERISTICS:

Filter Frequency Response (Narrowband)

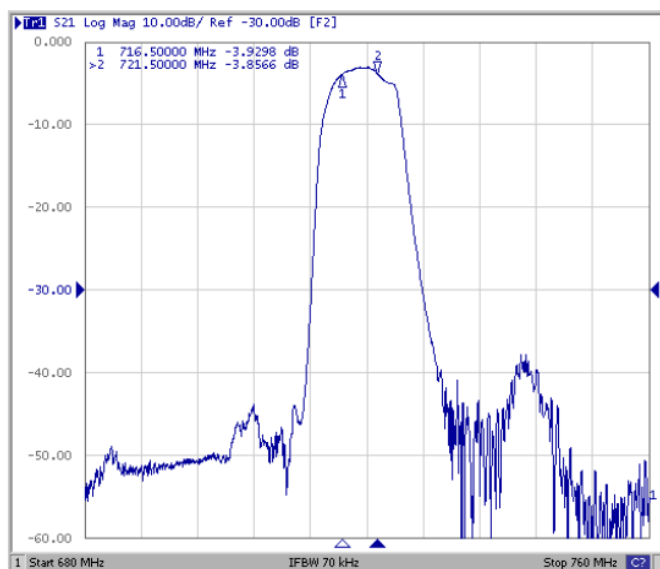

Filter Frequency Response (Wideband)

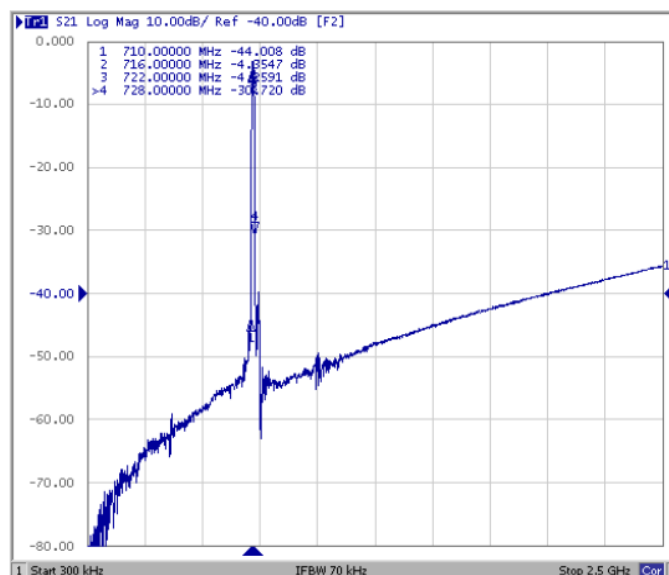

Surface Mount 719.0MHz SAW Filter

AFS20A05-719.00-T3



RoHS/RoHS II Compliant



2.0 x 1.6 x 0.75 mm

FREQUENCY CHARACTERISTIC:

Input Return Loss (S11)

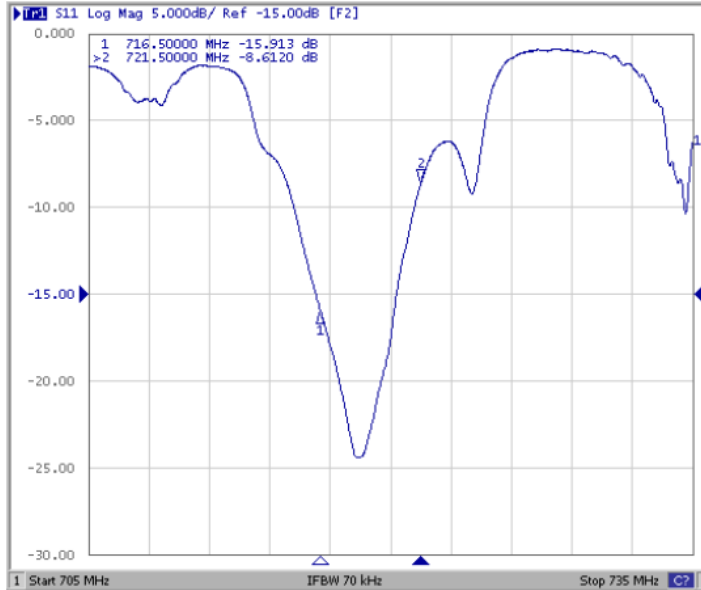

Output Return Loss (S22)

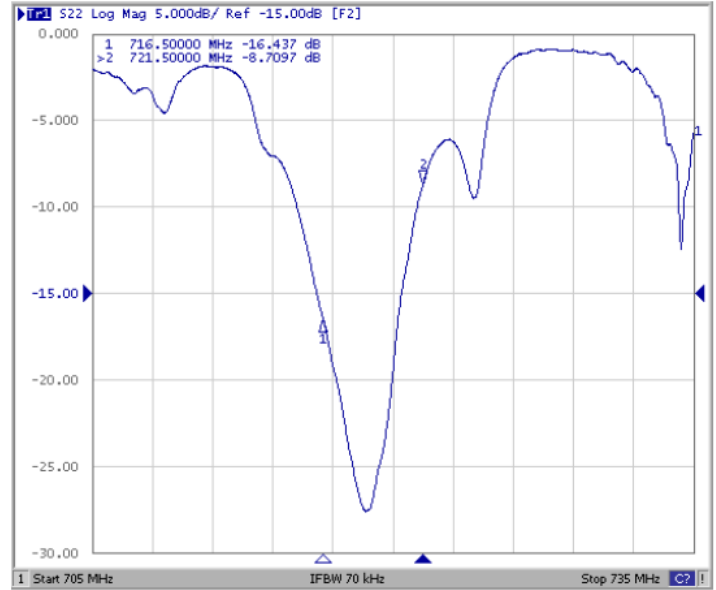

Note # 2: Detail S-parameter information (.s2p file) available upon request

REFLOW PROFILE:

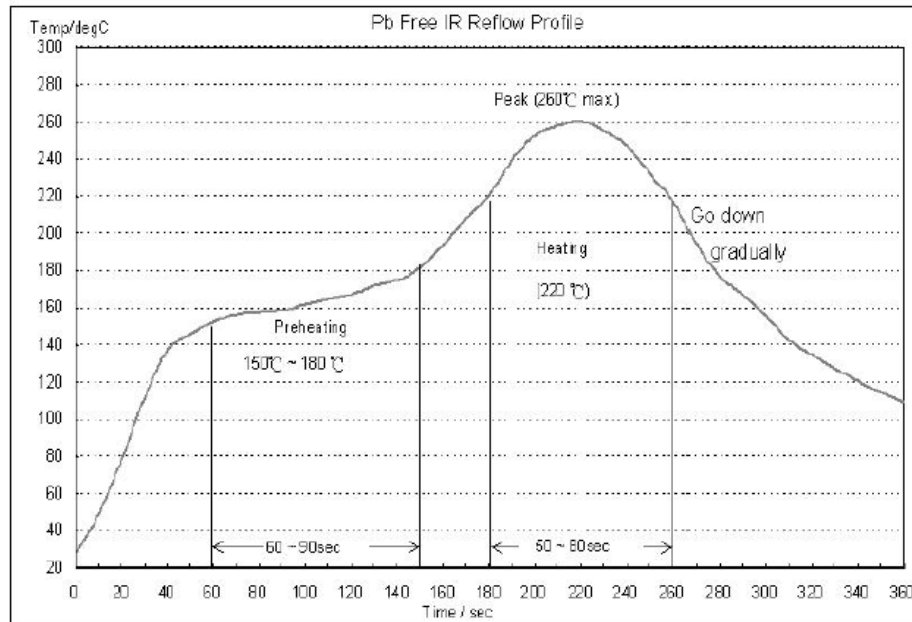

Surface Mount 719.0MHz SAW Filter

AFS20A05-719.00-T3

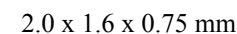

 **RoHS/RoHS II Compliant**

2.0 x 1.6 x 0.75 mm

PACKAGING: 3,000 units/reel

Tape Dimensions

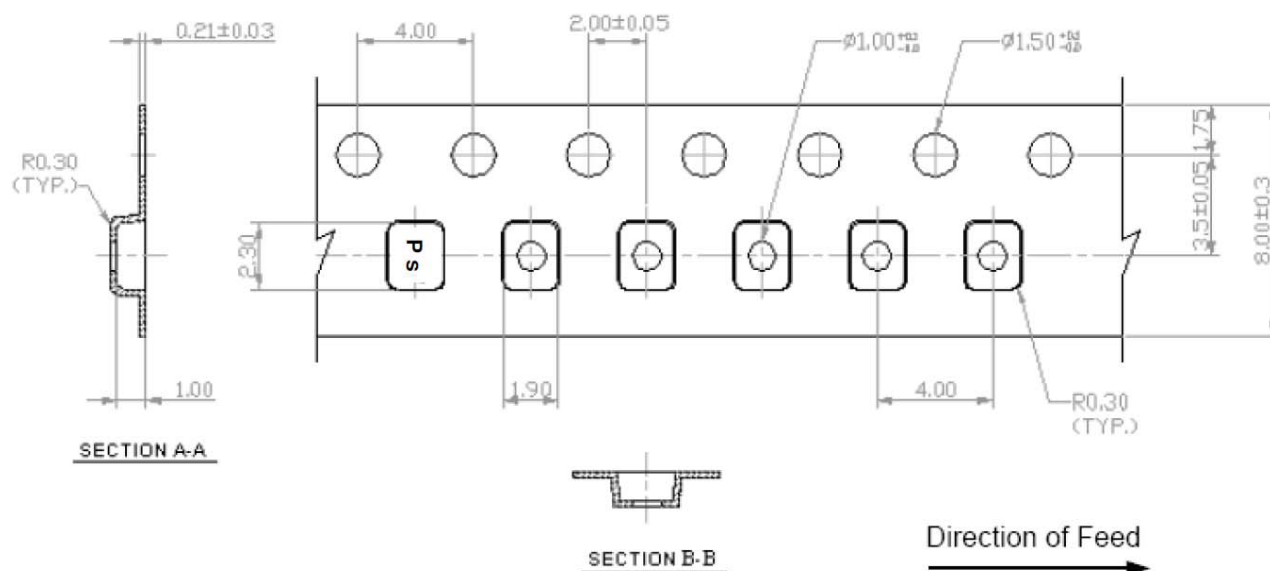

Reel Dimensions

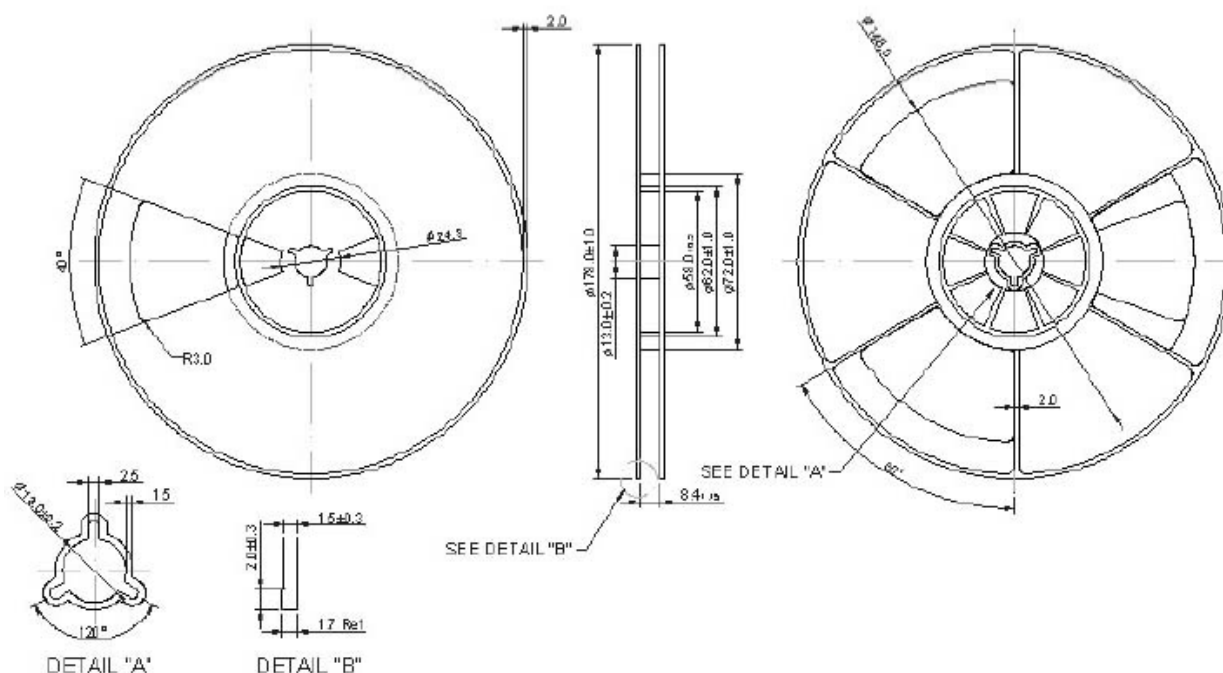

Dimensions: mm

ATTENTION: Abracon Corporation's products are COTS – Commercial-Off-The-Shelf products; suitable for Commercial, Industrial and, where designated, Automotive Applications. Abracon's products are not specifically designed for Military, Aviation, Aerospace, Life-dependant Medical applications or any application requiring high reliability where component failure could result in loss of life and/or property. For applications requiring high reliability and/or presenting an extreme operating environment, written consent and authorization from Abracon Corporation is required. Please contact Abracon Corporation for more information.