

**EM2416 Series**  
**EuroMag Terminal Blocks**  
Pluggable Block with Flanges (Mates with  
EM2426 Series); 7.62 Centers

**SPECIFICATIONS**  
**Rating:** 16A, 300V  
**Center Spacing:** 0.30" (7.62mm)  
**Wire Range:** #12-24 AWG  
**Housing Material:** UL rated 94V0 Thermoplastic  
**Contact Material:** Tin-Plated Brass  
**Cage Material:** Brass, Nickel-Plated  
**Screw Size:** M2.6 Zinc-Plated Steel  
**Operating Temperature:** 105°C (221°F) max., -40°C (-40°F) min.  
**Torque Rating:** 7.0 lb-in.  
**Construction:** Mold-to-Length  
**Agency Information:** File E62622; CE Certified



EM241602

Dimensions - mm

Poles	L (mm)
2	24.90
3	32.50
4	40.10
5	47.80
6	55.40
7	63.00
8	70.60
9	78.20
10	89.90
11	93.50
12	101.10

To convert to inches, divide by 25.4

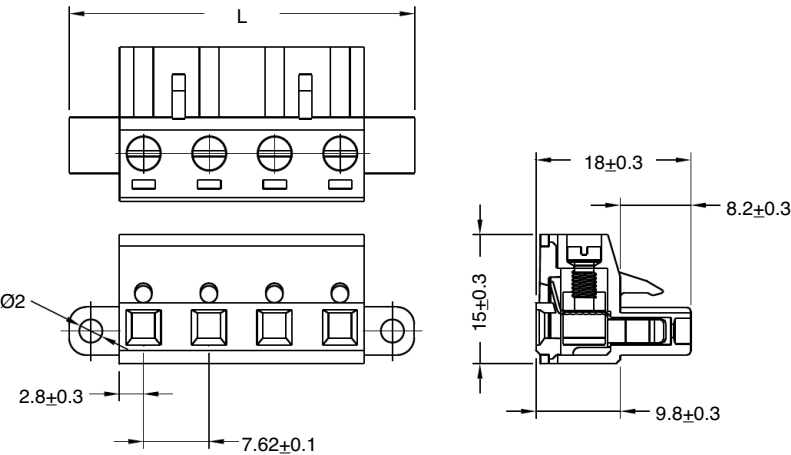

**Part Numbering System**

Series # of Poles

EM2416

02 to 12

Mating Header: EM2426 pg. 102