

ASSEMBLED VIEW
SCALE 1:1

RECOMMENDED PANEL
MOUNT OPENING
MAX PANEL THK .080/2.03

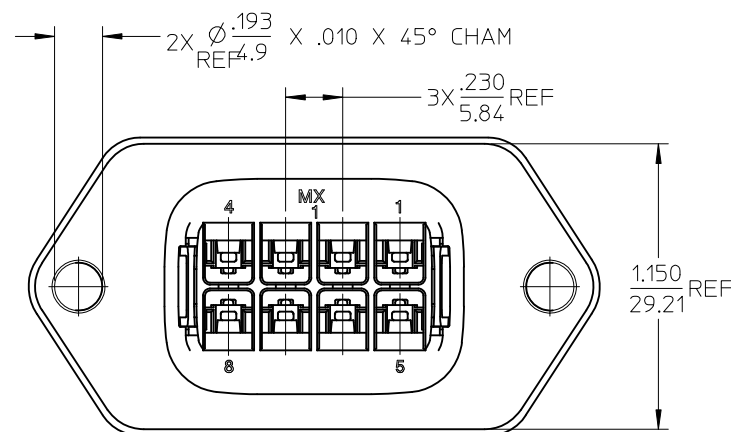
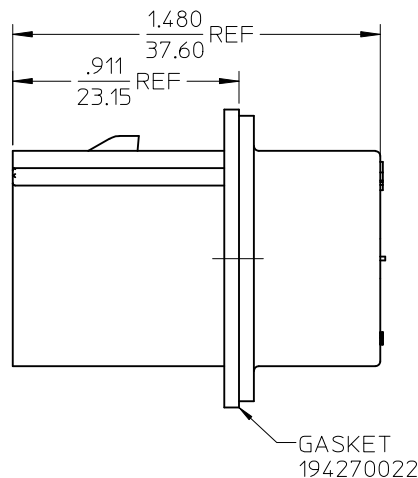
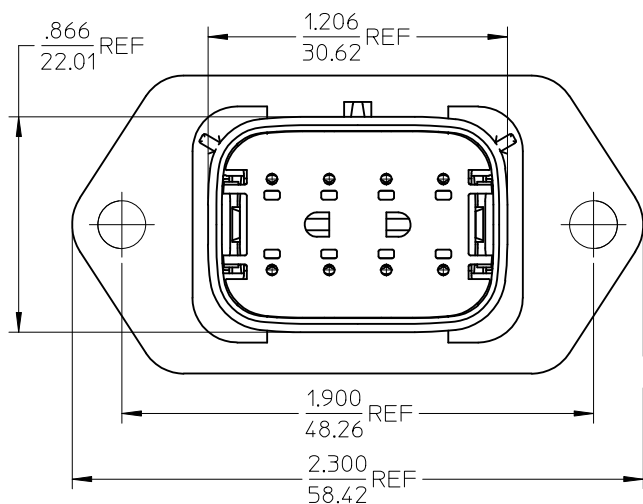

- NOTES:
1. MATERIALS:
HOUSING: POLYESTER (PBT), GLASS FILLED, UL94 V-0,COLOR: BLACK
GASKET: EPDM RUBBER
2. PRODUCT SPECIFICATION: PS-19417-001.
3. PACKAGING SPECIFICATION: PK-19429-001.
GASKETS, IF REQUIRED FOR THE ASSEMBLIES,ARE BULK PACKAGED IN A SEPARATE BAG.
4. MATES WITH: 19418 SERIES RECEPTACLE ASSEMBLIES.
5. USE CONNECTOR WITH MALE CRIMP TERMINAL: SERIES 19417.
6. RECOMMENDED MOUNTING HARDWARE: (2) #10 X .62/15.8 LONG
PLASTIC THREAD CUTTING SCREWS, RECOMMENDED TORQUE 15-17 IN.-LBS.
SUGGESTED SOURCE: ITW SHAKEPROOF INDUSTRIAL BOSSCREW OR EQUIVALENT.
7. ASSEMBLY IS ROHS COMPLIANT.

REVISE NOTES EC NO: IPG2012-0161 DRWN:WLEUNG 2012/02/10 CHKD: APPR:DTITUS 2012/02/28	QUALITY SYMBOLS	DESCRIPTION	GENERAL TOLERANCES (UNLESS SPECIFIED)		SCALE 2:1	DESIGN UNITS INCH	THIRD ANGLE PROJECTION		REVISE ON CAD ONLY		
					DIMENSION STYLE		TITLE				
					IN/MM		8 WAY PLUG PANEL MOUNT ASSEMBLY W/O BOSS 22-14 AWG				
					DRAWN BY DATE						
					DMYRICK 04/07/20						
REV B	QUALITY SYMBOLS	DESCRIPTION	mm INCH								
			4 PLACES ± --- ± ---		DRAWN BY DATE						
			3 PLACES ± --- ± .015		DMYRICK 04/07/20						
			2 PLACES ± 0.38 ± ---		CHECKED BY DATE						
			1 PLACE ± --- ± ---		JPAWLICK 04/07/20		MOLEX MOLEX INCORPORATED				
			ANGULAR ± 1 °		APPROVED BY DATE		MATERIAL NO. DOCUMENT NO. SHEET NO.				
		DRAFT WHERE APPLICABLE		RDEROSS 04/07/20		SEE CHART SD-19429-013		1 OF 1			
		MUST REMAIN WITHIN DIMENSIONS		THIS DRAWING CONTAINS INFORMATION THAT IS PROPRIETARY TO MOLEX INCORPORATED AND SHOULD NOT BE USED WITHOUT WRITTEN PERMISSION						B	

194290045	YES
194290029	NO
MATERIAL NUMBER	GASKET
8 WAY PLUG PANEL MOUNT ASSEMBLY W/O BOSS 22-14 AWG	
MOLEX INCORPORATED	