

# IB and IS series

Sealed pushbutton switches - bushing Ø 12 mm - momentary

*Distinctive features and specifications*

UG1410A



- ☐ Snap-in and threaded bushing models
- ☐ Compact, light in weight
  - Behind-panel depth of 13 mm (.512) only
  - 50 % reduction in weight compared to metallic models
- ☐ Tactile feedback
- ☐ Sealed to IP67 (IS series) or IP54 (IB series)

## ENVIRONMENTAL SPECIFICATIONS

- Front panel sealing according to IEC 60529 : IP67 (IS) or IP54 (IB)
- Shock resistance : 100 g according to IEC 512-4, test 6c
- Vibration resistance : 10-500 Hz - 10 g according to IEC 512-4, test 6d
- Salt spray : IEC 512-6, test 11f
- Operating temperature : -40°C to +85°C

## MATERIALS

- Case : thermoplastic UL94-V0
- Actuator : polyamide 6/6
- Bushing/bezel : polyamide 6/6
- Contacts : silver, gold plated
- Terminal seal : epoxy

## ELECTRICAL SPECIFICATIONS

- Max. current/voltage rating with resistive load :  
400mA 32VAC - 100mA 48VDC
- Initial contact resistance : 50 mΩ max.
- Insulation resistance : 1 GΩ min. at 500VDC
- Dielectric strength : 1.000 Vrms
- Electrical life at full load : 500.000 cycles

## AGENCY APPROVAL



2A 125VAC/250VAC  
File E83438

**Availability** : consult factory for details of approved models.

**Marking** : to order switches marked UL, complete appropriate box of ordering format.

## GENERAL SPECIFICATIONS

- Panel thickness :
  - IB series : 0,8 mm (.031) min. - 1,8 mm (.071) max.
  - IS series : 1,5 mm (.059) min. - 4 mm (.157) max.
- Total travel : 1,7 mm (.066) +/- 0,3 mm
- Typical operating force : 4N +/- 3N
- Low level or mechanical life : 1.000.000 cycles
- Torque : 1,5 Nm max. applied to nut
- Soldering : 300°C max. for 3 seconds

*Example of custom switch:  
see end of the series.*

**Panel mounting** : see next pages.

The company reserves the right to change specifications without notice.

# IB and IS series

Sealed pushbutton switches - bushing Ø 12 mm - momentary

## Overview

### MODEL STRUCTURE

SERIES	Actuator shapes	Electrical function	Terminals	Contacts
<b>IB</b> Snap-in <b>IS</b> Threaded bushing	<b>R</b> Round, curved <b>P</b> Round, flat	<b>3</b> Normally open (NO)	<b>S</b> Solder lug <b>P</b> Straight PC <b>Z1</b> Quick-connect 2,8 x 0,5 mm	<b>AD</b> Silver, gold plated

### OPTIONS

Actuator colours	Bezel finish	Option	Approval
<b>1</b> Blue <b>B</b> Dark blue <b>2</b> Black <b>3</b> Green <b>4</b> Grey <b>5</b> Yellow <b>6</b> Red <b>7/1</b> White <b>8</b> Bright chrome <b>9</b> Orange <b>A</b> Satin chrome	<b>00</b> Black (std) <b>08</b> Bright chrome (IS only) <b>10</b> White <b>20</b> Satin chrome (IS only)	<b>104</b> High actuator	<b>UL</b> Consult factory for detail of approved models.

### ABOUT THIS SERIES

On the following pages, you will find successively :

- model structure of switches and options in the same order as in above chart

**Dimensions** : first dimensions are in mm while inches are shown as bracketed numbers.



**NOTICE** : please note that not all combinations of above numbers are available. Refer to the following pages for further information.



**A sealing boot** is available to protect the switches against frost and sand. It is presented after the IA series and in section H.



**Mounting accessories** : Standard hardware supplied : 1 flat seal (IB series)  
1 hex nut 14 mm (.551) across flats and 1 flat seal (IS series). Hex nut part number U166.



**Packaging unit** : 50 pieces

# IB and IS series

## Sealed pushbutton switches - bushing Ø 12 mm - momentary

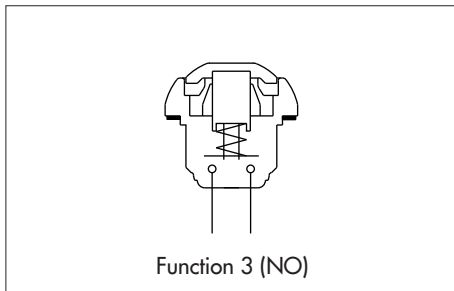

- Ten actuator colours
- Curved or flat actuator
- Antirotation bushing

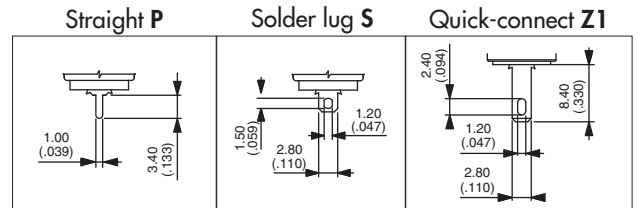

### MODEL STRUCTURE

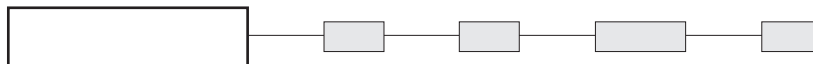

Actuator marking available on IBP and ISP models (symbol 10 mm max.). On request.

### Snap-in mounting - solder lug terminals

→ Flat

Panel thickness : 0,8 mm to 1,8 mm



Curved actuator  
**IBR3SAD**



Normally open

Flat actuator  
**IBP3SAD**



Normally open

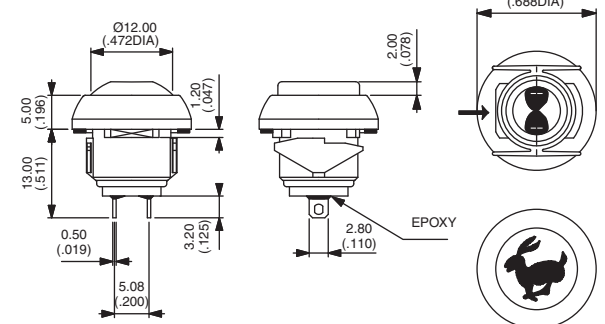

Also available with straight PC : **IB•3PAD** or quick-connect terminals : **IB•3Z1AD**

### Mounting by threaded bushing - solder lug terminals

→ Flat

Panel thickness : 1,5 mm to 4 mm



Curved actuator  
**ISR3SAD**



Normally open

Flat actuator  
**ISP3SAD**



Normally open

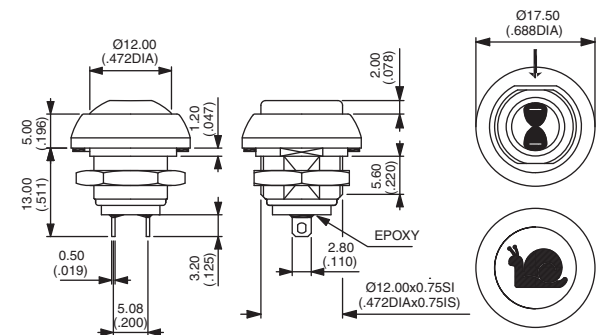

Also available with straight PC : **IS•3PAD** or quick-connect terminals : **IS•3Z1AD**

### ACTUATOR COLOURS

Actuator marking available on IBP and ISP models (symbol 10 mm max.). On request.

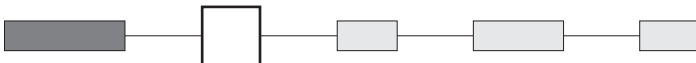

1 : blue - B : dark blue - 2 : black - 3 : green - 4 : grey - 5 : yellow - 6 : red - 7/1 : white - 8 : bright chrome  
9 : orange - A : satin chrome

### BUSHING AND BEZEL FINISH



00 : Black (standard)  
08 : Bright chrome (IS series only)  
10 : White  
20 : Satin chrome (IS series only)

# IB and IS series

Sealed pushbutton switches - bushing Ø 12 mm - momentary

## ACTUATOR OPTION

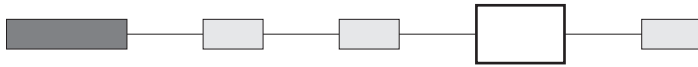

104 : High actuator

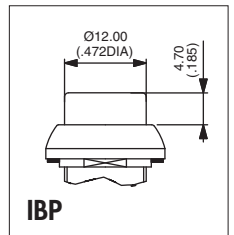
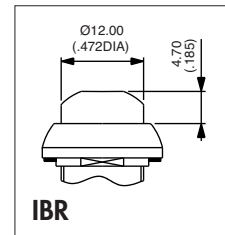

## APPROVAL

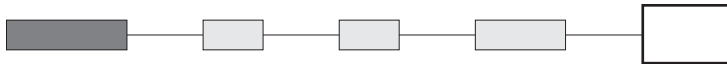

UL

**Availability** : consult factory for details of approved models.

**Marking** : to order switches marked UL, complete above box with "UL".

## IB SERIES MOUNTING

### Panel cut-out

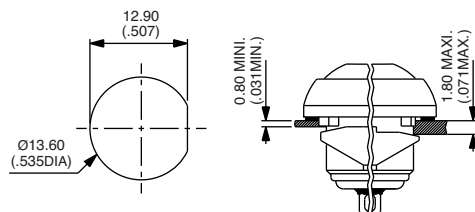

### Matrix mounting

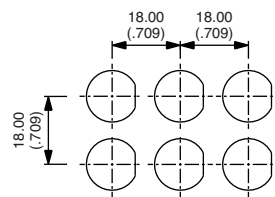

## IS SERIES MOUNTING

### Panel cut-out

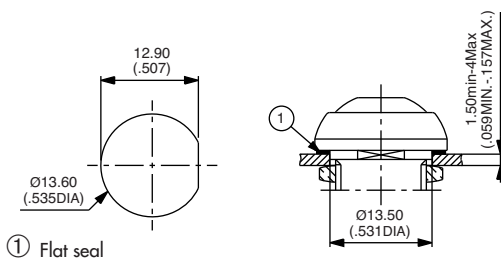

### Matrix mounting

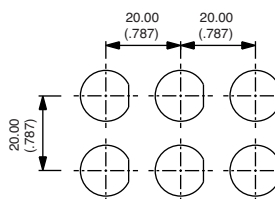

## Example of custom switch



ISR3FADB22X1248-01

- Painted bushing and actuator, soft feel
- Flying leads (55 mm) + connector
- Overmolded rear part

# Mouser Electronics

Authorized Distributor

Click to View Pricing, Inventory, Delivery & Lifecycle Information:

[Apem:](#)

[ISR3PAD200](#)