

**MRF 1.6/5.6  
SERIES**

**RF CO-AXIAL CONNECTORS**

# MODEL IEC169-13 1.6/5.6 COAXIAL CONNECTORS

## Overview

The MRF1.6/5.6 series coaxial connectors comply with the IEC 169-13 1.6/5.6, and are compatible with three types of mating systems with a characteristic impedance of  $75\Omega$ . These connectors are widely used mainly for transmission and switching equipment.

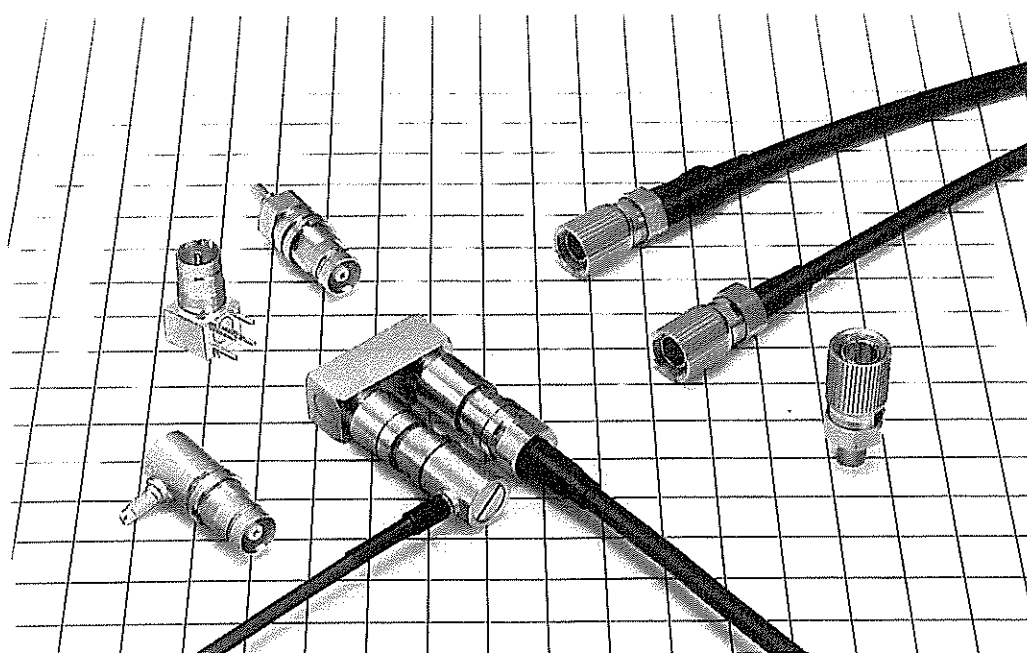

## Features

- (1) Complies with IEC 169-13.
- (2) Compatible with three types of mating systems according to applications.  
The jack can be used for three types of mating systems.  
< (mating systems) > : A : Screw coupling B : Push-on C : Plug-in (A : Standard).
- (3) Suitable for small cables of 3C-2W or less.
- (4) Reduced in diameter to 70% of the BNC series.

## Applications

Transmission and switching equipment, electronic measuring instruments, communications equipment, video equipment, and controllers.

# MRF 1.6/5.6 SERIES

# RF CO-AXIAL CONNECTORS

## Material/Finish

Part	Material	Finish
Armor (shell)	Brass	Nickel -plated Silver-plated
Center contact (male)	Brass	Gold-plated
Center contact (female)	Beryllium copper	Gold-plated
Outer contact (male)	Phosphor bronze	Gold-plated
Outer contact (female)	Brass	Gold-plated
Insulation	Tetrafluoride resin	—
Crimp sleeve	Copper	Nickel -plated
Heat shrinkable tube	Polyolefin	—

## Performance

Item	Standard
Contact resistance	4m $\Omega$ (center), 2m $\Omega$ (outer) or less at 1 ADC
Insulation resistance	1,000M $\Omega$ or higher at 50 0VDC
Withstand voltage	1,000 VAC for 1 min.
Characteristic impedance	75 $\Omega$
VSWR	1.2 or less at DC-500MHz

## Schematic

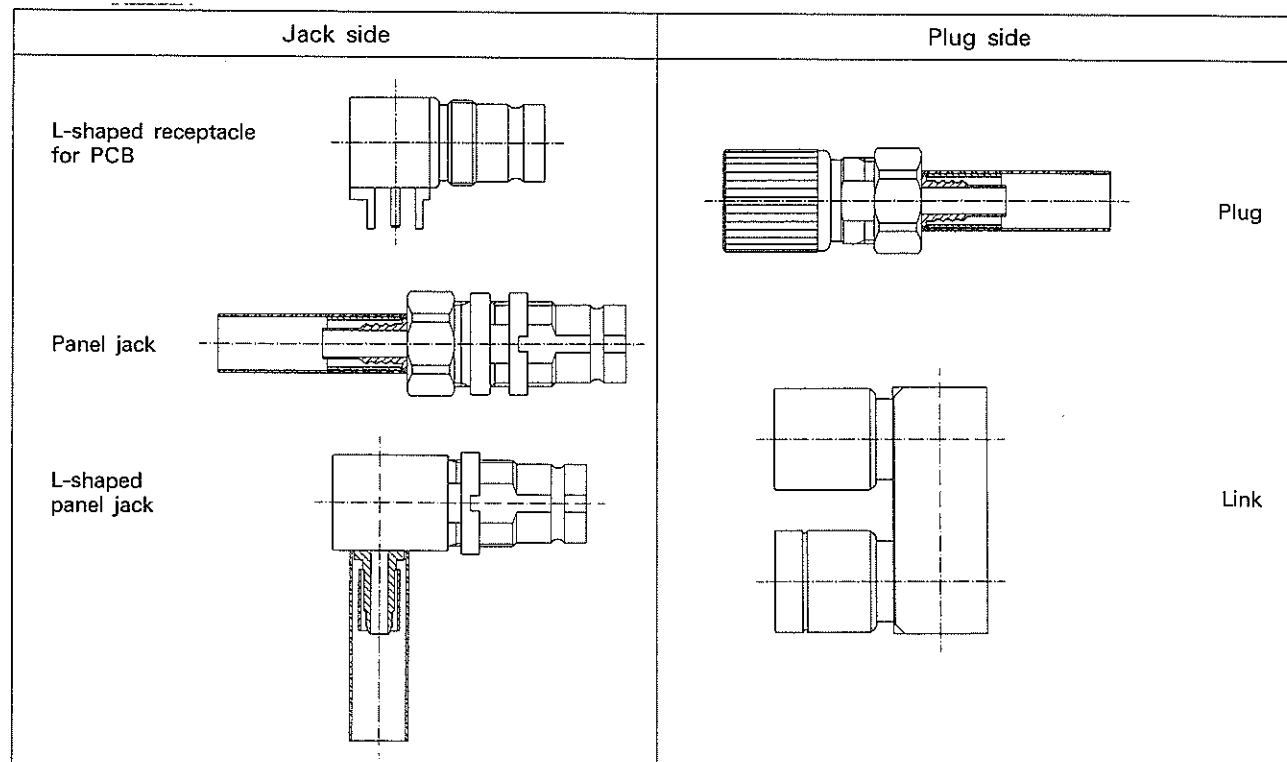

# MRF1.6/5.6 SERIES

# RF CO-AXIAL CONNECTORS

## Mating system identification

The Mating system is identified by the alphabetic characters preceding the letters indicating the type of a plug part number.

<Plug part number identification>

**MRF1.6/5.6** - ※<sub>1</sub> **P** - ※<sub>2</sub>

Letter indicating mating system

Letter indicating plug type

Letter indicating mating system

Series name

<Letters indicating mating system>

A or none : Screw coupling,

B : Push-on

C : Plug-in

## Plug

HRS No.	Part No.	Applicable cable	Connecting tool	Dimension "A"
CL313-0329-7-40	MRF(1.6/5.6)-P-3C(40)	3C-2V, 3C-2WS	HT303/MRF(1.6/5.6)-T-1	26.2
CL313-0393-6-40	MRF1.6/5.6-AP-2.5C(40)	2.5C-2V	HT303/HRM-T-4(58A/U hole)	30
CL313-0397-7-40	MRF1.6/5.6-AP-59U(40)	RG-59/U	HT303/MRF(1.6/5.6)-T-1	26.2

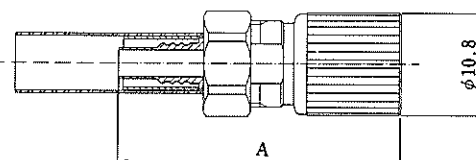
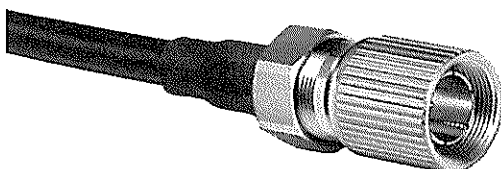

## Panel jack

HRS No.	Part No.	Applicable cable	Connecting tool	Dimension "A"
CL313-0394-9-40	MRF1.6/5.6-PJ-2.5C(40)	2.5C-2V	HT303/HRM-T-4(58A/U hole)	32
CL313-0398-0-40	MRF1.6/5.6-PJ-59U(40)	RG-59U	HT303/MRF(1.6/5.6)T-1	28.2
CL313-0399-2-40	MRF1.6/5.6-PJ-179U(40)	RG-179/U	HT303/UM-MSS-T-1(1.5hole)	30.75

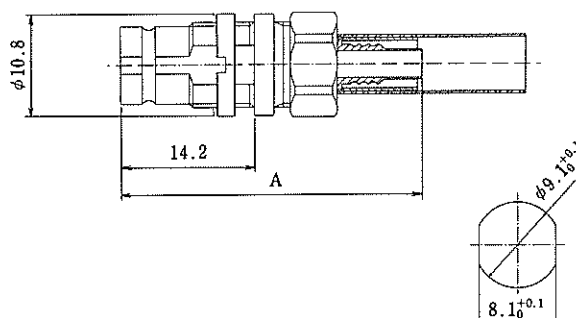
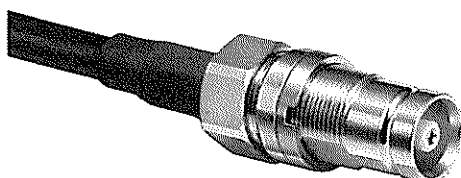

Panel cutout dimensions,  
Panel thickness : 1~2.5mm

# MRF1.6/5.6 SERIES

# RF CO-AXIAL CONNECTORS

## L-shaped panel jack

HRS No.	Part No.	Applicable cable	Connecting tool	Dimension "A"
CL313-0395-1-40	MRF1.6/5.6-LPJ-179U(40)	RG-179/U	UM-MSS-T-1(1.5 hole)	18.75

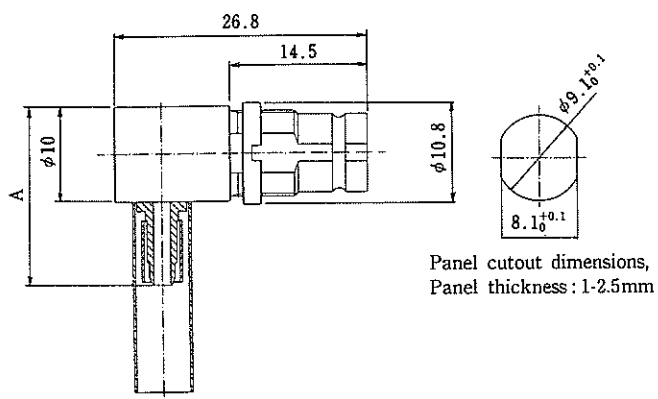
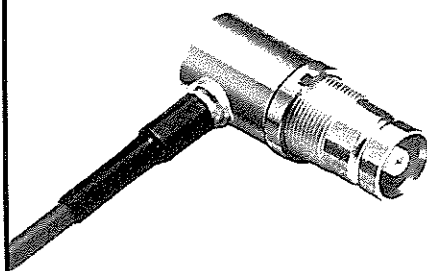

## L-shaped receptacle for PCB

HRS No.	Part No.	Dimension "A"
CL313-0330-6-40	MRF(1.6/5.6)-LR-PC(40)	4.1
CL313-0390-8-40	MRF1.6/5.6-LR-PC-1(40)	3.1

