

AA3528SF4C

Features

- SUITABLE FOR ALL SMT ASSEMBLY AND SOLDER PROCESS.
- AVAILABLE ON TAPE AND REEL.
- COMPATIBLE WITH AUTOMATIC PLACEMENT EQUIPMENT.
- HIGH RELIABILITY AND LONG LIFETIME.

Description

SF4 Made with Gallium Aluminum Arsenide Infrared Emitting diodes.

Package Dimensions

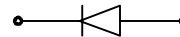
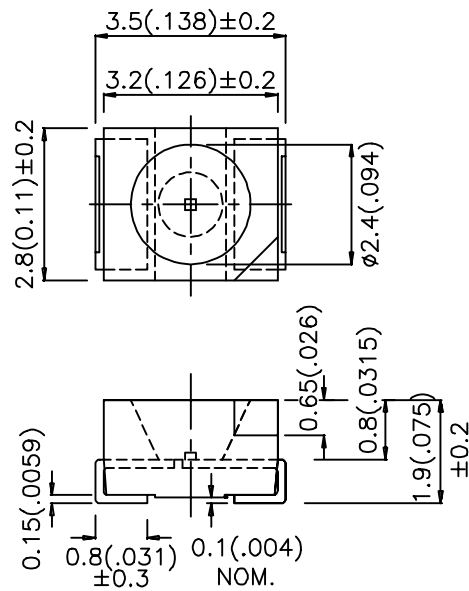

Notes:

1. All dimensions are in millimeters (inches).
2. Tolerance is $\pm 0.25(0.01)$ unless otherwise noted.
3. Lead spacing is measured where the lead emerge package.
4. Specifications are subjected to change without notice.

Selection Guide

Part No.	Dice	Lens Type	Iv (mW/sr) @20mA *50mA		Viewing Angle
			Min.	Typ.	
AA3528SF4C	GaAlAs	WATER CLEAR	0.8	1.5	120°
			*2	*4	120°

Note:

1. $\theta 1/2$ is the angle from optical centerline where the luminous intensity is 1/2 the optical centerline value.

Electrical / Optical Characteristics at T_A=25°C

Item	P/N	Symbol	Typ.	Max.	Unit	Condition
Forward Voltage	SF4	VF	1.4	1.7	V	IF=20mA
Reverse Current	SF4	IR	-	10	uA	VR=5V
Junction Capacitance	SF4	Co	90	-	pF	V=0 f=1MHz
Peak Spectral Wavelength	SF4	IR	880	-	nm	IF=20mA
Spectral Bandwidth	SF4	$\Delta\lambda$	50	-	nm	IF=20mA

Absolute Maximum Ratings at T_A=25°C

Item	Symbol	Maximum Rating	Units
Power Dissipation	Pd	100	mW
Forward Current	IF	50	mA
Peak Forward Current	I _P	1.2	A
Reverse Voltage	VR	5	V
Operating Temperature	T _{opr}	-45~ +80	°C
Storage Temperature	T _{stg}	-45~ +80	°C

Note:

1. I_p Condition : 1/10 Duty Cycle, 0.1ms Pluse Width.

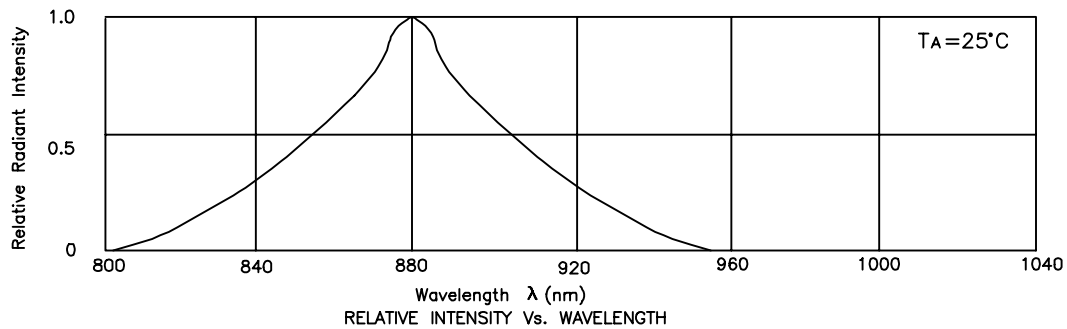

AA3528SF4C

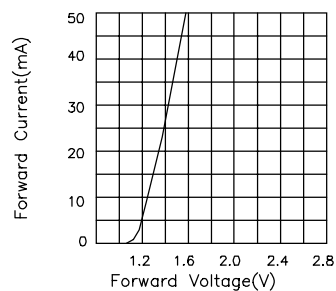

FORWARD CURRENT Vs. FORWARD VOLTAGE

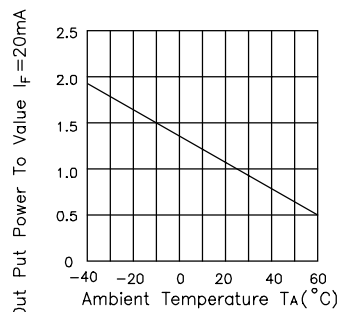

FORWARD CURRENT DERATING CURVE

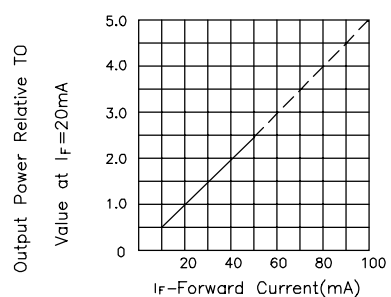

Relative Radiant Intensity Vs. Forward Current

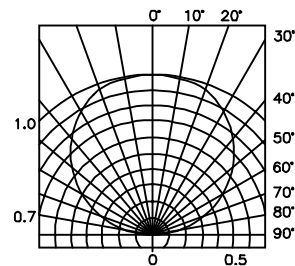

SPATIAL DISTRIBUTION

AA3528SF4C SMT Reflow Soldering Instructions

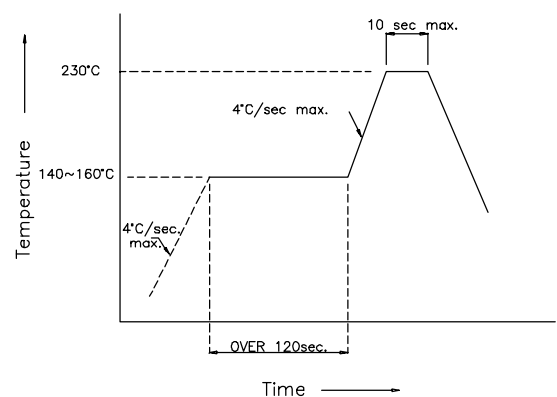

AA3528SF4C Recommended Soldering Pattern
(Units : mm)

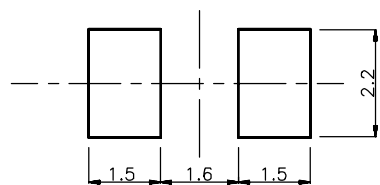

AA3528SF4C Tape Specifications (Units : mm)

