

KSU Series

Micro Mini Surface Mount Detect Switches



Features/Benefits

- New multi contact construction
- Metal actuator
- Low actuating force
- Gold contacts
- Compatible with pick and place machines
- RoHS compliant and compatible

Typical Applications

- Mobile phones and other handheld devices
- Portable medical devices
- Audio devices
- Automotive
- Alarm devices
- Payment terminals

Specifications

FUNCTION: Momentary action.

CONTACT TYPE: SPST Normally open.

TERMINALS: Gullwing type for SMT.

Mechanical

ACTUATING FORCE:

W version: 1,1 N \pm 0,8 N

ST version: 0,7 N \pm 0,5 N

TRAVEL TO MAKE:

W version: 0,65 mm - 0,45/+0,25 mm

ST version: 0,45 mm - 0,25/+0,1 mm

MECHANICAL TRAVEL: 1,5 \pm 0,2 mm

OPERATING LIFE: 100,000 cycles

Packaging

Switches are delivered on continuous tape, in reels of 1,000 pieces

Electrical

MAXIMUM POWER: 0.2 VA

MAXIMUM VOLTAGE: 32 VDC

MINIMUM VOLTAGE: 20 mV

MAXIMUM CURRENT: 0.01 A

MINIMUM CURRENT: 0.01 mA

CONTACT RESISTANCE: \leq 100 m Ω

INSULATION RESISTANCE: (100 VDC) 10⁹ Ω

DIELECTRIC STRENGTH: \geq 250 Vrms

BOUNCE TIME: \leq 3 ms

Environmental

OPERATING TEMPERATURE: -40°C to +125°C

STORAGE TEMPERATURE: -55°C to + 125°C

Process

SOLDERING: Compatible with lead free reflow process

NOTE: Specifications listed above are for switches with standard options.
For information on specific and custom switches, consult Customer Service Center.

Build-A-Switch

To order, simply select desired option from each category and place in the appropriate box. Available options are shown and described on page E-17. For additional options not shown in catalog, consult our Customer Service Center.

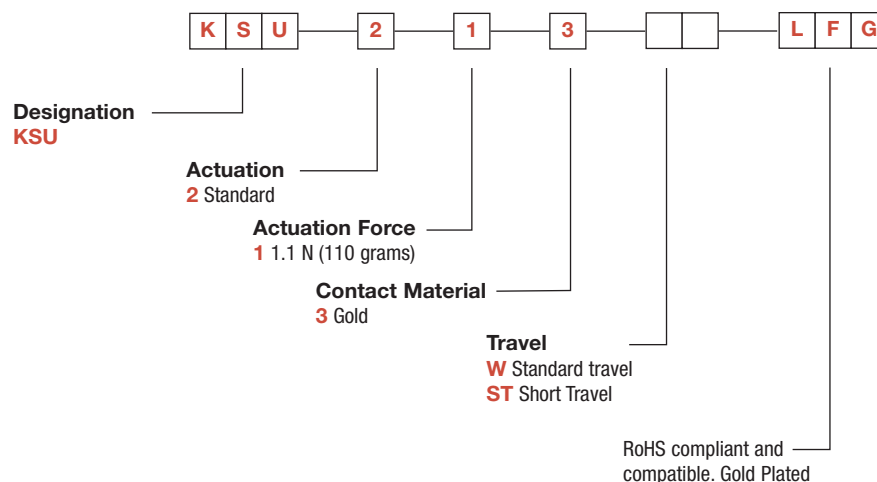

KSU Series

Micro Mini Surface Mount Detect Switches

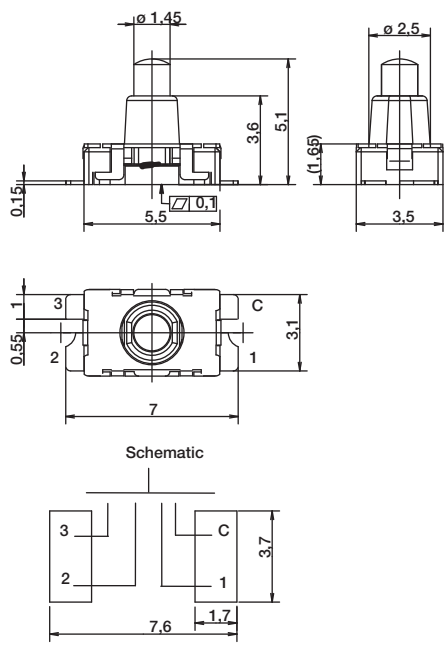

TAPE & REEL



Detect



Dimensions are shown: mm
Specifications and dimensions subject to change

Mouser Electronics

Authorized Distributor

Click to View Pricing, Inventory, Delivery & Lifecycle Information:

C&K Components:

[KSU213 ST LFG](#) [KSU213WLFG](#)