

REVISION F

DO NOT
SCALE FROM
THIS PRINT

NOTES:

1. ⌀ REPRESENTS A CRITICAL DIMENSION.
2. BURR ALLOWANCE: .0015[.038] MAX.
3. LATCH RETENTION FORCE: 1.000LB[4.45N]
4. POSITIONS 2 THRU 5 TO BE BULK PACKAGED, ALL OTHER POSITIONS TO BE TUBED

FIG 1
(IPBD-08-D-M SHOWN)

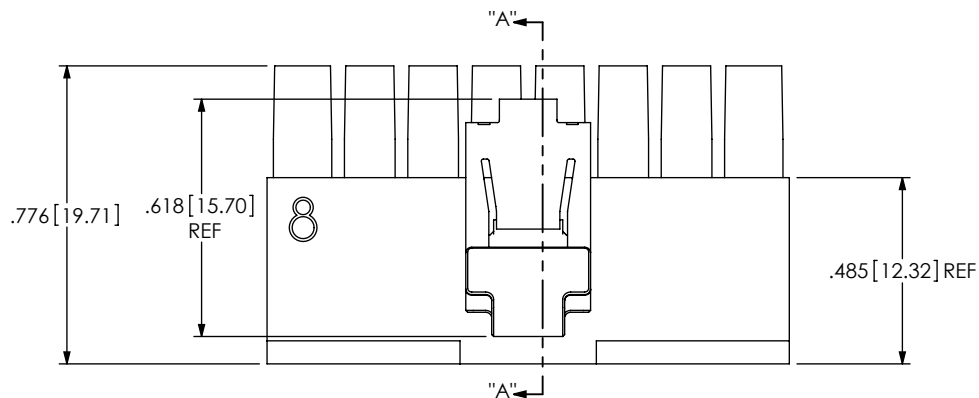

IPBD-XX-D-X-M

No OF POSITIONS
-02 THRU -15 (PER ROW)

METAL RETENTION LATCH
-M: METAL LATCH (USE LTC-14-01-N)

OPTION
*K: KEYED POLARIZATION
(SEE FIG 3)

ROW SPECIFICATION
-D: DOUBLE

*(LEAVE BLANK FOR NO POLARIZATION.
SAMTEC WILL ONLY SUPPORT EXISTING
BUSINESS AS OF REV C)

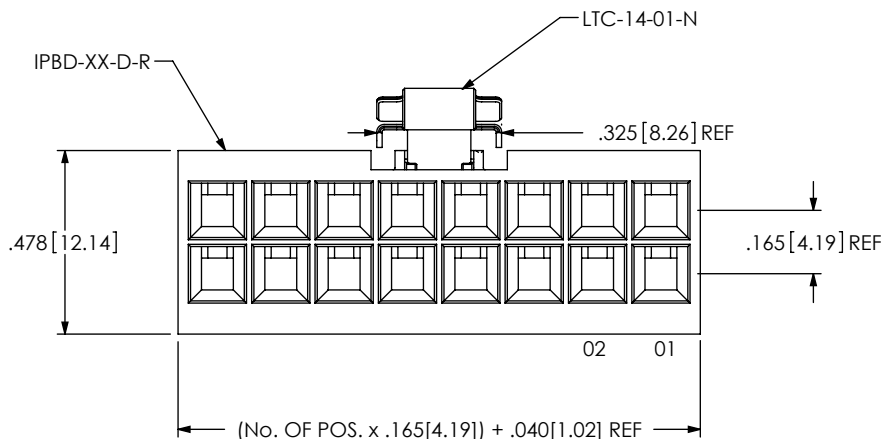
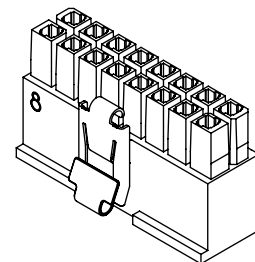
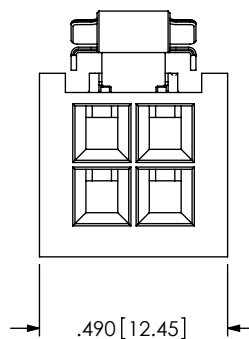
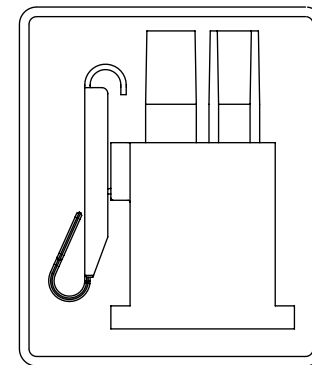

FIG 2
(IPBD-02-D-M SHOWN)
(SAME AS FIG.1 DIFFERENT
AS SHOWN)



PACKAGING VIEW
(SEE NOTE 4)



TUBE: PT-1-24-03-56
PLUG: TP-04

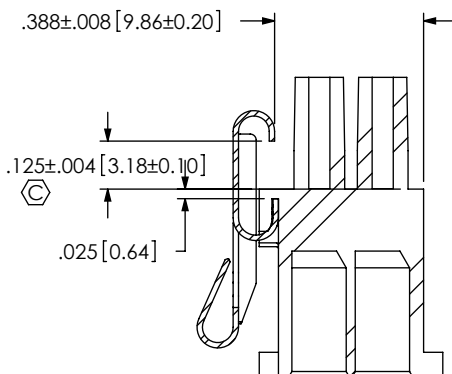

SECTION "A"-"A"

FIG 3
(IPBD-05-D-K-M SHOWN)
(SAME AS FIG.1 DIFFERENT AS SHOWN)

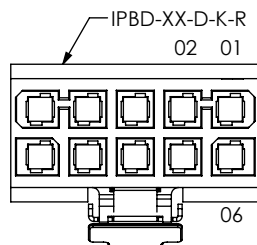

UNLESS OTHERWISE SPECIFIED,
DIMENSIONS ARE IN INCHES.
TOLERANCES ARE:
DECIMALS ANGLES
.XX: $\pm .01$ [.3] 2°
.XXX: $\pm .005$ [.13]
.XXXX: $\pm .0020$ [.051]

PROPRIETARY NOTE

THIS DOCUMENT CONTAINS INFORMATION
CONFIDENTIAL AND PROPRIETARY TO
SAMTEC, INC. AND SHALL NOT BE REPRODUCED
OR TRANSFERRED TO OTHER DOCUMENTS OR
DISCLOSED TO OTHERS OR USED FOR ANY
PURPOSE OTHER THAN THAT WHICH IT WAS
OBTAINED WITHOUT THE EXPRESSED WRITTEN
CONSENT OF SAMTEC, INC.

MATERIAL: DO NOT SCALE DRAWING SHEET SCALE: 2:1
INSULATOR: NYLON 6/6
LATCH: NICKEL-PLATED BeCu, #25, 1/2HT

DESCRIPTION:
.165[4.19] DISCRETE WIRE INSULATOR & LATCH ASM

DWG. NO. IPBD-XX-D-X-M

BY: T NEWTON 03/20/2008 SHEET 1 OF 1

samtec

520 PARK EAST BLVD, NEW ALBANY, IN 47150
PHONE: 812-944-6733 FAX: 812-948-5047
fromparent+e-Mail: info@SAMTEC.com

code: 55322