

DESCRIPTION: MALE - CRIMP AND LOAD

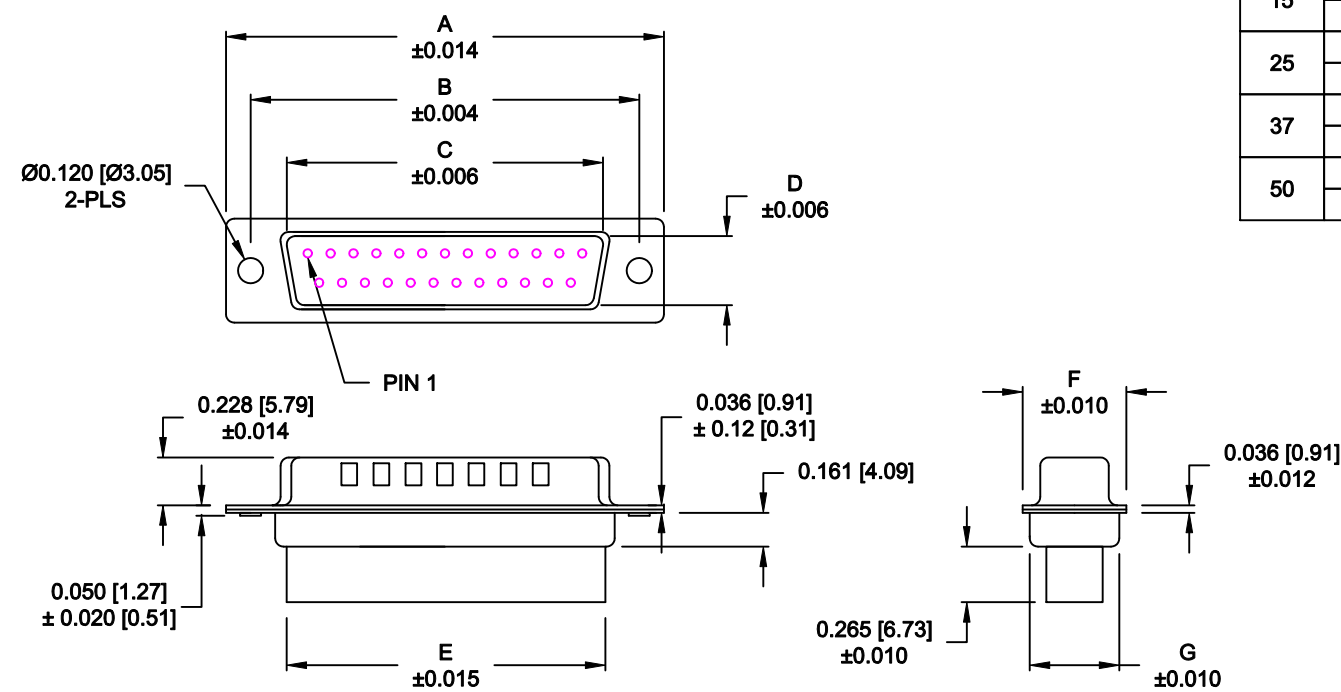

MATERIAL:

SHELL: STEEL, TIN OR NICKEL PLATED
INSULATOR: UL 94V-O RATED, PBT
+30% FIBER-GLASS

ELECTRICAL:

CURRENT RATING: 5 AMPS
CONTACT RESISTANCE: 15 mOhms Max.
INSULATION RESISTANCE: 1,000 MOhms min.
VOLTAGE: 500VAC FOR 1 MINUTE
TEMPERATURE: -50° C TO 125° C

RoHS COMPLIANT

No. OF PINS	DIMENSIONS						
	A	B	C	D	E	F	G
9	1.213	0.984	0.669	0.331	0.618	0.496	0.429
	30.80	24.99	17.00	8.40	15.70	12.60	10.90
15	1.541	1.312	0.996	0.331	0.933	0.496	0.429
	39.15	33.32	25.30	8.40	23.70	12.60	10.90
25	2.088	1.852	1.535	0.331	1.496	0.496	0.429
	53.04	47.04	39.00	8.40	38.00	12.60	10.90
37	2.729	2.500	2.181	0.331	2.142	0.496	0.429
	69.32	63.50	55.40	8.40	54.40	12.60	10.90
50	2.635	2.406	2.079	0.437	2.039	0.602	0.535
	66.93	61.11	52.80	11.10	51.80	15.30	13.60

170-YYY-17YL000

SERIES _____
POSITIONS _____
009
015
025
037
050
GENDER _____
1 = MALE
TERMINATION _____
7 = CRIMP & LOAD
SHELL PLATING _____
2 = TIN
3 = NICKEL (GROUND INDENTS)
RoHS COMPLIANT _____
HARDWARE OPTIONS _____
00 = NO HARDWARE
01 = .098" CLINCH NUT (BOARD SIDE)
02 = .236" CLINCH NUT (BOARD SIDE)
03 = .236" CLINCH NUT (MATING SIDE)
PLATING OPTIONS _____
0 = NO CONTACTS

DO NOT SCALE FROM DRAWING

	THESE DRAWINGS AND SPECIFICATIONS ARE THE PROPERTY OF NorComp AND SHALL NOT BE REPRODUCED, COPIED OR USED AS THE BASIS FOR THE MANUFACTURE OF SALE OF APPARATUS WITHOUT WRITTEN PERMISSION.	DRAWN: PAM JENKINS	DATE: 8-18-98	
	NorComp	CHECKED:	DATE:	
SCALE: 1 : 1		SHEET 1 OF 2	REV 9	
DWG NO. 170-YYY-17YL000				

TOLERANCE:
ALL DIMENSIONS ARE ±0.010

ALL CLINCH-NUTS ARE 4-40 INTERNAL THREADS

01X 0.065" (BOARD SIDE) - CN1

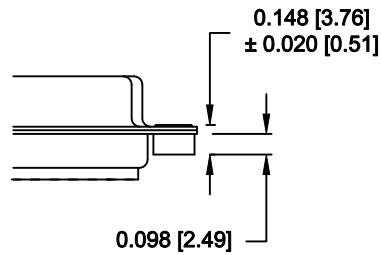

02X 0.236" (BOARD SIDE) - CN2

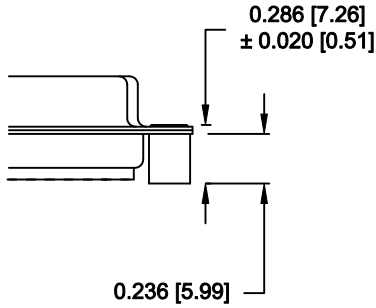

03X..... 0.236" (MATING SIDE) - CN8

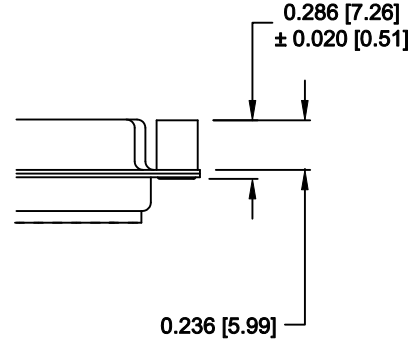

DO NOT SCALE FROM DRAWING



THESE DRAWINGS AND SPECIFICATIONS ARE THE PROPERTY OF NorComp AND SHALL NOT BE REPRODUCED, COPIED OR USED AS THE BASIS FOR THE MANUFACTURE OF SALE OF APPARATUS WITHOUT WRITTEN PERMISSION.

DRAWN:
C. SMITH

DATE:
03-08-06

CHECKED:

DATE:

SCALE:
FULL

SHEET **2** OF **2**

REV
9

DWG NO. **170-YYY-17YL000**

RoHS COMPLIANT

NorComp