

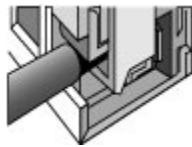

Product Number: 992-DS/12
Screw Connectors for Printed Circuit Boards

TYPE 992 (-DS)
5 mm spacing - 2 to 28 poles



Elevator Style Clamping:



RoHS WEEE Pb free surface compliant

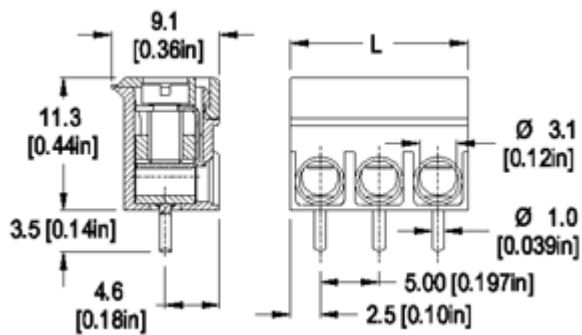

Dimensions: mm (in.)

Length of Connector (L)
L = No. of Poles x Center to Center Spacing

When locating connector, allow 0.5 mm clearance around it for process-induced variations.

Description

- Wire entrance parallel to PC Board
- Elevator-style clamping mechanism

Technical Data

Center to Center Spacing: 5 mm (0.197 in.)

Nominal Cross Section: 1.5 mm² (2325 mils²)

Wire Stripping Length: 6 mm (0.25 in.)

Recommended Hole Diameter in PC Board: 1.3 mm (0.051 in.)

Material

Molding: Polyamide, UL 94, V-2, color black

Temperature limits:

Short Time: 140 °C (284 °F)

Continuous: RTI 105 °C (221 °F)

Low Limit: -40 °C (-40 °F)

Comparative Tracking Index: CTI≥600V

Oxygen Index Rating: 25%

Terminal Body: Tin plated copper alloy

Wire Protector: Stainless steel strip

Screw: M3, Slotted head, zinc plated blue passivated, steel substrate

Solder Pin: Ø 1.0 mm (0.04 in.), Tin plated copper alloy