



Designers' Choice

MICRO PINS

- Precision engineered and manufactured
- Space saving design for high density packaging
- Micro pins are available in .017 to .080 diameters
- Ideal for mating with our standard line of micro jacks
- Available for press-fit, swage or solder mounting
- Sizes for .032, .062, .093 and .125 thick PC boards
- Custom micro pins manufactured to your specifications
- Other platings available upon request



SPECIFICATIONS

Material: Brass, ASTM-B16

Plating: Gold: .000010 per MIL-G-45204, Type II

Tin: .000200 to .000300 per MIL-T-10727, Type 1

.017 Pin - SWAGE MOUNT

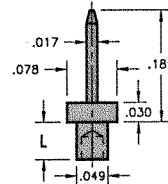

GOLD PLATED CAT. NO.	TIN PLATED "L" Bd CAT. NO.	Lgth.	Thk.
1967-1	1968-1	.051	.032
1967-2	1968-2	.082	.062
1967-3	1968-3	.113	.093
1967-4	1968-4	.145	.125

Mounting Hole
.052 Dia.

.018 Pin - PRESS-FIT

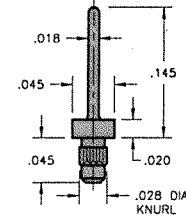

GOLD PLATED CAT. NO.	TIN PLATED CAT. NO.
1986-1	1987-1

Mounting Hole
.026 Dia.

.018 Pin - PRESS-FIT

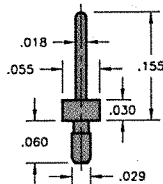

GOLD PLATED CAT. NO.	TIN PLATED CAT. NO.
1988-2	1989-2

Mounting Hole
.026 Dia.

.018 Pin - PRESS-FIT

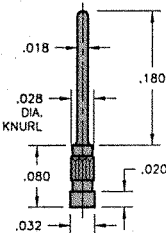

GOLD PLATED CAT. NO.	TIN PLATED CAT. NO.	MATERIAL
1990-2	1991-2	Phos. Bronze

Mounting Hole
.026 Dia.

.018 Pin - PRESS-FIT

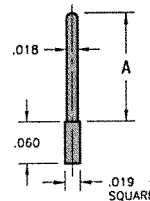

GOLD PLATED CAT. NO.	TIN PLATED "A" Dim. CAT. NO.
1992-2	1994-2
1993-2	1995-2

Mounting Hole
.022 Dia.

.020 Pin - PRESS-FIT

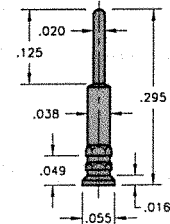

GOLD PLATED CAT. NO.	TIN PLATED CAT. NO.
1996-2	1997-2

Mounting Hole
.040 Dia.

.020 Pin - SOLDER MOUNT

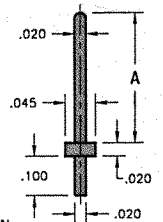

GOLD PLATED CAT. NO.	TIN PLATED "A" Dim. CAT. NO.
1998-3	2000-3
1999-3	2001-3

Mounting Hole
.024 Dia.

.025 Pin - SWAGE MOUNT

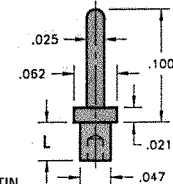

GOLD PLATED CAT. NO.	TIN PLATED "L" Bd CAT. NO.	Lgth.	Thk.
1404-1	1424-1	.051	.032
1404-2	1424-2	.082	.062
1404-3	1424-3	.113	.093
1404-4	1424-4	.145	.125

Mounting Hole
.052 Dia.

.025 Pin - SWAGE MOUNT

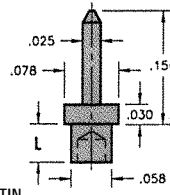

GOLD PLATED CAT. NO.	TIN PLATED "L" Bd CAT. NO.	Lgth.	Thk.
1408-1	1428-1	.062	.032
1408-2	1428-2	.094	.062
1408-3	1428-3	.125	.093
1408-4	1428-4	.156	.125

Mounting Hole
.062 Dia.

.025 Pin - SWAGE MOUNT

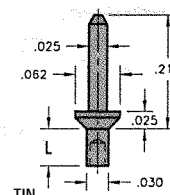

GOLD PLATED CAT. NO.	TIN PLATED "L" Bd CAT. NO.	Lgth.	Thk.
1406-1	1426-1	.047	.032
1406-2	1426-2	.078	.062
1406-3	1426-3	.110	.093
1406-4	1426-4	.141	.125

Mounting Hole
.035 Dia.

.025 Pin - SWAGE MOUNT

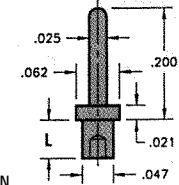

GOLD PLATED CAT. NO.	TIN PLATED "L" Bd CAT. NO.	Lgth.	Thk.
1407-1	1427-1	.051	.032
1407-2	1427-2	.082	.062
1407-3	1427-3	.113	.093
1407-4	1427-4	.145	.125

Mounting Hole
.052 Dia.

.025 Pin - SWAGE MOUNT

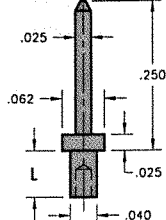

GOLD PLATED CAT. NO.	TIN PLATED "L" Bd CAT. NO.	Lgth.	Thk.
1401-1	1421-1	.065	.032

Mounting Hole
.043 Dia.

.040 Pin - SWAGE MOUNT

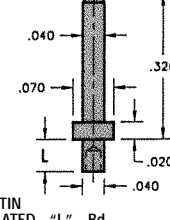

GOLD PLATED CAT. NO.	TIN PLATED "L" Bd CAT. NO.	Lgth.	Thk.
1405-1	1425-1	.051	.032
1405-2	1425-2	.082	.062
1405-3	1425-3	.113	.093

Mounting Hole
.043 Dia.

.040 Pin - SWAGE MOUNT

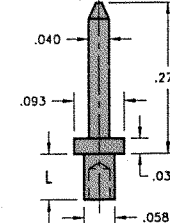

GOLD PLATED CAT. NO.	TIN PLATED "L" Bd CAT. NO.	Lgth.	Thk.
1402-3	1422-3	.125	.093

Mounting Hole
.062 Dia.

.040 Pin - PRESS-FIT

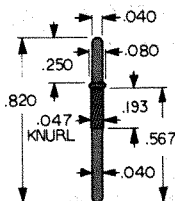

KAY PIN

Press-fit into .043 dia. hole

CAT. NO. 1218 MATERIAL: Solid Nickel Silver

.040 Pin - SWAGE MOUNT

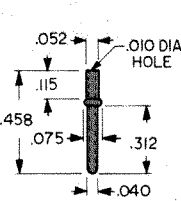

TUBULAR HOLLOW PIN

Stake to .062 board. Mounting hole .059 dia.

CAT. NO. 1219 MATERIAL: Brass, Tin Plate

.080 Pin - SWAGE MOUNT

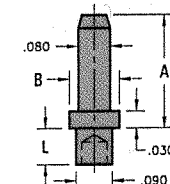

GOLD PLATED CAT. NO.	TIN PLATED "A" "B" "L" Bd CAT. NO.	Dim.	Dim.	Lgth.	Thk.
1447-1	1455-1	.335	.156	.051	.032
1447-2	1455-2	.400	.125	.094	.062
1447-3	1455-3	.400	.125	.125	.093
1447-4	1455-4	.400	.125	.156	.125

Mounting Hole
.094 Dia.

.040 Pins - INSULATED SHORTING PLUG

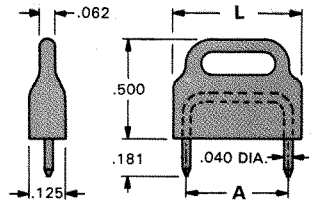

RED CAT. NO.	BLACK CAT. NO.	"A" Dim.	"L" Dim.
1460R	1460B	.200	.375
1461R	1461B	.250	.375
1462R	1462B	.400	.620
1463R	1463B	.500	.620

INSULATOR: Plastic, Red or Black
PINS: Brass, Gold Plate

Mouser Electronics

Authorized Distributor

Click to View Pricing, Inventory, Delivery & Lifecycle Information:

[Keystone Electronics:](#)

[1423-2 \(NON-C/NON-R\)](#)