

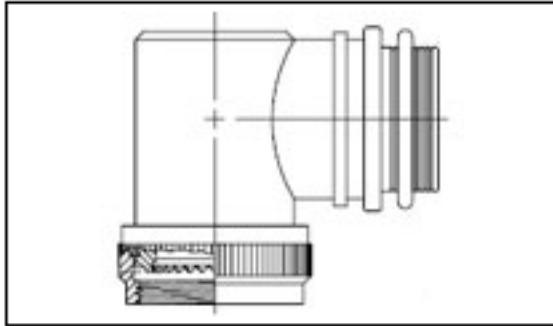

## CB6794-000 Product Details

[Share](#) [Print](#) [Email](#)

**CB6794-000**

TE Internal Number: CB6794-000

 **Active**

### Braid, Fixed, Spin and Tinel Lock Adapters

[Not EU RoHS or ELV Compliant](#)

#### Product Highlights:

- Applies To Cable
- Style = Tinel Lock
- Connector Code = 40
- 90°
- Shell Size = 13, C

[View all Features](#)

#### Quick Links

- ▶ [Check Pricing & Availability](#)
- ▶ [Search for Tooling](#)
- ▶ [Product Feature Selector](#)
- ▶ [Contact Us About This Product](#)

[Add to My Part List](#) [Request Sample](#) [Find Similar Products](#) [Buy Product](#)

### Documentation & Additional Information

#### Product Drawings:

- [Tinel-Lock Adapter](#) (PDF, English)

#### Catalog Pages/Data Sheets:

- None Available

#### Product Specifications:

- None Available

#### Application Specifications:

- None Available

#### Instruction Sheets:

- None Available

#### CAD Files:

- None Available

#### Related Products:

- [Tooling](#)

[List all Documents](#)

### Product Features (Please use the Product Drawing for all design activity)

#### Product Type Features:

- [Style](#) = Tinel Lock
- [Angle](#) = 90°
- [Shell Size](#) = 13, C
- Finish = Cadmium Plating over Electroless Nickel
- Material = Aluminum Alloy
- Color = Olive Drab

#### Electrical Characteristics:

- [Boot Diameter \(mm \[in\]\)](#) = 26.67 [1.050]
- [Entry Diameter \(mm \[in\]\)](#) = 19.10 [0.750]
- Finish Code = B

#### Body Features:

- [Connector Code](#) = 40
- [Entry Size](#) = 12
- [Cable Diameter \(Max.\) \(mm \[in\]\)](#) = 18.54 [0.730]

#### Configuration Features:

- [Braid](#) = Preattached Single 36 AWG Braid
- Material Code = A

#### Industry Standards:

- [RoHS/ELV Compliance](#) = Not ELV/RoHS compliant
- [Lead Free Solder Processes](#) = Not relevant for lead free process

#### Conditions for Usage:

- Applies To = Cable

#### Other:

- Brand = Raychem

### Corporate Information

[Who We Are](#)

[Investors](#)

[News Room](#)

[Supplier Portal](#)

[Careers](#)

### Quick Links

[Check Distributor Inventory](#)

[Cross Reference](#)

[Find Documents & Drawings](#)

[Product Compliance Support Center](#)

[Site Map](#)

### Customer Support

[Email or Chat With Us](#)

[Find a Phone Number](#)

[Search Knowledge Base](#)

[Manage your Account](#)

### Keep Me Informed

Receive TE News, Events & Technology Updates

