

75Ω Snap-on Cable Plugs

Click on connector picture to go directly to cable assembly instructions

Straight Plugs

Straight Female Cable Plug

Clamp type for flexible cable:
2702-1551-0XX (Gold plated)
2702-7551-0XX (Nickel plated)

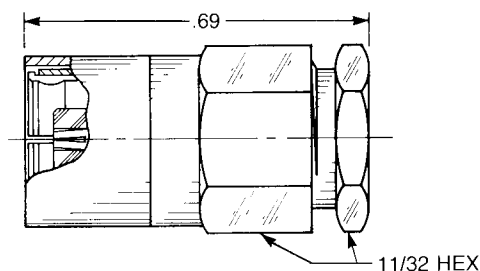

Straight Female Cable Plug

Crimp type for flexible cable:
2702-1571-0XX (Gold plated)
2702-7571-0XX (Nickel plated)

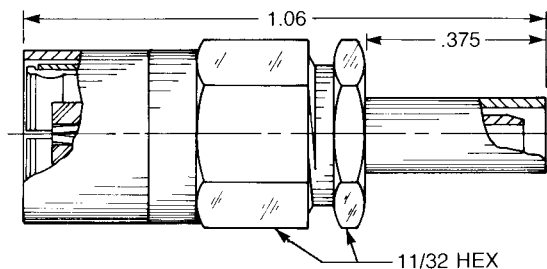

Right Angle Plugs

Right Angle Female Cable Plug

Clamp type for flexible cable:
2705-1551-0XX (Gold plated)
2705-7551-0XX (Nickel plated)

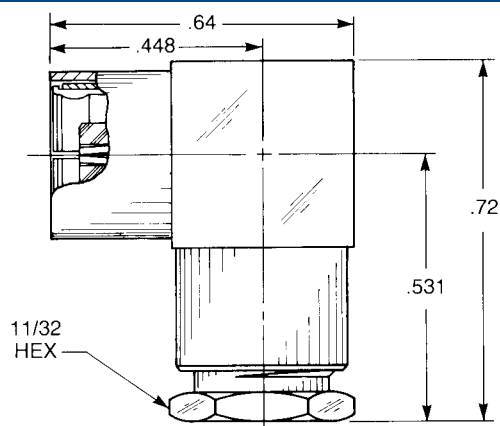

Right Angle Female Cable Plug

Crimp type for flexible cable:
2715-1521-0XX (Gold plated)
2715-7521-0XX (Nickel plated)

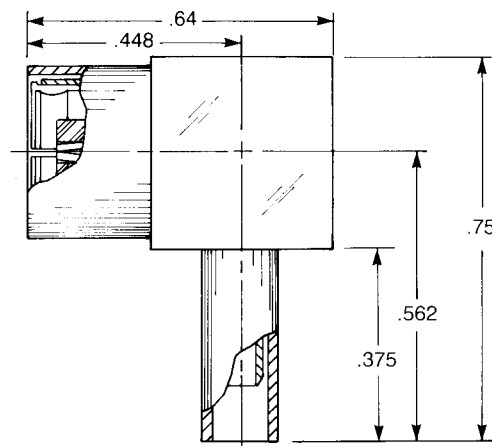

Substitute the appropriate cable group number for "XX" when ordering:

GROUP	CABLE TYPES	GROUP	CABLE TYPES	GROUP	CABLE TYPES
03	RG174, RG179, RG316, M17/113, M17/119, M17/172, M17/189	04	RG180, RG195, M17/95	07	RG59, RG62, M17/29, M17/30



APPLIED ENGINEERING PRODUCTS

(203) 776-2813 • FAX (203) 776-8294

www.aepconnectors.com • aepsales@aepconnectors.com

75Ω Positive-Locking Cable Plugs

Click on connector picture to go directly to cable assembly instructions

Introduction

AEP's positive-locking 75-ohm plugs use a spring-loaded collar that must be retracted before the connector will unmate. The bright nickel finish of the collar allows easy visual verification of their locked status after mating.

AEP positive-locking 75Ω plugs mate with any standard 75Ω snap-on jack. Standard body plating is gold with bright nickel finish on the locking collar, but they can be supplied with nickel-plated bodies as well.

All have captivated contacts.

How They Work

The spring-loaded collar positions dual detents over the outer contact fingers when released, preventing them from spreading. The plugs cannot be unmated unless the collar is fully retracted.

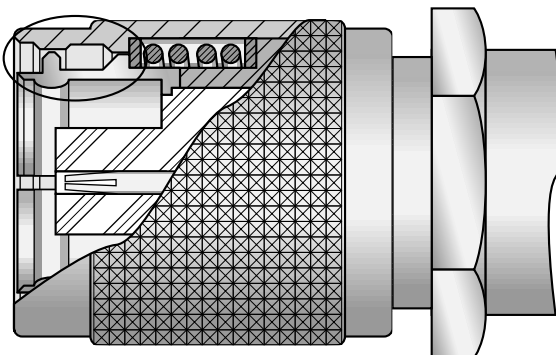

Straight plug

Crimp type for flexible cable

AEP P/N
2802-2571-0XX*

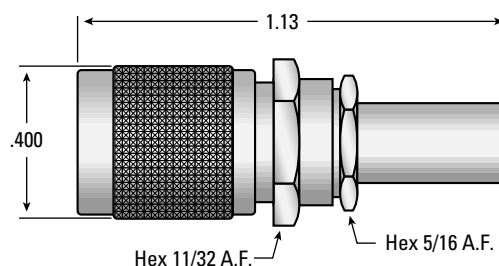

Right angle plug

Crimp type for flexible cable

AEP P/N
2815-2521-0XX*

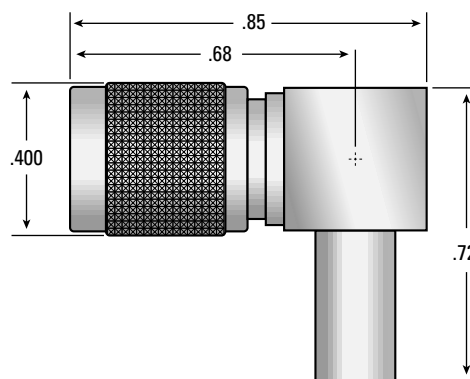

Substitute the appropriate cable group number for "XX" when ordering:

GROUP	CABLE TYPES	GROUP	CABLE TYPES	GROUP	CABLE TYPES
03	RG174, RG179, RG316, M17/113, M17/119, M17/172, M17/189	04	RG180, RG195, M17/95	07	RG59, RG62, M17/29, M17/30



APPLIED ENGINEERING PRODUCTS

(203) 776-2813 • FAX (203) 776-8294

www.aepconnectors.com • aepsales@aepconnectors.com

75Ω Snap-on Cable Jacks

Click on connector picture to go directly to cable assembly instructions

Straight Jacks

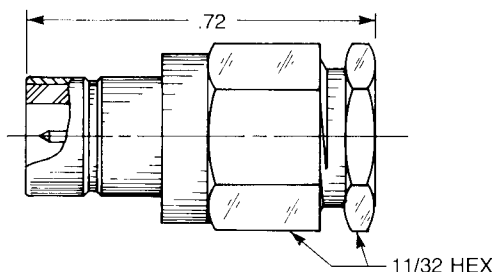

Straight Male Cable Jack

Clamp type for flexible cable:
2701-1551-0XX (Gold plated)
2701-7551-0XX (Nickel plated)

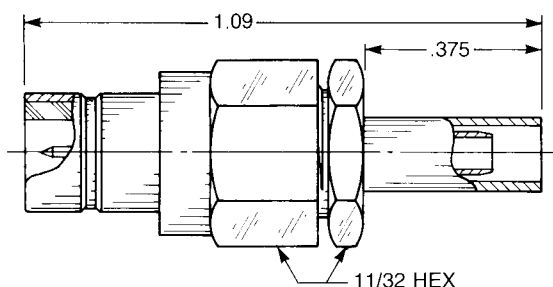

Straight Male Cable Jack

Crimp type for flexible cable:
2701-1571-0XX (Gold plated)
2701-7571-0XX (Nickel plated)

Bulkhead Mounted Jacks

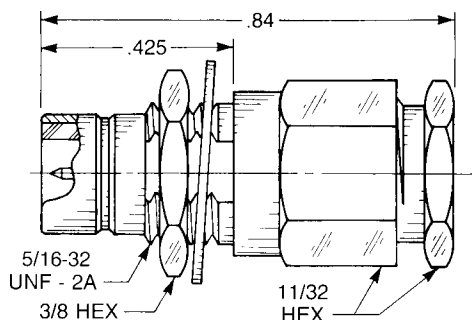

Straight Male Bulkhead Cable Jack

Clamp type for flexible cable:
2703-1551-0XX (Gold plated)
2703-7551-0XX (Nickel plated)

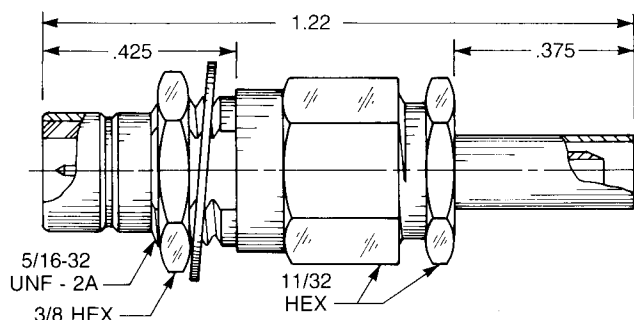

Straight Male Bulkhead Cable Jack

Crimp type for flexible cable:
2703-1571-0XX (Gold plated)
2703-7571-0XX (Nickel plated)

Substitute the appropriate cable group number for "XX" when ordering:

GROUP	CABLE TYPES	GROUP	CABLE TYPES	GROUP	CABLE TYPES
03	RG174, RG179, RG316, M17/113, M17/119, M17/172, M17/189	04	RG180, RG195, M17/95	07	RG59, RG62, M17/29, M17/30



APPLIED ENGINEERING PRODUCTS

(203) 776-2813 • FAX (203) 776-8294

www.aepconnectors.com • aepsales@aepconnectors.com

75Ω Snap-on Bulkhead Receptacles

Rear Mount

Straight Male Bulkhead Jack Receptacle

- Solder pot contact
- Rear mount

2704-1511-000 (Gold plated)

2704-7511-000 (Nickel plated)

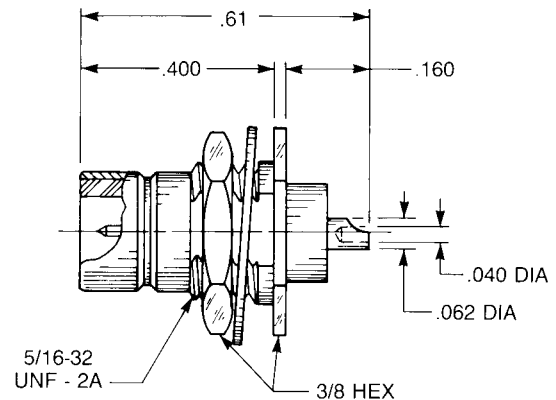

Front Mount

Straight Bulkhead Jack Receptacle

- Solder pot contact
- Front mount

2719-1511-000 (Gold plated)

2719-7511-000 (Nickel plated)

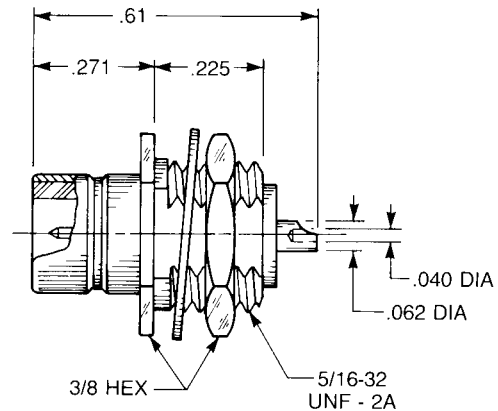

Recessed Mount

Straight Male Bulkhead Jack Receptacle

- Solder pot contact
- Recessed front mount

2776-1511-000 (Gold plated)

2776-7511-000 (Nickel plated)

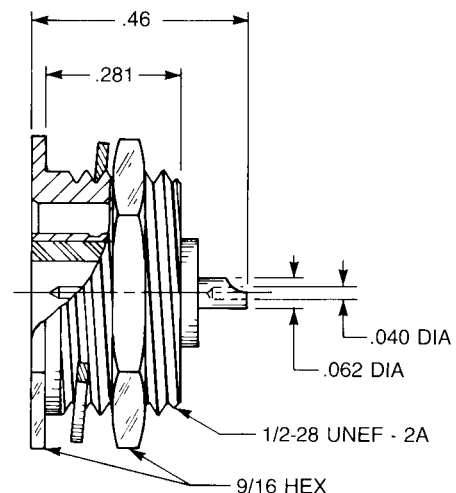

APPLIED ENGINEERING PRODUCTS

(203) 776-2813 • FAX (203) 776-8294

www.aepconnectors.com • aepsales@aepconnectors.com



75Ω Snap-on P.C. Board Receptacles

Straight Jack

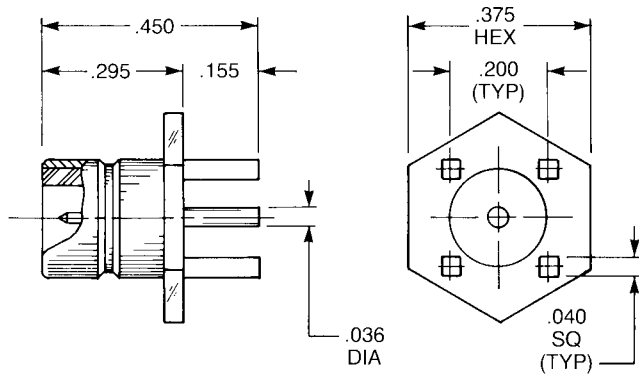

Straight Male Jack P.C. Board Receptacle

2709-1511-001 (Gold plated)
2709-7511-001 (Nickel plated)

Right Angle Jack

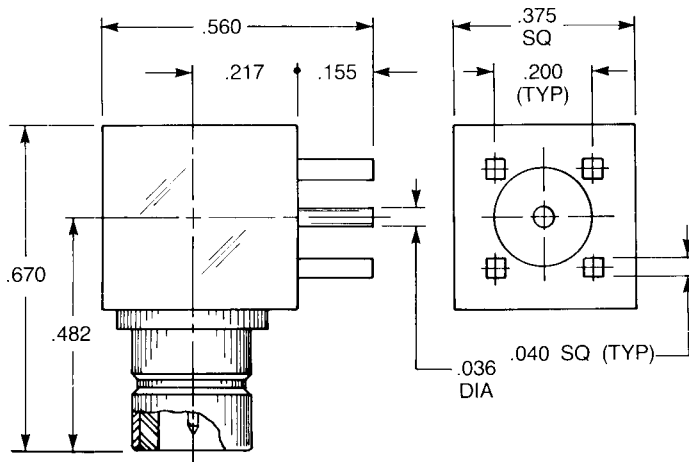

Right Angle Male Jack P.C. Board Receptacle

2710-1511-000 (Gold plated)
2710-7511-000 (Nickel plated)

Straight Plug

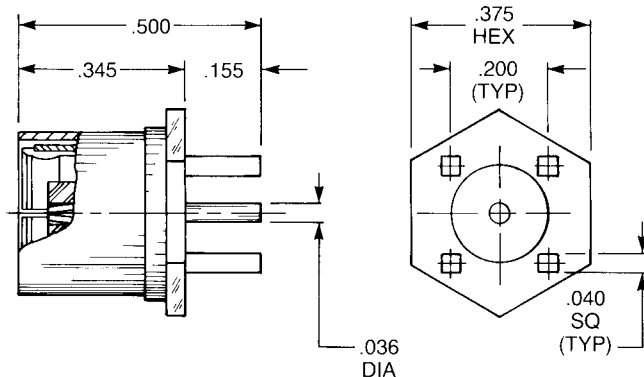

Straight Female Plug P.C. Board Receptacle

2725-1511-000 (Gold plated)
2725-7511-000 (Nickel plated)



APPLIED ENGINEERING PRODUCTS

(203) 776-2813 • FAX (203) 776-8294

www.aepconnectors.com • aepsales@aepconnectors.com



75Ω Snap-on Adapters/Terminations

Straight Bulkhead Mounted Adapter

Bulkhead Mounted Straight Male Jack To Jack Adapter

- Connects two plugs

5732-1501-000 (Gold plated)

5732-7501-000 (Nickel plated)

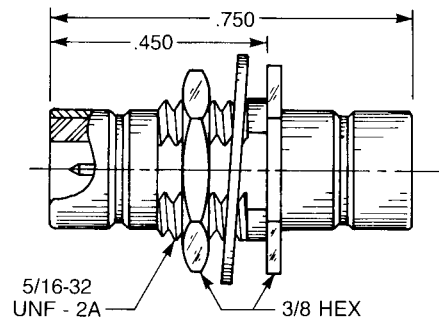

Tee Adapters

Tee Adapter (Unmatched Power Divider) Jack To Plug To Jack

- Connects two plugs and one jack

5725-1501-000 (Gold plated)

5725-7501-000 (Nickel plated)

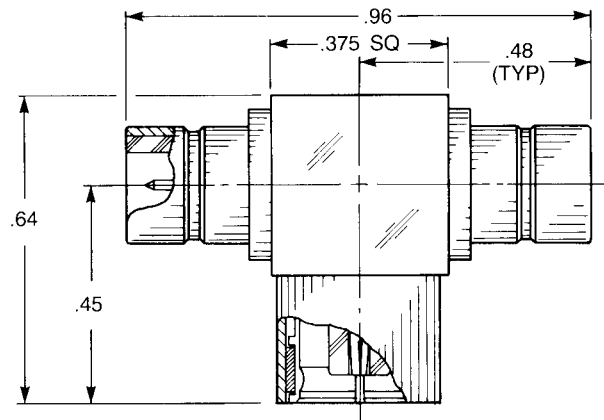

Tee Adapter (Unmatched Power Divider) Jack To Jack To Jack

- Connects three plugs

5727-1501-000 (Gold plated)

5727-7501-000 (Nickel plated)

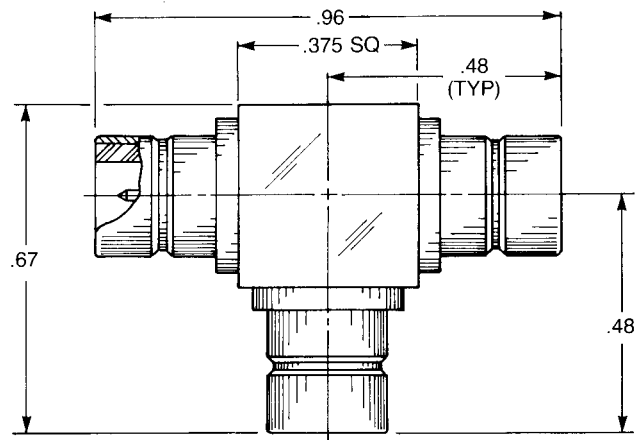

Resistive Termination

Female Plug Resistive Termination

(Dummy load)

Standard resistor: 75 ohm, 1/2 watt, 5% tolerance

2736-1511-075 (Gold plated)

2736-7511-075 (Nickel plated)

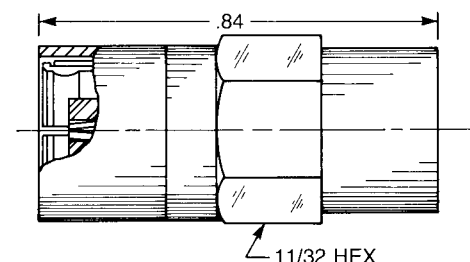

APPLIED ENGINEERING PRODUCTS

(203) 776-2813 • FAX (203) 776-8294

www.aepconnectors.com • aepsales@aepconnectors.com



Cable Assembly Instructions

Clamp type connectors for flexible cable

Straight Connectors—Flexible Cable

Parts list

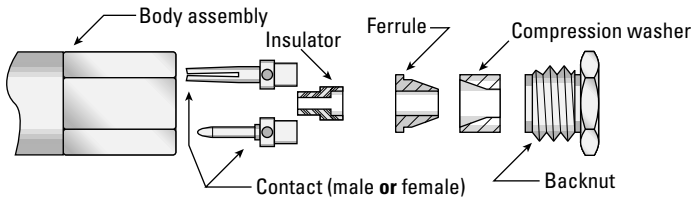

1

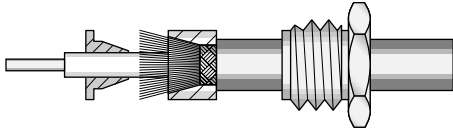

- Trim cable per trim code below; tin end of center conductor.
- Slide backnut onto cable. Slide compression washer onto cable in the orientation shown until it stops against cable jacket.
- Flare cable braid by rotating dielectric and slide ferrule under braid.

2

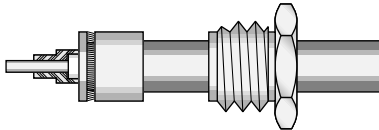

- Press ferrule against compression washer.
- Trim excess braid flush with outer diameter of compression washer and ferrule.
- Assemble insulator over cable center conductor and dielectric.

3

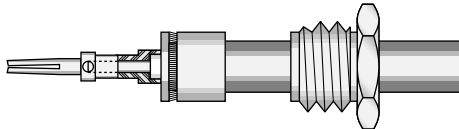

- Assemble contact onto cable center conductor.
- Solder contact to center conductor by heating rear of contact (do not feed additional solder through inspection hole in contact).

4

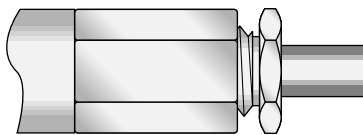

- Insert cable assembly into body assembly. Tighten to 90–100 inch-ounces torque. (Hold cable/hardware assembly stationary and rotate body when tightening.)

Cable Trim Dimensions

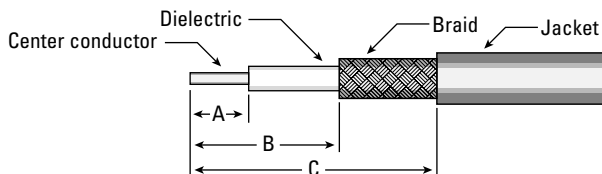

CONNECTOR TYPE	A	B	C
STRAIGHT CONNECTORS	.100	.125	.265
RIGHT ANGLE CONNECTORS	.075	.200	.350

Right Angle Connectors—Flexible Cable

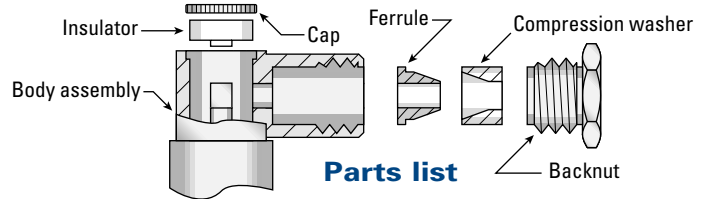

1

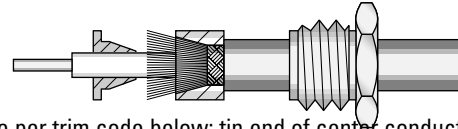

- Trim cable per trim code below; tin end of center conductor.
- Slide backnut onto cable. Slide compression washer onto cable in the orientation shown until it stops against cable jacket.
- Flare cable braid by rotating dielectric and slide ferrule under braid.

2

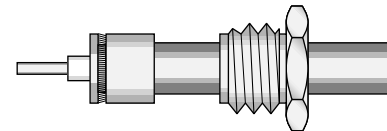

- Press ferrule against compression washer.
- Trim excess braid flush with outer diameter of compression washer and ferrule.
- Assemble insulator over cable center conductor and dielectric.

3

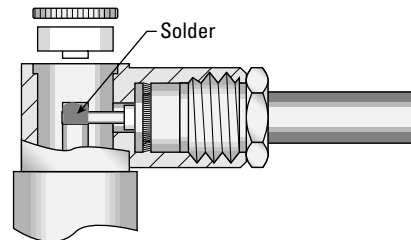

- Insert cable assembly into body assembly. Tighten to 90–100 inch-ounces torque. (Hold cable/hardware assembly stationary and rotate body when tightening.)
- Solder center conductor into notch in rear of contact with .025–.032" diameter chisel-tip soldering iron.
- Solder should cover center conductor, but not extend over top of notch in contact, or exceed contact diameter.

4

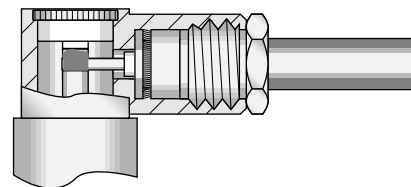

- Place insulator in body cavity, and press cap into place. Properly assembled cap will be slightly below end of body assembly.



APPLIED ENGINEERING PRODUCTS

(203) 776-2813 • FAX (203) 776-8294

www.aepconnectors.com • aepsales@aepconnectors.com



Cable Assembly Instructions

Crimp type connectors for flexible cable

Straight Connectors—Flexible Cable

Parts list

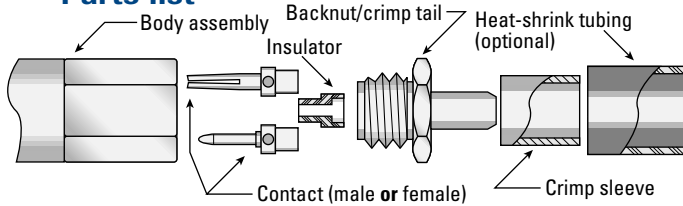

1

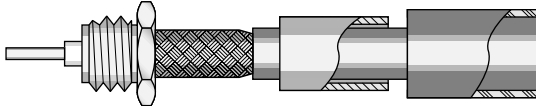

- Trim cable per trim code below; tin end of center conductor.
- Slide heat-shrink tubing and crimp sleeve over cable.
- Flare cable braid by rotating dielectric and slide cable into crimp tail.

2

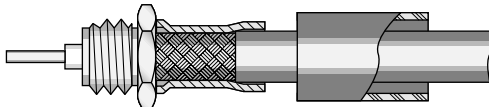

- Position cable so braid touches rear of back nut.
- Slide crimp sleeve forward to touch rear of back nut.
- Crimp braid with appropriate die size from chart below.

3

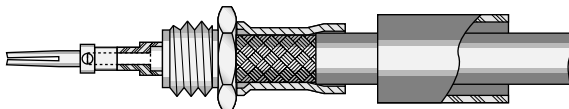

- Assemble insulator and contact onto cable dielectric and center conductor.
- Solder contact to center conductor by heating rear of contact (do not feed additional solder through inspection hole in contact).

4

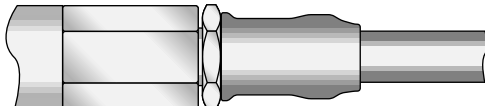

- Insert cable assembly into body assembly. Tighten to 90–100 inch-ounces torque. (Hold cable/hardware assembly stationary and rotate body when tightening.)
- Slide shrink tubing over crimp sleeve and shrink to fit.

Cable Trim Dimensions

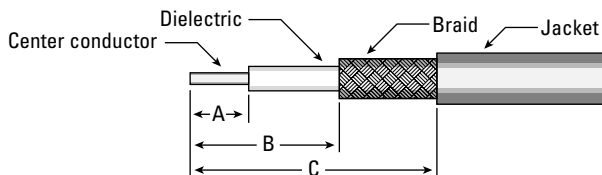

CONNECTOR TYPE	A	B	C
STRAIGHT CONNECTORS	.100	.475	.725
RIGHT ANGLE CONNECTORS	.075	.250	.500

Right Angle Connectors—Flexible Cable

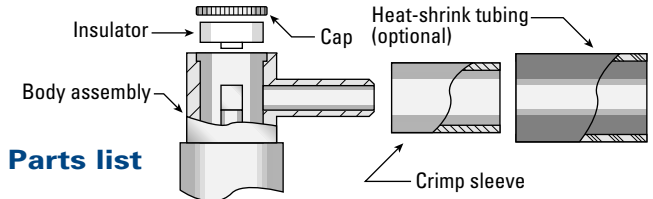

1

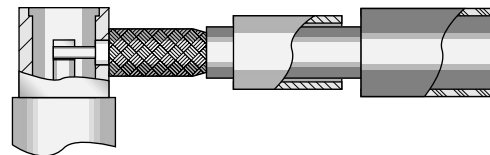

- Trim cable per trim code below; tin end of center conductor.
- Slide heat-shrink tubing and crimp sleeve over cable.
- Flare cable braid by rotating dielectric and slide cable into crimp tail.

2

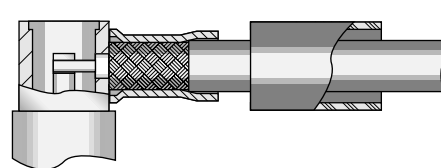

- Position cable so braid touches rear of body assembly.
- Slide crimp sleeve forward to touch rear of body assembly.
- Crimp braid with appropriate die size from chart below.

3

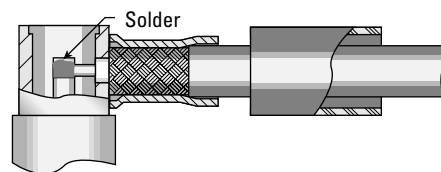

- Solder center conductor into notch in rear of contact with .025–.032" diameter chisel-tip soldering iron.
- Solder should cover center conductor, but not extend over top of notch in contact, or exceed contact diameter.

4

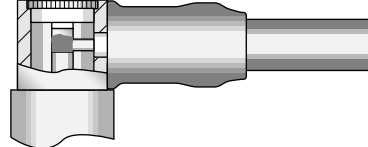

- Place insulator in body cavity, and press cap into place. Properly assembled cap will be slightly below end of body assembly.
- Slide shrink tubing over crimp sleeve and shrink to fit.

Crimp Die Sizes

CABLE GROUP	HEX DIE SIZE
03	.128
04	.156
07	.223



APPLIED ENGINEERING PRODUCTS

(203) 776-2813 • FAX (203) 776-8294

www.aepconnectors.com • aepsales@aepconnectors.com



Mounting Dimensions

Bulkhead Receptacles

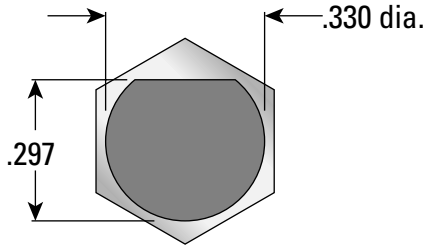

Flat of mounting surface is aligned with body hex as shown.

P.C. Board Receptacles

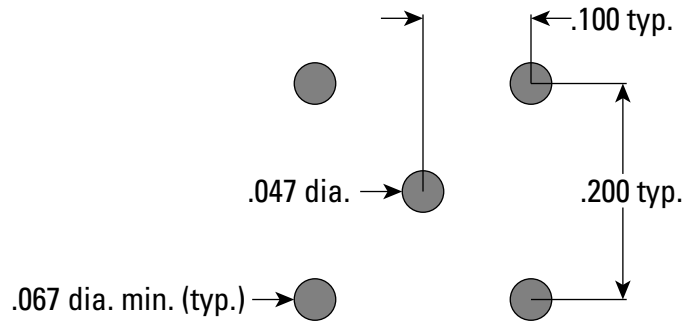

Assembly Tooling

Crimp tool

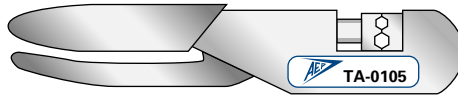

DESCRIPTION	AEP P/N
Crimp tool with .105" and .128" hex dies	TA-0105
Crimp tool with .156" hex die	TA-0071
Crimp tool with .255" hex die	TA-0234



APPLIED ENGINEERING PRODUCTS

(203) 776-2813 • FAX (203) 776-8294

www.aepconnectors.com • aepsales@aepconnectors.com

