

3M™ MicroTouch™ Display C1500SS

The Clear Choice for Optics, Reliability, and Ease of Integration

The 3M MicroTouch Display C1500SS (15"), a robust metal chassis display using 3M's industry-standard surface capacitive touch technology, provides a durable, optically-enhanced, and cost competitive alternative to 5-wire resistive displays used in industrial automation equipment and kiosk enclosures. The C1500SS display offers multiple mounting options to make integration easy and a variety of bezel options for sealing against liquids and other contaminants. A remote on-screen display module helps simplify any changes to the display image during installation or system maintenance.

The Clear Choice

The C1500SS display utilizes an all-glass surface capacitive touch sensor with the proprietary 3M™ ClearTek™ Hard Coat to deliver superior durability, 91.5% light transmission, 225-nit brightness (with touch screen), 500:1 contrast ratio and an ultra-fast 5.4 millisecond touch contact time.

Multiple Mounting and Bezel Options

Multiple mounting and bezel options enable customers to meet their application needs at minimal cost. The C1500SS display offers a 75mm VESA pattern to provide arm mounting capability for industrial automation equipment. This minimizes the capital expenditure needed to upgrade equipment with touch. L-brackets (standard) or a VESA mounting bracket (optional) are available for installations requiring the touch display to be fully enclosed.

The C1500SS display offers three bezel options. The Slimline bezel is flush with the edges of the display and is ideal for arm-mounted applications. The Contour Flanged bezel provides a lip to cover the air gap between the touch display and the enclosure opening. These two plastic bezels are ideal for solutions that require a NEMA 1 seal rating. The Industrial Flanged bezel, a metal gasketed bezel, enables kiosks or others enclosures to support NEMA 4X / IP66 seal ratings.



Cost Effective

The C1500SS display uses an all-glass touch sensor with no moving parts, whereas 5-wire resistive solutions rely on compressing the top film layer against a conductive coating to recognize touch. Since force is required to activate a resistive touch sensor it is susceptible to mechanical wear and the appearance of "Newton Rings" which can potentially reduce product life and optical performance.

The C1500SS touch display operates reliably in the presence of on-screen contaminants and carries a 3-year "unlimited touches" warranty.

Recommended Applications

- | | |
|-------------------------|------------------------------|
| • Industrial Automation | • Security Systems |
| • Self Service | • Point-of-Information (POI) |
| • Hospitality | • Home Automation |

Feature	Benefit
All-Glass, One-Layer Solution	<ul style="list-style-type: none">• Provides 91.5% light transmission as compared to 80% for certain 5-wire resistive solutions• Unaffected by UV light that can cause degradation of optics and yellowing of film-based touch sensors over time• No moving parts improves reliability• Inherently free from the appearance of "Newton Rings"
3M ClearTek Hard Coat	<ul style="list-style-type: none">• Proprietary coating is uniformly heat infused into the glass creating a non-permeable barrier for increased scratch and chemical resistance• Low surface energy coating promotes smooth finger drag• Unaffected by surface contaminants
Total Touch Solution	<ul style="list-style-type: none">• Unlike other touch display manufacturers that utilize 3rd party touch sensors, electronics, and or software in their design, 3M owns, understands, and warranties the entire system for an unlimited amount of touches for 3 years

3M™ MicroTouch™ Display C1500SS Specifications

Functional Features

LCD Technology	TFT, Active Matrix
Display Colors	16.2 million
Pixel Pitch	.297 mm
Brightness without Touch Screen	250 cd/m ² (nit) typical
Brightness with Touch Screen (max.) ¹	225 cd/m ² (nit) typical
Contrast Ratio	500:1 typical
Video Response Time	12 ms typical
Touch Response Time	5.4 ms typical
Viewing Angle ²	Horizontal: +/-75 degrees typical Vertical: +/-75 degrees typical
Control Type	OSD
On Screen Display Controls	Standard rear mounted controls. Optional remote unit.
Maximum Resolution	1024 x 768
Operating Environment	0 to +40 degrees C Relative Humidity, non-condensing 90%
Storage Environment	-20 to +60 degrees C

Physical Features

Physical Dimensions (Enclosure) (WxHxD)	350.4 x 277.3 x 50 mm 13.80 x 10.92 x 1.96 inches
Display Area (WxH)	304.1 x 228.1 mm 11.9 x 8.9 inches
Video Cable Connector	15 Pin D-Sub
Power Supply Internal	12V DC Power Supply Also accepts 110/220V AC
Power Savings	DPMS, VESA Compliant
Power Consumption	<25 watts normal operation
Backlight Life	50,000 hrs. typical
Weight	4.2kg/9.2 lbs.
RoHS Compliant	Yes
Agency Approvals	FCC B, CE, UL/cUL
Mounting Options	Set of 2, side or top/bottom mounting brackets, VESA 75 mm
Warranty	3 years. unlimited touches

(1) Brightness measured on a display with 3M™ MicroTouch™ Sensor SCT3250 surface capacitive sensor.

(2) Measured at a contrast ratio of 5.

NOTE: Mechanical Drawings available at www.3m.com/touch



Slimline Bezel
(Included with standard product)
350.4 x 277.3 mm
13.80 x 10.92 inches



Optional Remote On-screen Display Module
(Part number: 30114)



Contour Flanged Bezel Option
(Part number: 29369)
377.8 x 301.8 mm
14.87 x 11.88 inches



Optional Heavy Duty Mounting Bracket
(Part number: 30113)



Industrial Flanged Bezel Option
(Part number: 29368)
411.0 x 316.9 mm
16.18 x 12.48 inches

Standard Part Numbers

Part Number	Description
11-71315-225-01	USB with Slimline Bezel
11-71315-227-01	Serial with Slimline Bezel
11-71315-225-03	USB with Contour Bezel

3M Touch Systems

Subsidiary of 3M Company
501 Griffin Brook Park Drive
Methuen, MA 01844
U.S.A.

1-888-659-1080

www.3m.com/touch

RoHS Directive compliant: In accordance with European Directive 2002/95/EC, "RoHS Directive compliant" means that the product or part does not contain any of the following substances in excess of the following maximum concentration values in any homogeneous material, unless the substance is in an application that is exempt under RoHS: (a) 0.1% (by weight) for lead, mercury, hexavalent chromium, polybrominated biphenyls or polybrominated diphenyl ethers; or (b) 0.01% (by weight) for cadmium. Unless otherwise stated by 3M in writing, this information represents 3M's knowledge and belief based on information provided by third party suppliers to 3M. (9/06)

IMPORTANT NOTICE TO PURCHASER: Specifications are subject to change without notice. These 3M Touch Systems' Products and software are warranted to meet their published specifications from the date of shipment and for the period stated in the specification. 3M Touch Systems makes no additional warranties, express or implied, including but not limited to any implied warranties of merchantability or fitness for a particular purpose. User is responsible for determining whether the 3M Touch Systems Products and software are fit for User's particular purpose and suitable for its method of production, including intellectual property liability for User's application. If the Product, software or software media is proven not to have met 3M Touch Systems' warranty, then 3M Touch Systems' sole obligation and User's and Purchaser's exclusive remedy, will be, at 3M Touch Systems' option, to repair or replace that Product quantity or software mediator to refund its purchase price. 3M Touch Systems has no obligation under 3M Touch Systems' warranty for any Product, software or software media that has been modified or damaged through misuse, accident, neglect, or subsequent manufacturing operations or assemblies by anyone other than 3M Touch Systems. 3M Touch Systems shall not be liable in any action against it in any way related to the Products or software for any loss or damages, whether non-specified direct, indirect, special, incidental or consequential (including downtime, loss of profits or goodwill) regardless of the legal theory asserted. (7/02)



MicroTouch™ CT150 Touch Monitor – Bezel Options

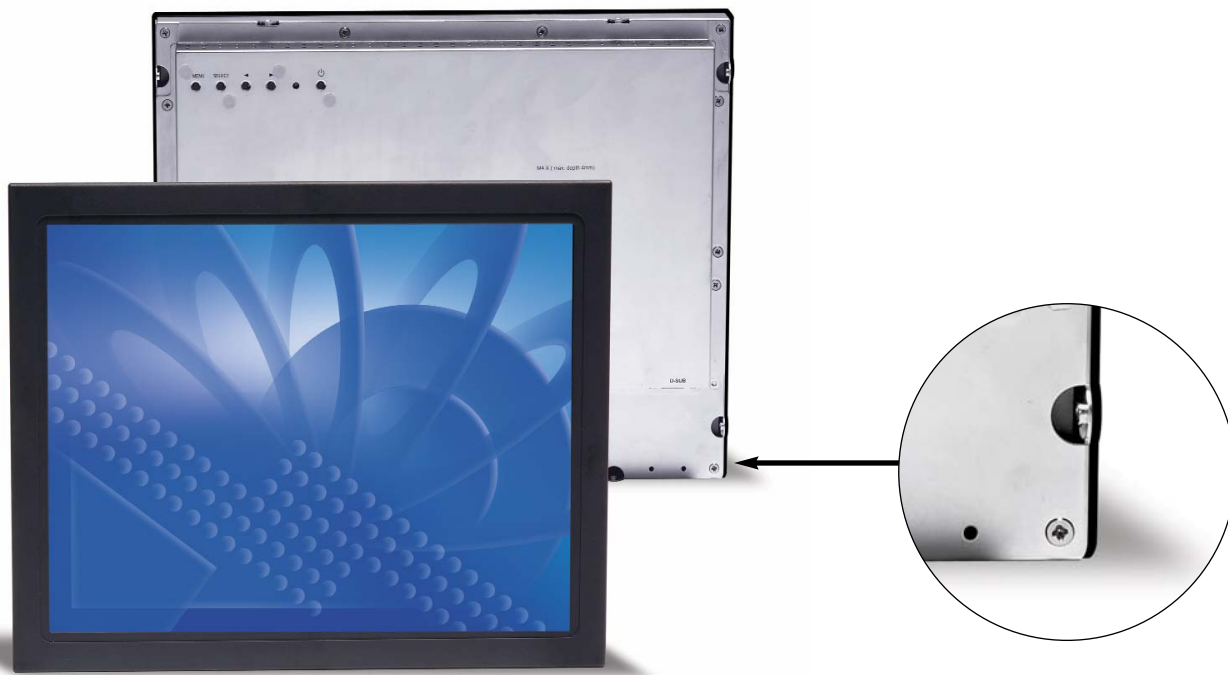

CT150 Touch Monitor with Slimline Bezel (standard)

Standard product includes bezel shown. Bezel is flush to edges of display.
Reinforced bosses on monitor case for bracket mounting. Ideal for rear mount applications.



CT150 Touch Monitor with Contour Flanged Bezel (optional)

This bezel is contoured on the front to resemble a desktop monitor bezel.
Designed for front mount or “drop-in” applications. Bezel only, monitor sold separately. (Part number: 29369)

MicroTouch™ CT150 Touch Monitor – Bezel Options



CT150 Touch Monitor with Industrial Flanged Bezel (optional)

Rugged, gasketed bezel with wide flange and multiple attachment points to both the display and the enclosure.
Bezel only, monitor sold separately. (Part number: 29368)



Top Mount Configuration



Side Mount Configuration



Standard Steel Mounting Brackets
(standard with CT150 Touch Monitor)

MicroTouch™ CT150 Touch Monitor Mounting Bracket

Heavy-duty VESA Mounting Bracket

(Part number: 30113, shown below with CT150 and Contour Flanged bezel)

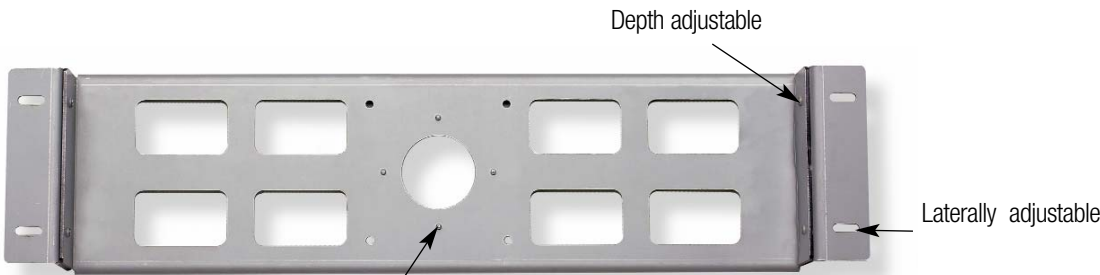

Four bracket alignment pins engage corresponding indents in monitor case to ensure proper installation.

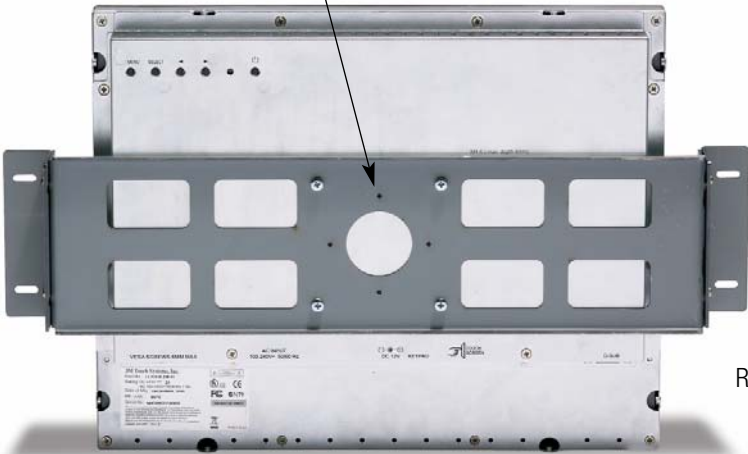

MicroTouch™ CT150 Touch Monitor Arm Mounting Option



Arm Mounting Option

75mm VESA-compliant mounting pattern attaches to an array of ergonomic arms, mounts and bases...an ideal configuration for any application where installation flexibility is required.

Mounting arm (courtesy of Ergotron) and cable management tubing shown here are not available from 3M.

MicroTouch™ CT150 Touch Monitor Mounting Options

**Slimline Bezel
Mounting Method**
(with standard brackets)

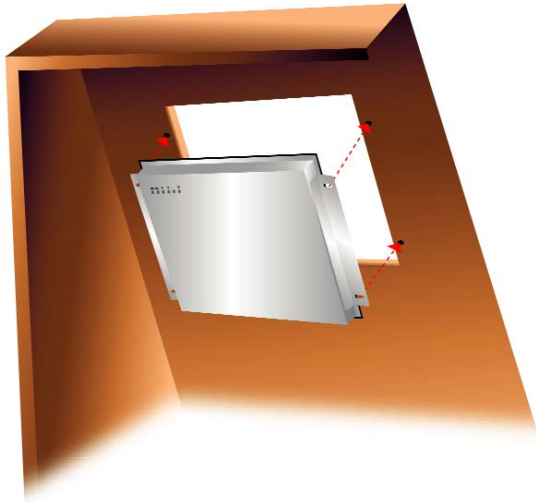

**Contour Flanged Bezel
Mounting Method**
(with standard brackets)

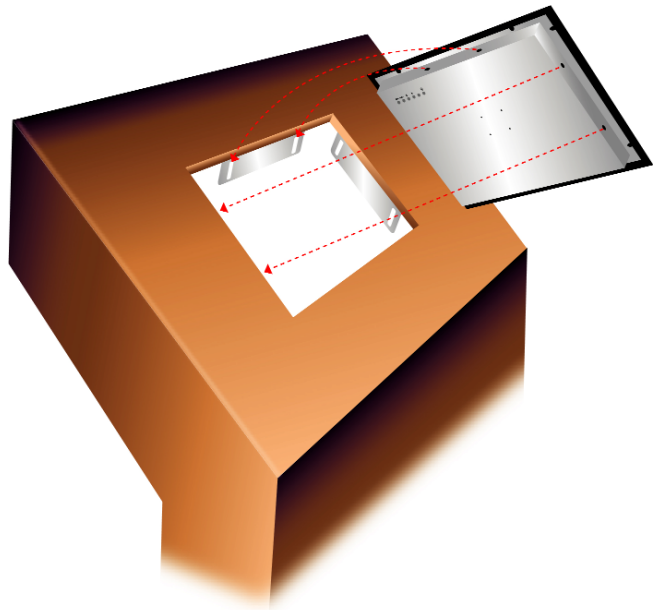

**Contour Flanged Bezel
Mounting Method**
(with optional VESA-mounting bracket)

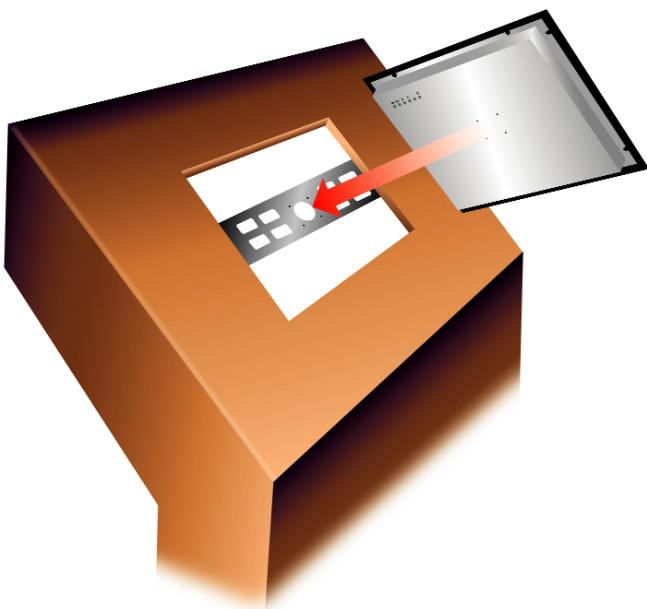

**Industrial Flanged Bezel
Mounting Method**
(no brackets required)

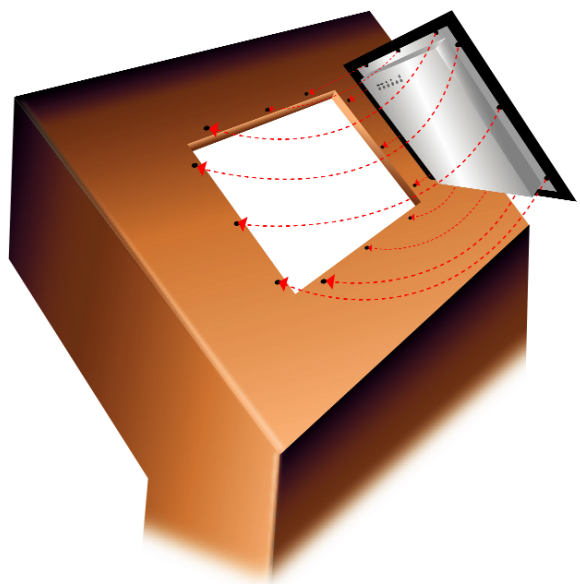

MicroTouch™ CT150 Touch Monitor Connectors/Controls

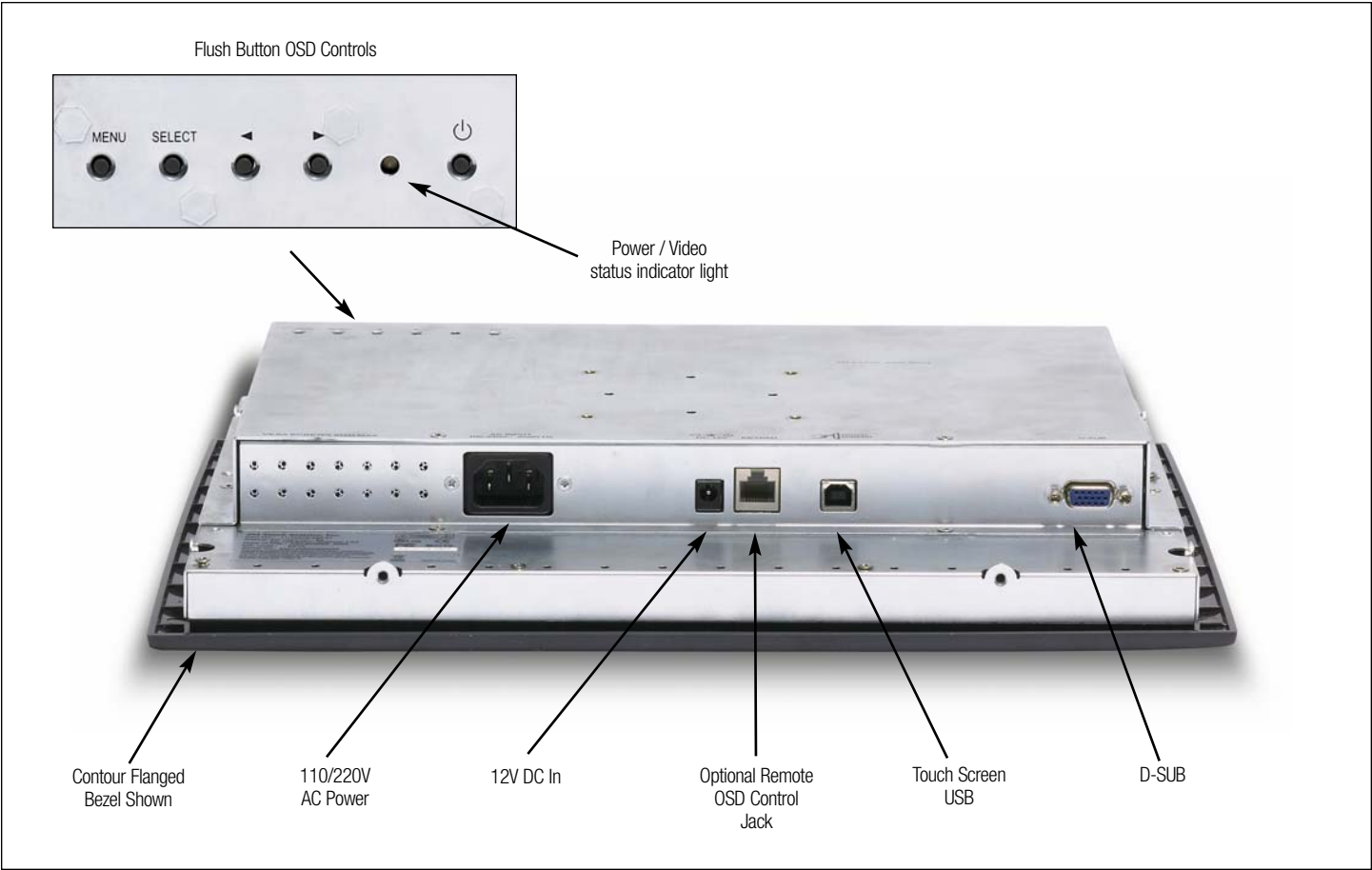

CT150 Touch Monitor Remote OSD Control

Simplifies video adjustment of installed monitors. (Part Number: 30114)



MicroTouch™ ClearTek™ II Capacitive Touch Screen Technology



MicroTouch™ ClearTek™ II Capacitive Touch Screen Technology
(mounted to LCD display)

