

This document is the property of Amphenol Corporation and is delivered on the express condition that it is not to be disclosed, reproduced or used, in whole or in part, for manufacture or sale by anyone other than Amphenol Corporation without its prior consent, & that no right is granted to disclose or to use any information in this document.

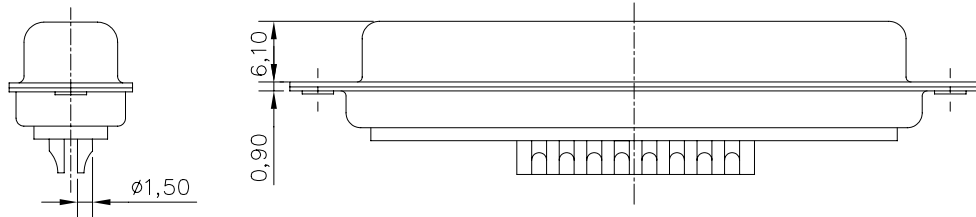
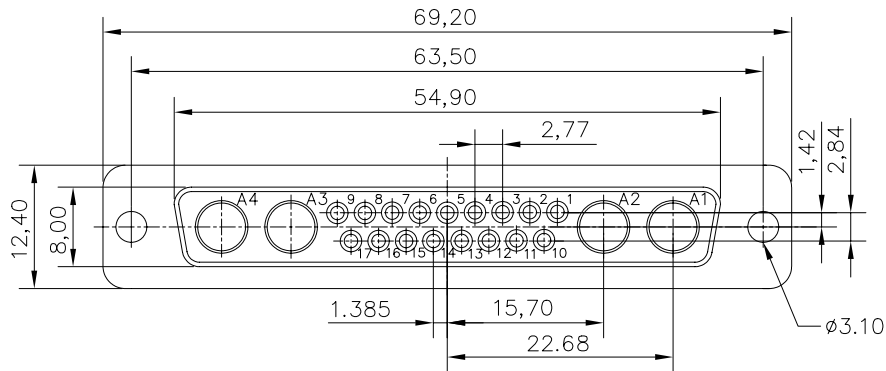

Customer drawing

REVISIONS				
SYM	ECN	DESCRIPTION	DATE	APPROVED
1			11/26/07	

### D-SUB TECHNICAL DATA

SHELL : Steel 2.5um(100u") min tin over 1.25um(50u") min nickel  
BODY: Glass filled thermoplastic.  
Flame retardant to UL94 V-0 Color Black  
CONTACTS : Body:Brass,100u" min tin over 50u" min nickel  
Starclip:BeCu,15u" gold over 50u" nickel  
ELECTRICAL : Voltage rating 300 V RMS at 50 Hz  
Current rating 7.5A  
Withstanding Voltage >1000 V RMS at 50 Hz for one minute  
Insulation resistance >5000 M Ohms  
CLAMATIC: Contact resistance 20 mOhms max.  
Temperature range -55 °C up to 155°C  
Damp heat 56 days(40 °C-95% HR)  
MARKING: Amphenol...(Series No.)  
Commercial reference  
Manufacturing date

### PRODUCT CODE

L 77TW C 21WA4 S

L: RoHS Compliance

77TW: Tin plated shell

Shell Size :C

Contact type:  
S:Female  
P: Male

Configuration: 21WA4

UNLESS OTHERWISE SPECIFIED TOLERANCES		APPROVAL	DATE	Amphenol®	
.X +/- .XX +/- .XXX +/- FRACTIONS +/- ANGLES +/-	U.S.	DRAWN Sunny Li	11/26/07		
	METRIC	CHECKED tik.wang	11/26/07		
		CHECKED			
				TITLE	
FOR MATERIALS AND FINISHES SEE NOTES		DRAWING FILE :		Hybrid connector, TW series	
REMOVE SHARP EDGES		ANGLE OF PROJECTION		SIZE DRAWING NO.	
DIMENSIONS				REV.	
U.S.	INCHES			A4 C L77TWC21WA4S 1	
METRIC	MM			SCALE NONE SHEET 1 OF 1	

# Mouser Electronics

Authorized Distributor

Click to View Pricing, Inventory, Delivery & Lifecycle Information:

[Amphenol:](#)

[L77TWC21WA4S](#)