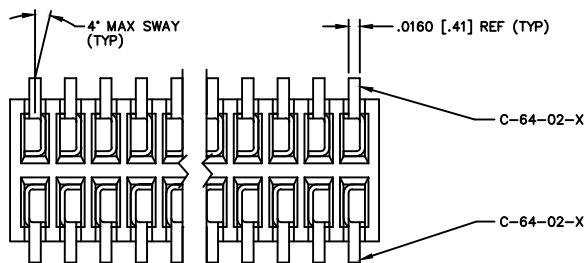
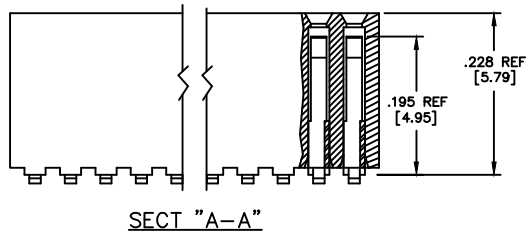
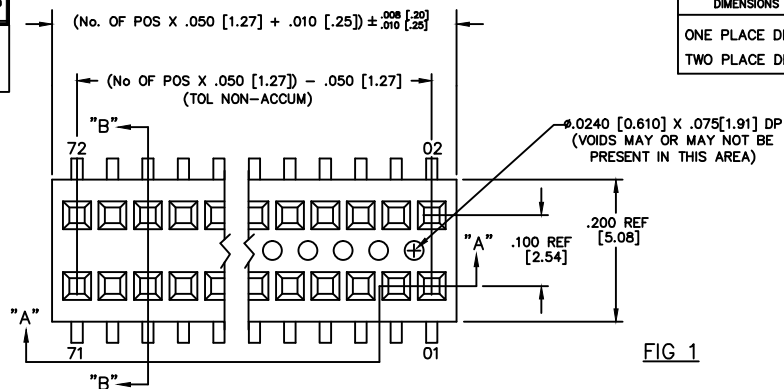

REVISION AS

DO NOT SCALE
FROM THIS PRINT

UNLESS OTHERWISE NOTED

DIMENSIONS ARE IN INCHES

TOLERANCES ARE:

ONE PLACE DECIMALS: $\pm .1$ THREE PLACE DECIMALS: $\pm .005$ TWO PLACE DECIMALS: $\pm .01$ FOUR PLACE DECIMALS: $\pm .0020$

ANGLES

 $\pm 5^\circ$

TITLE:

RECEPTACLE
SURFACE MOUNT
(DOUBLE ROW)

DWG NO:

RSM-1XX-XX-XXX-D-XX
SHEET 1 OF 2

RSM-1XX-XX-XXX-D-XX

BODY LENGTH SPECIFICATION
-02 THRU -40 POSITIONS

LEAD STYLE
-02: C-64-02-X

PLATING SPECIFICATIONS

- S: 30μ" SELECTIVE GOLD IN CONTACT AREA
MATTE TIN ON TAIL
- F: 3 FLASH SELECTIVE GOLD IN CONTACT AREA
MATTE TIN ON TAIL
- L: 10μ" LIGHT SELECTIVE GOLD IN CONTACT AREA
MATTE TIN ON TAIL
- T: MATTE TIN CONTACT AND TAIL
- STL: 30μ" SELECTIVE GOLD IN CONTACT AREA
TIN/LEAD (90%/10 +/−5%) TAIL
- H: 30μ" HEAVY GOLD IN CONTACT AREA
3 ON TAIL
- TM: MATTE TIN CONTACT AND TAIL
- SM: 30μ" SELECTIVE GOLD IN CONTACT AREA
MATTE TIN ON TAIL
- LM: 10μ" LIGHT SELECTIVE GOLD IN CONTACT AREA
MATTE TIN ON TAIL
- FM: 3μ" FLASH SELECTIVE GOLD IN CONTACT AREA
MATTE TIN ON TAIL

OPTIONS

- LC: LOCKING CLIP
(USE LC-05-TM)(SEE FIG 2, SHT 2)(SEE NOTE 4)
- P: PICK AND PLACE PAD
(AVAILABLE ON POS. 5 THRU 40 ONLY)
(USE LMP-02)(SEE FIG 3, SHT 2)
- K: POLYAMIDE FILM PAD
(AVAILABLE ON POS. 5 THRU 40 ONLY)
(.005 [.13] THICKNESS WITH SILICONE
ADHESIVE)(SEE FIG 4, SHT 2)
(USE K-500-300)
- TR: TAPE & REEL

BODY SPECIFICATION

- D: DOUBLE ROW
(USE RSM-XX-D)

CRITICAL DIMENSION INSPECTION TABLE

ASSEMBLY OPERATION	IN-PROCESS INSPECTION
BREAK CARRIER	C1
ROTARY CUT	C2

NOTE:

1. CONTACTS CAN BE INTERLEAVED

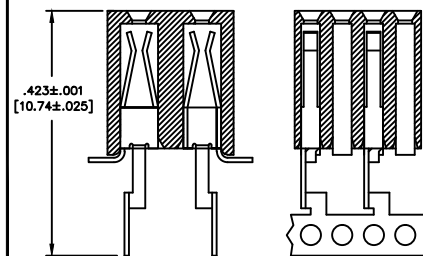

1. WILL LOSE A POSITION FOR EVERY CUT
MADE ON A SOCKET STRIP;
CUT FLASH TO BE .010 [.25] MAX WITH
NO FLASH ALLOWED IN HOLES OR
EXTENDING BELOW LEADS.
2. Ⓢ REPRESENTS A CRITICAL DIMENSION.
3. MINIMUM RETENTION FORCE: 1.0 LB.
4. DUE TO THE HIGH AMOUNT OF INSERTION FORCE
NEEDED, THE -LC OPTION IS NOT COMPATIBLE WITH
AUTO PLACEMENT. SAMTEC RECOMMENDS MANUAL
PLACEMENT FOR ALL ASSEMBLIES WITH THE -LC OPTION.
5. INSULATOR MATERIAL: LCP, UL 94 VO

PACKAGING

NOTES:

1. 1st POSITION TO BE LOADED IN TUBE IN
THE DIRECTION OF THE ARROW.
2. LAYER PACKAGE POSITIONS 2-4, TUBE
PACKAGE POSITIONS 5-36
3. ENDWALLS TO BE .020±.003"

TABLE 1

OPTION	TUBE	PLUG
-K, -LC, -K-LC	PT-1-24-04-64	TP-03
NONE, -P, -P-LC	PT-1-24-05-38	TP-09

samtec

EXISPROD\ASSEMBLY\050
RSM-DASM

520 PARK EAST BLVD. NEW ALBANY, INDIANA 47150
PHONE (812) 944-6733 P.O. BOX 1147
CODE 55322

MADE BY:

GREG REIDINGER 11-24-92

RSM-1XX-XX-XXX-D-XX
SHEET 1 OF 2

PROPRIETARY NOTE

THIS DOCUMENT CONTAINS INFORMATION
CONFIDENTIAL AND PROPRIETARY TO
SAMTEC INC. AND SHALL NOT BE
REPRODUCED OR TRANSFERRED TO
OTHER DOCUMENTS OR DISCLOSED TO
OTHERS OR USED FOR ANY PURPOSE
OTHER THAN THAT FOR WHICH IT WAS
OBTAINED WITHOUT THE EXPRESSED
WRITTEN CONSENT OF SAMTEC INC.

PT-1-24-05-38

PT-1-24-04-64