

Customer Information Sheet

DRAWING No.: S13-503

SHEET 2 OF 2

IF IN DOUBT - ASK

©

NOT TO SCALE

THIRD ANGLE PROJECTION

ALL DIMENSIONS IN mm

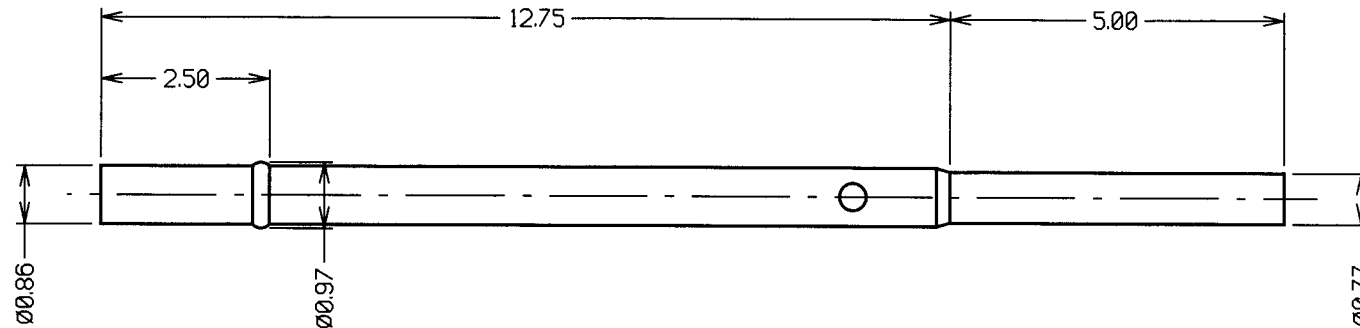

NOTES:

1. TO BE USED WITH PROBES P13-XX23.
2. SUITABLE FOR A MINIMUM DISTANCE BETWEEN CENTRES OF 1.27mm.
3. SPECIFICATIONS FOR PROBE PERFORMANCE ARE GIVEN ON THE PROBE DRAWING.
4. RECOMMENDED HOLE SIZE = Ø0.95mm.

2 07.03.01 5730

ISS. DATE C/NOTE

APPROVED: *[Signature]*

CHECKED: *[Signature]*

DRAWN: W. J. BOURNE

CUSTOMER REF.:

ASSEMBLY DRG.:

HARWIN

HARWIN INC
U.S.A.
TEL: (812) 285 0055
FAX: (812) 285 0056

HARWIN PLC
U.K.
TEL: 023 9237 0451
FAX: 023 9231 4590

HARWIN PTE
SINGAPORE
TEL: 65 7794909
FAX: 65 7793868

THIS DRAWING AND ANY
INFORMATION OR DESCRIPTIVE
MATTER SET OUT HEREON ARE
CONFIDENTIAL AND COPYRIGHT
PROPERTY OF THE HARWIN
GROUP AND MUST NOT BE
DISCLOSED, LOANED, COPIED
OR USED FOR MANUFACTURING,
TENDERING OR FOR ANY
OTHER PURPOSE WITHOUT
THEIR WRITTEN PERMISSION.

TOLERANCES

X - ± 1 mm
X.X - ± 0.25 mm
X.XX - ± 0.10 mm
X.XXX - ± 0.01 mm
ANGLES - $\pm 1^\circ$
UNLESS STATED

MATERIAL:

PHOSPHOR BRONZE

FINISH: GOLD

S/AREA: mm²

TITLE:

1.27mm MIN. CENTRE TWO-PIECE
SPRING PROBE SLEEVE

DRAWING NUMBER:

S13-503

SHT
2
OF
2

Mouser Electronics

Authorized Distributor

Click to View Pricing, Inventory, Delivery & Lifecycle Information:

Harwin:

S13-503