

PRODUCT NUMBER  
SEE TABLE

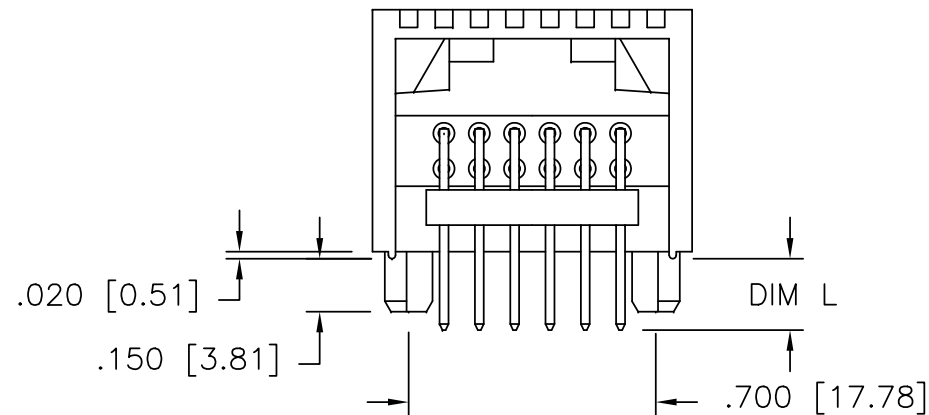
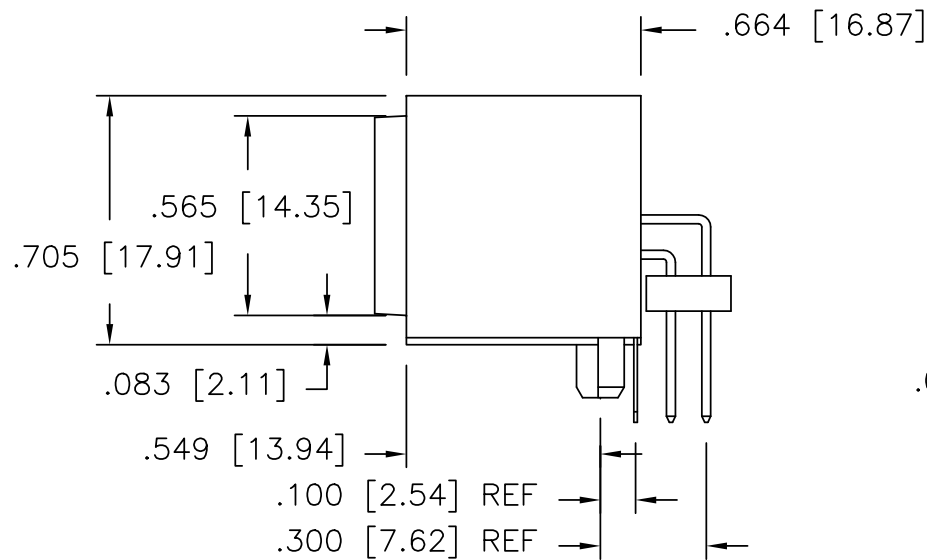
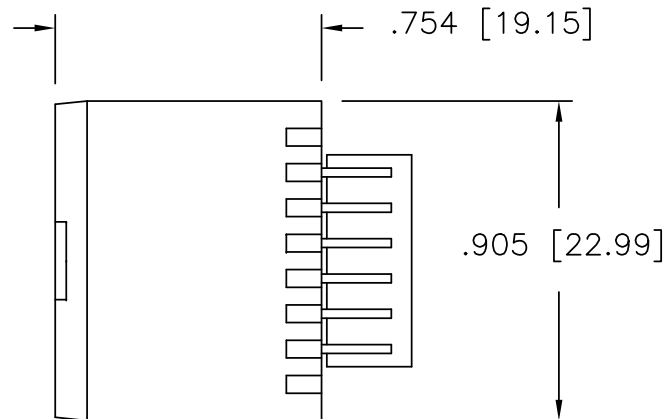

mat'l. code				surface		tolerance		projection		product family			
				ISO 1302 ✓		ISO 406 ISO 1101				LATCH-N-LOK			
ltr	ecn	nodr	date	tolerances unless otherwise specified:						title			
K	ELX-N-008443	ZK	11/28/11	angles	linea	XXX±.01/0.XXX±0.3 XXX±.005/0.XXX±0.13 XXXX±.0020/0.XXX±0.05		INCH/MM		2X6 LNL RT ANGLE HEADER ASSEMBLY			
E	V10425	TFG	2/9/01	0°±2°			scale 1:1						
F	M05-0033	ERE	2/25/05	dr	S. RAMP	1/25/90				dwg no		sheet 1 of 2	size
G	M05-0052	MHT	3/16/05	enr	D. HORCHLER	1/25/90				69693		A3	
H	M06-0365	AGS	9/20/06	chr	D. HORCHLER	8/13/90							
J	M07-0508	MHT	11/28/07	app	D. HORCHLER	8/13/90							
sheet		revision		K						type Product Customer Drawing			
index		sheet		1	2								

69693-XXXLF

LEAD FREE OPTION ⑥ ⑦

COLOR ④	
1	70343-LT GRAY OBS
2	80166-OFF WHITE
3	70634-DK GRAY OBS
4	701-BLACK
5	70511-SLATE GRAY OBS
7	70455-SILVER GRAY
8	80189-PEARL WHITE OBS
9	70419-PEBBLE GRAY

PLATING ③	
0	30u" MIN OVER 50u"MIN Ni
3	30u" MIN OVER 50u"MIN Ni
5	50u" MIN OVER 50u"MIN Ni

PIN LENGTH	
DIM L	
0	.200/5.08
1	.130/3.30

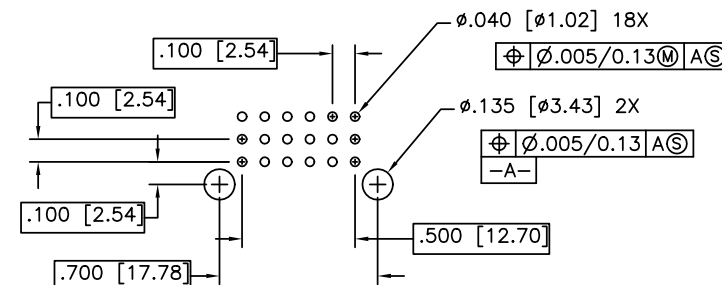

## RECOMMENDED PCB LAYOUT

## NOTES:

- HEADER SHROUD  
MAT'L: HIGH TEMPERATURE THERMOPLASTIC.  
UL-94V-0 RATED.
- GROUND CONTACT  
MAT'L: COPPER ALLOY  
PLATING: 100-160u"/2.54-4.06u TIN.
- SIGNAL CONTACT  
MAT'L: COPPER ALLOY  
PLATING OPTION: PERFORMANCE PLATING WILL BE EITHER GOLD OR GXT  
ON CONTACT AREA OR TAIL, OPTIONALLY (78-295u") TIN ON TAIL.
- NUMBERS SHOWN ARE FOR G.E. LEXAN AND  
ARE FOR REFERENCE ONLY.
- THIS ASSEMBLY U.L. APPROVED PER  
FILE E66906 VOL. 1, SEC. 84 AND  
CSA APPROVED PER MASTER FILE LR 46923.
- ADD LF SUFFIX AT THE END OF PART NUMBER FOR LEAD FREE OPTION.
- THE HOUSING WILL WITHSTAND EXPOSURE TO 260°C PEAK TEMPERATURE  
FOR 15 SECONDS IN A WAVE SOLDER APPLICATION WITH A 1.5mm  
MINIMUM THICK CIRCUIT BOARD. SEE APPLICATION NOTES/PROCEDURES  
IF THEY ARE AVAILABLE.
- THIS PRODUCT MEETS EUROPEAN UNION DIRECTIVES AND OTHER  
COUNTRY REGULATION AS DESCRIBED IN GS-22-008.
- PRODUCT SPEC: GS-12-003

mat'l. code	surface ISO 1302 ✓	tolerance ISO 406 ISO 1101	projection INCH/MM	product family LATCH-N-LOK
ltr ecn nodr date	tolerances unless otherwise specified			title 2X6 LNL RT ANGLE HEADER ASSEMBLY
K	angles 0°±2°	linea XXX±.01/0.X±0.3 XXX±.005/0.XXX±0.13 XXX±.0020/0.XXX±0.05	scale 1:1	dwg no 69693
	dr S. RAMP	1/25/90		sheet 2 of 2 size A3
	engr D. HORCHLER	1/25/90		
	chr D. HORCHLER	8/13/90		
	app D. HORCHLER	8/13/90		
sheet index	revision sheet			type Product Customer Drawing