

Daten & Signal, Socket, 2.5 mm, 2-pole, solder terminal, shielded



### Description

- Solder terminal:  
Screw-on mounting, from rear-side
- Data and Signal transfer
- Data and Signal Connectors 2-pole, shielded, straight
- Reinforced gold plating for increased insertions

### Weblinks

[pdf-datasheet](#), [html-datasheet](#), [General Product Information](#), [RoHS](#), [CHINA-RoHS](#), [REACH](#), [Mating Connectors](#), [e-Shop](#), [SCHURTER-Stock-Check](#), [Distributor-Stock-Check](#)

### Technical Data

Diameter	2.5 mm
Number of Poles	2-pole
Ratings DC	1 A / 12 VDC
Ratings AC	0.65 A / 12 VAC
Dielectric Strength	500 VDC
Insulation Resistance	> 10000 M $\Omega$ @ 500 VDC

Allowable Operation Temp.	-20 °C to 70 °C
Terminal	solder terminal
Mounting	Screw-on mounting wall thickness max. 2.2 mm
Housing	screened
Style	straight
Lifetime	10000 Insertions

### Dimensions

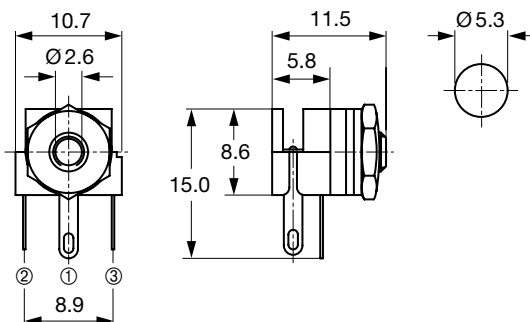

### Diagrams

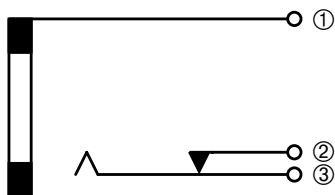

All Variants

Product group	Diameter [mm]	Number of Poles	Terminal	Order Number
Data and Signal Plug/ Sockets	2.5	2-pole	solder terminal	4801.2200

Most Popular.

Availability for all products can be searched real-time:<http://www.schurter.com/en/Stock-Check/Stock-Check-SCHURTER>

Packaging unit 100 Pcs

Mating Inlets/Plugs

Category / Description



[Data and Signal Plug/Socket Overview complete](#)

4801, Plug, solder terminal, screened, 2.5 mm, 2-pole, straight, , UK-Connector	4801.1200
4801, Plug, solder terminal, insulated, 2.5 mm, 2-pole, straight, , UK-Connector	4801.1210

[Data and Signal Plug/Socket further types to 4801 UK-Stecker, D=2,5mm](#)

# Mouser Electronics

Authorized Distributor

Click to View Pricing, Inventory, Delivery & Lifecycle Information:

Schurter:

4801.22