

## Fuse Clips



### Material

Brass (65Cu/35Zn), 0.020 inch thick, full hard temper

### Plating

Bright tin (150 microinch, minimum), over nickel barrier plate

### Solderability

Per Mil-Std-202F, Method 208

### Torque

Minimum 1.0 in.-oz. to twist a fuse in a single clip

### Extraction

Minimum 2 lbs. to extract a fuse from a single clip

### Marking

"bel" die stamped on 1 side

### Ampere Rating

FC-101, -102 -up to 15A. FC-201, -211 -up to 10A

**NOTE** - suitability at higher currents is dependent on fuse type, circuit conditions, AND PC board design (track width/thickness, means to solder clip legs, etc). Each combination of clip, fuse, PC board and operating condition needs to be evaluated

### For 1/4 inch (6.35mm) Diameter Fuses

#### TYPE FC-101

PC Board Mount  
[Ear Stops]

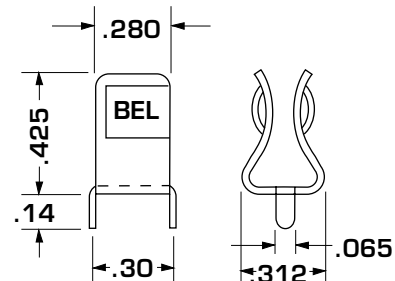

#### TYPE FC-102

PC Board Mount  
[Earless]

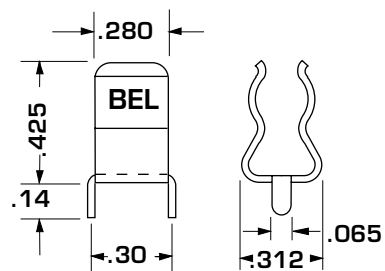

### For 5mm Diameter Fuses

#### TYPE FC-201

5mm Clip  
PC Board Mount  
[Ear Stops]

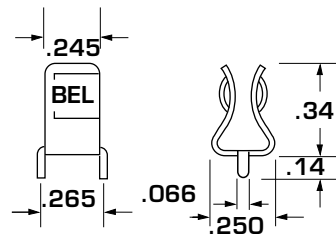

#### TYPE FC211

Locking Type  
PC Board Mount  
[Ear Stops]

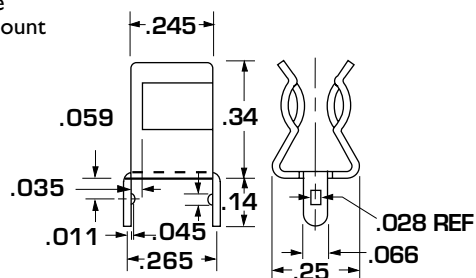

The Type FC-211 Locking Clip is designed for 5 mm diameter fuses, for use in 0.062 inch thick printed circuit boards. The legs have tabs which "lock" into the board and prevent "floating" of the clip during wave solder. This design also allows elimination of the "clinch" operation on the underside of the board.