

THIS DRAWING CONTAINS INFORMATION PROPRIETARY TO POSITRONIC INDUSTRIES INC. AND IS TO BE USED ONLY FOR THE PURPOSES FOR WHICH IT WAS ISSUED. NO PART OF THIS DRAWING IS TO BE REPRODUCED OR TRANSMITTED IN ANY FORM OR BY ANY MEANS, ELECTRONIC OR MECHANICAL, INCLUDING PHOTOCOPYING, RECORDING, OR BY ANY INFORMATION STORAGE AND RETRIEVAL SYSTEM, WITHOUT THE WRITTEN PERMISSION OF POSITRONIC INDUSTRIES INC. THE USER EMPLOYER'S SUCH INFORMATION AT HIS OWN DISCRETION. POSITRONIC INDUSTRIES INC. MAKES NO WARRANTY, REPRESENTATION OR GUARANTEE, AND ASSUMES NO LIABILITY FOR ANY DAMAGES OR LOSSES, INCLUDING CONSEQUENTIAL DAMAGES, OF ANY KIND OR NATURE, ARISING OUT OF OR IN CONNECTION WITH THE USE OF SUCH INFORMATION IN WHOLE OR IN PART.

SK10750

DATE	REV	REVISION RECORD	APP	DR	CK
8-05-09	NC	ECO 31055	RCW	BS	TK

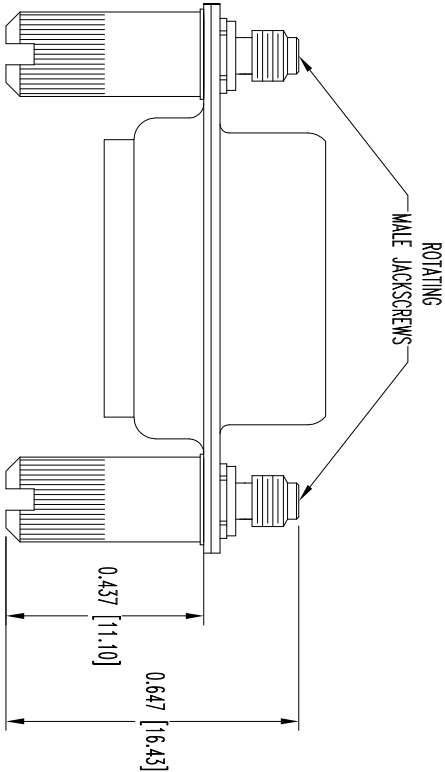
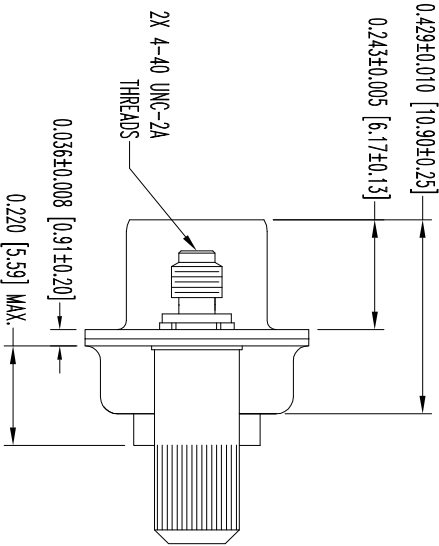
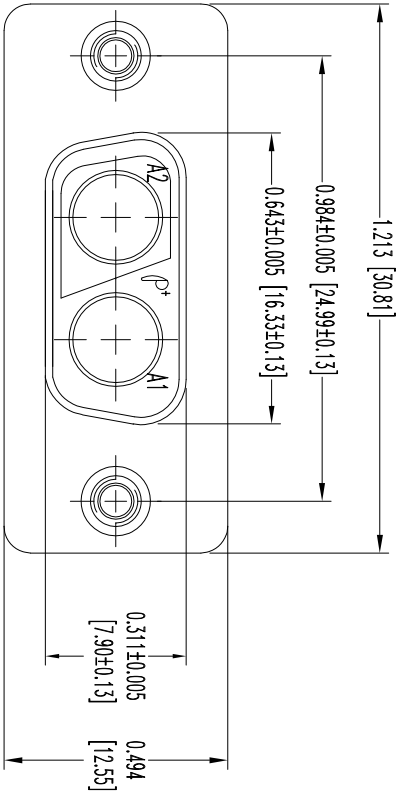

NOTES:

1. MATERIALS AND FINISHES:
INSULATOR: GLASS FILLED POLYESTER PER MIL-M-24519 UL 94V-0, COLOR BLUE.
SHELLS: STEEL, ZINC FINISH WITH CHROMATE SEAL.
JACKSCREWS: STEEL, ZINC PLATE WITH CHROMATE SEAL.
2. ELECTRICAL CHARACTERISTICS:
INSULATOR RESISTANCE: 5 G OHMS.
WORKING VOLTAGE: 300 V r.m.s.
3. TEMPERATURE RANGE: -55°C TO +125°C.
4. DIMENSIONS ARE IN INCHES [MILLIMETERS].



POSITRONIC
INDUSTRIES INC.
www.connectpositronic.com

FSCM 28198

DECIMAL TOL.	SCALE	DRAWN BY	APPROVED BY	REV.
± 0.015 [0.38]	N.T.S.	B SHELLBY	R WILLIAMS	NC
ANGULAR TOL. ± 5°	DATE	DRAWING NUMBER		
	8-05-09	SK10750		