

THA-410 Straight Action Latch
THA-411 Tee Handle Key

PAT.No.2139418
 PAT.No.2503043



■Specification

Model No.	Name	Net Weight(g)	Code No.	
THA-410	Straight Action Latch	266	3625	
THA-411	Tee Handle Key	44	3626	
THA-410・411 Set		310	3607	

■Parts List

No.	Part Name	Material	Finish	Quantity
1	Case	SPCC	Zn	2
2	Arm	ZDC		2
3	Rivet	S		2
4	Key Slot	ZDC		1
5	Key Guide	POM	gray	1
6	Hexagon Bolt	S	Zn	2
7	Cotter Pin	C2700W	—	2
8	Pan Head Screw	S	Zn	1
9	Square Hole Washer	SPCC		1
10	Handle Key	ZDC	Cr	1
11	Key Ring	S	Ni	1

■Characteristic

A detachable grip lock mechanism to operate a rod, which can be used for wide variety of application from large distribution boards to small control boards, is used for the handle device. A compact design in which the area exposed from front side of the door and the extrusion on the surface are made small. Also installed mechanism inside looks smart to use the room effectively. By turning the handle 100-degree, the action latch moves up and down straightly to retract the rods. Further a cam can be set behind the action latch to have 3-points lock mechanism.

■Application

Distribution boards / Control boards / Doors for various types boxes, etc.

■Specification

The handle can be used for both left side and right side. Rotation angle of the key is 100 degree.

■Installation Instruction

Note for Installation.
 The handle can be taken off at locked position only.
 Then the arm should be pressed when installing the key slot.

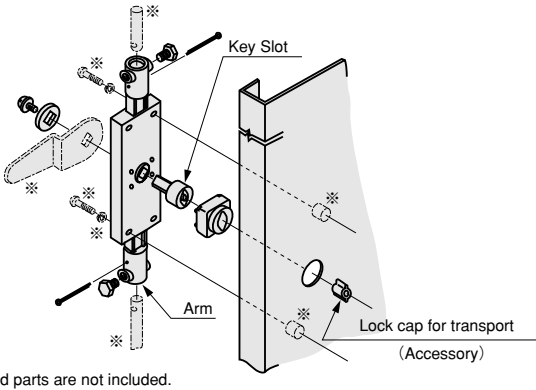

THA-410

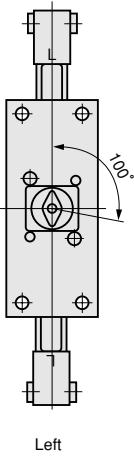
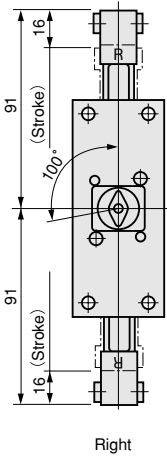
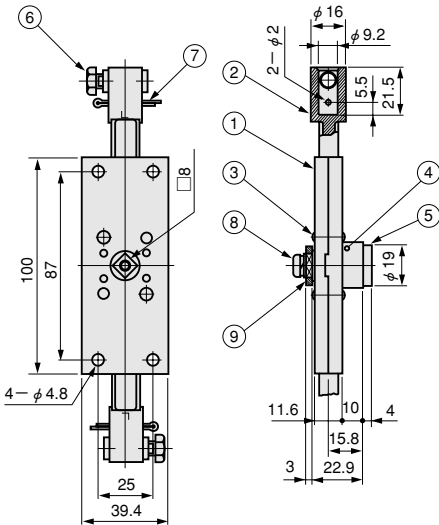
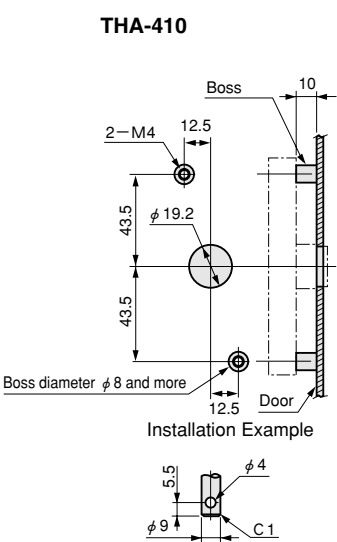

Application Example

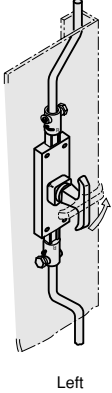
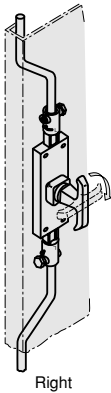

THA-411

