

REV	DESCRIPTION	DET	DATE
F	REWROTE NOTES: ADDED .453 CENTER TO EDGE DIMENSION	MK	11/19/09
G	128512 WAS 128622. ADDED 128488	JJC	08/01/12

NOTES:

- 1 MAXIMUM RECOMMENDED STROKE .500
- 2 FOR USE WITH THE 206-375 TOOL. FOR OTHER TOOLS AND/OR STROKE COMBINATIONS, REFER TO THE STROKE LIMITER CHART (HK1122) OR CONSULT AN AFS/HUCK SPECIALIST.
- 3 SHIP WITH: STOP 126747, DEFLECTOR 126748-2 AND (2) .030 SHIMS 128290 REFERENCE PB563 FOR PROPER USE.
- 4 128622 ASSEMBLY CONSISTS OF 128512 COLLET AND 128488 DRAWBAR.

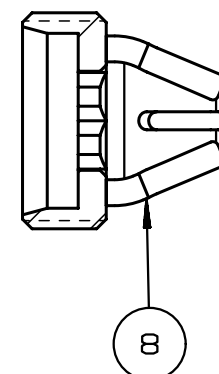

G	128488	1	DRAWBAR	9
	126748-2	1	UNITIZED DEFLECTOR	8
G	128512	1	COLLET	7
	126745	1	GUARD	6
	120095	1	DEFLECTOR	5
	122727	1	BARBED RETAINER	4
	122725	1	UNITIZED CHUCK JAW	3
	126746	1	TOP GUARD	2
	127075	1	ANVIL	1
	PART NO.	QTY	DESCRIPTION	ITEM

IDENTIFICATION PER SPEC 42-311: ★ ETCH			
ITAR:	HUCK INTERNATIONAL, INC., I.S.D. 1 CORPORATE DR, P.O. BOX 2270 KINGSTON, NEW YORK 12401		
ECCN: EAR99	NOSE ASSEMBLY -08 GP STRADDLE LONG		
SCH B#: 8467.99.0190	DET: MVM	CK:	DATE: 02/19/02 SCALE: 2:1
HTS: 8467.99.0190	B	99-3740-1	