

DO NOT
SCALE FROM
THIS PRINT

**DESIGNED & DIMENSIONED
IN MILLIMETERS
(INCHES FOR REFERENCE ONLY)**

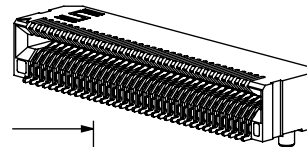
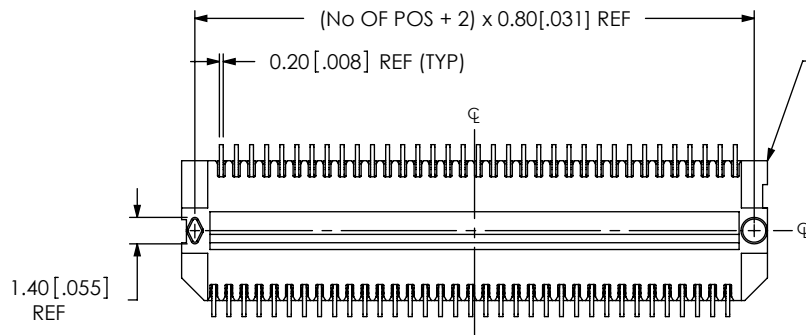
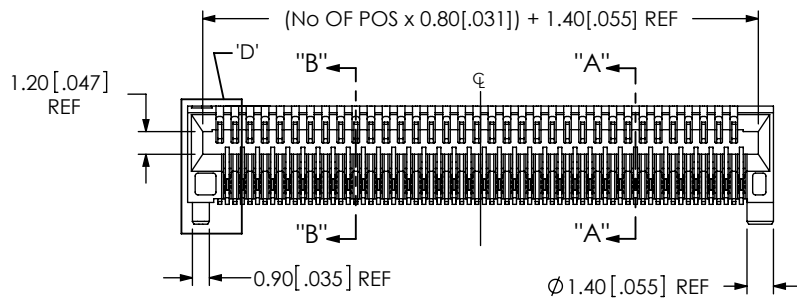
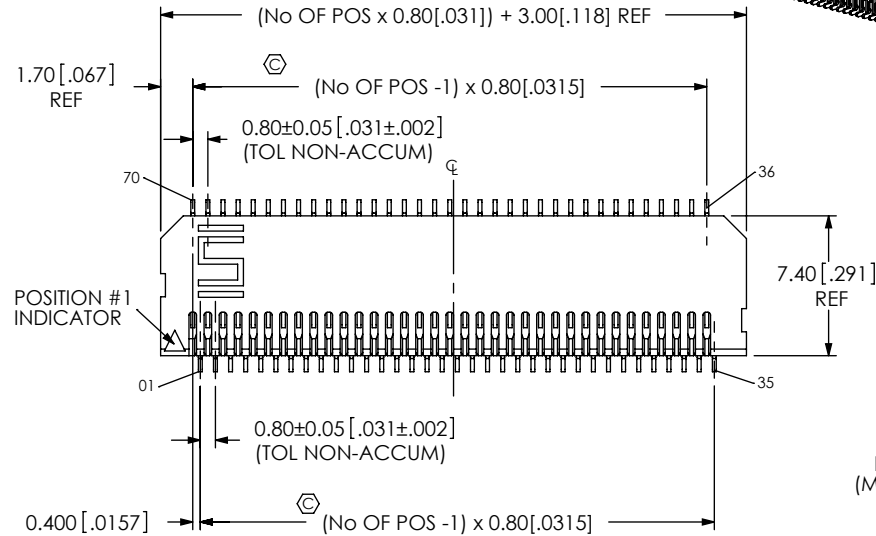

MECT-1XX-XX-XX-D-RAX-XX

No OF POSITIONS

-10, -15, -20, -35
(PER ROW)

OPTION

-TR: TAPE & REEL

CARD THICKNESS

-01: 1mm [.039] THICK CARD
(USE MECT-XX-01-D-RAX)

TAIL OPTION

-RA1: STANDARD (SEE FIG. 1)
(USE MECT-XX-01-D-RA1,
C-173-01-X & C-174-04-X)
*-RA2: ELEVATED (SEE FIG. 2)
(USE MECT-XX-01-D-RA2,
C-173-02-X & C-174-02-X)

PLATING

-M: SELECTIVE MEDIUM GOLD
(USE C-173-XX-M & C-174-XX-M)
-S: SELECTIVE GOLD
(USE C-173-XX-S & C-174-XX-S)
-MM: SELECTIVE MEDIUM GOLD, MATTE
TIN TAIL (USE C-173-XX-M & C-174-XX-M)
-SM: SELECTIVE GOLD, MATTE TIN
TAIL (USE C-173-XX-S & C-174-XX-S)

ROW SPECIFICATION

-D: DOUBLE
(USE MECT-XX-XX-D-RAX)

* = NOT TOOLED

TABLE 1

No OF POS	COPLANARITY	STRAIGHTNESS ROW 1	STRAIGHTNESS ROW 2
-10 THRU -35	0.102[.0040]	0.102[.0040]	0.102[.0040]
-40 & -50	0.152[.0060]	0.152[.0060]	0.152[.0060]

FIG 1
FOR POSITIONS -10, -20 & -35
(MECT-135-01-XX-D-RA1 SHOWN)

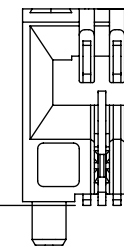
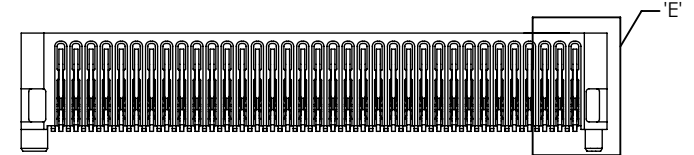
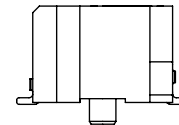

**DETAIL 'D'
SCALE 5:1**

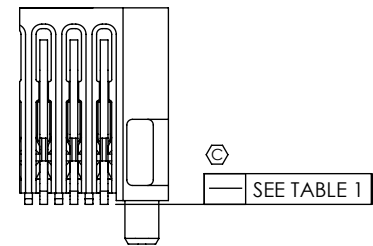

**DETAIL 'E'
SCALE 5:1**

NOTES:

1. Ⓢ REPRESENTS A CRITICAL DIMENSION.
2. MAXIMUM BURR ALLOWANCE: 0.381[.0015].
3. MINIMUM PUSHOUT FORCE: .5 LB.

UNLESS OTHERWISE SPECIFIED,
DIMENSIONS ARE IN MILLIMETERS.
TOLERANCES ARE:

DECIMALS ANGLES
.X: ±.3 [.01] 2°
.XX: ±.13 [.005]
.XXX: ±.051 [.0020]

PROPRIETARY NOTE

THIS DOCUMENT CONTAINS INFORMATION
CONFIDENTIAL AND PROPRIETARY TO
SAMTEC, INC. AND SHALL NOT BE REPRODUCED
OR TRANSFERRED TO OTHER DOCUMENTS OR
DISCLOSED TO OTHERS OR USED FOR ANY
PURPOSE OTHER THAN THAT WHICH IT WAS
OBTAINED WITHOUT THE EXPRESSED WRITTEN
CONSENT OF SAMTEC, INC.

MATERIAL: DO NOT SCALE DRAWING
INSULATOR: LCP, COLOR: BLACK
CONTACT: PHOS BRONZE

SHEET SCALE: 2.5:1

samtec

520 PARK EAST BLVD, NEW ALBANY, IN 47150
PHONE: 812-944-6733 FAX: 812-948-5047
e-Mail: info@SAMTEC.com code: 55322

DESCRIPTION:
0.8mm [.031"] RIGHT ANGLE EDGE CARD ASSEMBLY

DWG. NO.
MECT-1XX-XX-XX-D-RAX-XX

BY: KEVIN B **10/18/01** **SHEET 1 OF 3**

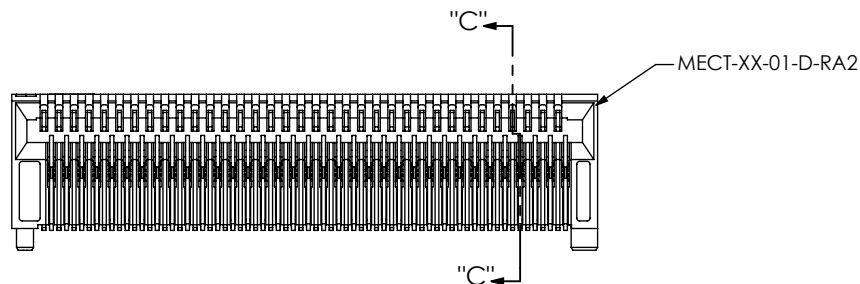
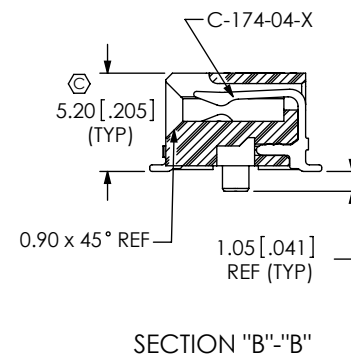
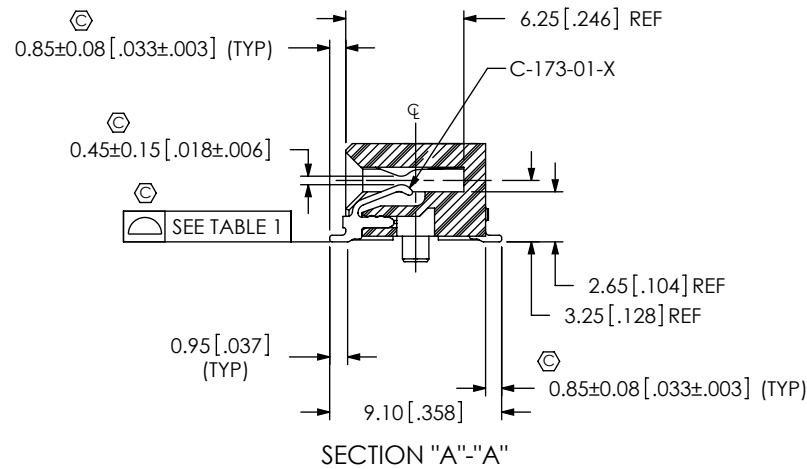
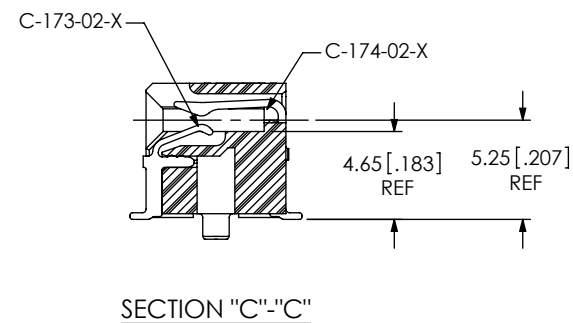

FIG 2
-RA2: ELEVATED OPTION
(SAME AS FIG 2, UNLESS OTHERWISE STATED)
(MECT-135-01-XX-D-RA2 SHOWN)
* = NOT TOOLED



F:\DWG\MISC\MKTG\MECT-1XX-XX-XX-D-RAX-XX-MKT.SLDDRW

PROPRIETARY NOTE

THIS DOCUMENT CONTAINS INFORMATION
CONFIDENTIAL AND PROPRIETARY TO
SAMTEC, INC. AND SHALL NOT BE REPRODUCED
OR TRANSFERRED TO OTHER DOCUMENTS OR
DISCLOSED TO OTHERS OR USED FOR ANY
PURPOSE OTHER THAN THAT WHICH IT WAS
OBTAINED WITHOUT THE EXPRESSED WRITTEN
CONSENT OF SAMTEC, INC.

DO NOT SCALE DRAWING

SHEET SCALE: 1:0.4

samtec

520 PARK EAST BLVD, NEW ALBANY, IN 47150
PHONE: 812-944-6733 FAX: 812-948-5047
e-Mail: info@SAMTEC.com code: 55322

DESCRIPTION:
0.8mm [.031"] RIGHT ANGLE EDGE CARD ASSEMBLY

DWG. NO.
MECT-1XX-XX-XX-D-RAX-XX

BY: KEVIN B 10/18/01 SHEET 2 OF 3

PACKAGING VIEWS
(LOAD PARTS WITH POSITION #1 INDICATOR
IN SAME DIRECTION AS ARROW ON TUBE)

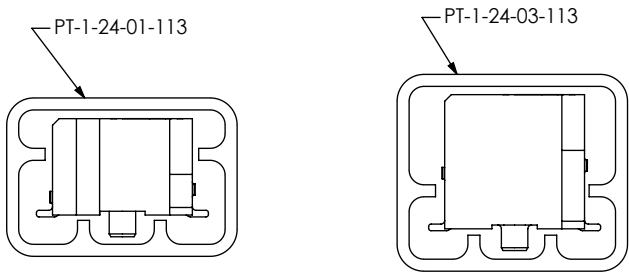

TABLE 3		
TAIL OPTION	TUBE	PLUG (2 PER TUBE)
-RA1	PT-1-24-01-113	TP-03
* -RA2	PT-1-24-03-113	TP-03

* = NOT TOOLED

-TR OPTION

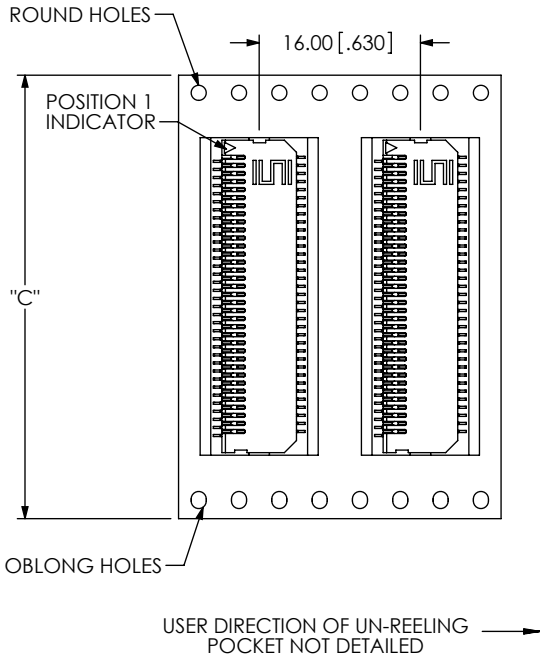

TABLE 4	
POSITION	"C"
-10	24.00 [.944]
-15	32.00 [1.260]
-20	32.00 [1.260]
-35	44.00 [1.732]

PROPRIETARY NOTE
THIS DOCUMENT CONTAINS INFORMATION
CONFIDENTIAL AND PROPRIETARY TO
SAMTEC, INC. AND SHALL NOT BE REPRODUCED
OR TRANSFERRED TO OTHER DOCUMENTS OR
DISCLOSED TO OTHERS OR USED FOR ANY
PURPOSE OTHER THAN THAT WHICH IT WAS
OBTAINED WITHOUT THE EXPRESSED WRITTEN
CONSENT OF SAMTEC, INC.

DO NOT SCALE DRAWING

SHEET SCALE: 1:0.4

520 PARK EAST BLVD, NEW ALBANY, IN 47150
PHONE: 812-944-6733 FAX: 812-948-5047
e-Mail: info@SAMTEC.com code: 55322

DESCRIPTION:
0.8mm [.031"] RIGHT ANGLE EDGE CARD ASSEMBLY

DWG. NO.
MECT-1XX-XX-XX-D-RAX-XX

BY: KEVIN B	10/18/01	SHEET 3 OF 3
-------------	----------	--------------