

**L1426 (FOR 20 x 5 mm FUSELINKS)
L1383 (FOR SIZE 00 FUSELINKS)
OPEN FUSEHOLDER, PRINTED CIRCUIT MOUNTING**

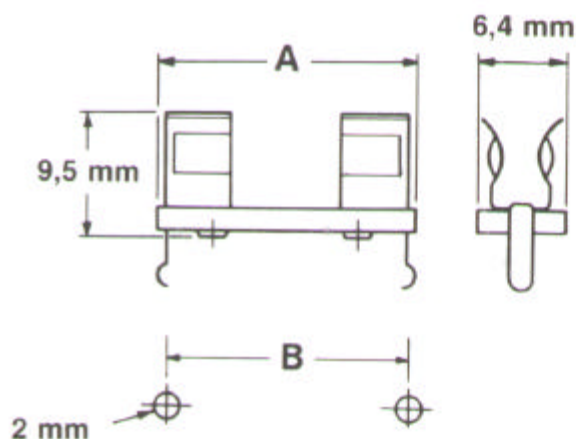

These fuseholders are mounted by means of their terminals which are shaped to secure them on the printed circuit board whilst awaiting the soldering operation. The contacts are formed in Beryllium copper which ensures adequate contact pressure after repeated use.

CURRENT RATING:	2A (temperature rise to 40 °C)
TEMPERATURE RANGE:	90 °C (ambient)
BREAKDOWN VOLTAGE:	>3kV
INSERTION RESISTANCE (MAXIMUM):	<4 milliohms
INSULATION RESISTANCE:	100 megohms
HUMIDITY:	Dry conditions only
PANEL THICKNESS (MAXIMUM):	1.6mm
WEIGHTS:	L1426: 1.02g L1383: 0.9g
MATERIAL:	Insulant: S.R.B.P. Contacts: Beryllium copper, silver plated
ORDERING REFERENCE:	(20x5 size): L1426 (00 size): L1383



L1426 (20x5 size)
Dimension A 23,8 mm
B 22,9 mm

L1383 (00 size)
Dimension A 18,7 mm
B 17,8 mm



BLP reserve the right to change without prior notice the information contained within this leaflet

BLP Components Ltd., Exning Road, Newmarket, Suffolk, CB8 0AX, England
Tel: +44 (0)1638 665161 Fax: +44 (0)1638 660718 email: sales@blpcomp.com <http://www.blpcomp.com>