

New TRIM TRIO®



**RoHS
Compliant**

UTS series

IP68 / IP69K Plastic Connector

• Rapid

• Secure

• High Performance

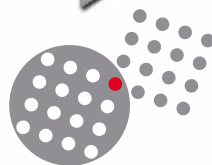

SOURIAU
Connection Technology

UTS



Contents

| | | | |
|--------------------------------------|------------|--------------------------------|--------------|
| Company profile | 2 | Ergonomic plug..... | 10 |
| Contents | 3 | Backshells..... | 10 |
| Description | 3 | Sealing caps..... | 10 |
| Overview TRIM TRIO® | 4 | UTS | 11-16 |
| Major features & benefits | 5-9 | Technical characteristics..... | 11 |
| Contact styles..... | 5 | Cable plug..... | 12 |
| Rapid and secure locking system.... | 6 | Jam nut receptacle..... | 13 |
| Rapid and trouble free service..... | 6 | PCB jam nut receptacle..... | 14 |
| Extreme sealing performance..... | 7 | Accessories..... | 15 |
| Contact arrangements..... | 8 | What sealing is.... | 16 |
| Rapid and secure panel mounting... | 9 | Industrial applications..... | 17 |
| PCB receptacle..... | 9 | | |

Description

IP68 / IP69K plastic circular connector with rapid locking system

“UTS” is the latest addition to the well known TRIM TRIO® interconnect system.

‘UTS’ is a range of Industrial circular multiway connectors available in 3 shell sizes and 9 contact arrangements.

The keywords for the new UTS are: Rapid – Secure – High performance

• Rapid

Rapid refers to the locking system and the total installed cost starting with the wiring & cabling and ending with the installation to the customers equipment. Rapid also refers to the total service on price request, samples and production deliveries.

• Secure

The secure locking system together with the secure and versatile TRIM TRIO® contacts are giving confidence to both the connection and the customers equipment.

Moreover UTS is part of the well known TRIM TRIO® interconnect system with its more then 40 years of field experience.

• High Performance

Extreme performance on water protection even in dynamic situations this in combination with a rapid and secure locking system makes UTS suitable for any high performance application.

UTS provides a connection that performs faster, easier, safer and more reliable, it makes :

UTS : Your first choice in waterproof connectors !

UTS - Major features and benefits

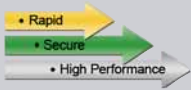
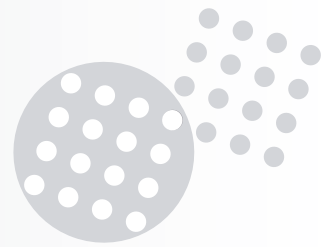

Different contact styles, selective loading, easy reparability, rapid crimping...rapid assembly

➡ **TRIM TRIO® contacts - The most versatile and modular contacts concept**

- Available in 4 different contact styles
- Suitable for field service and maintenance
- Combine all contact styles in same connector
- Established for more than 40 years

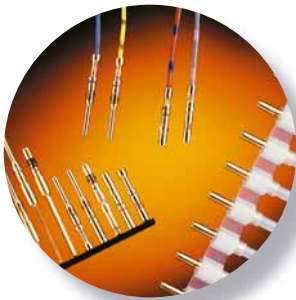

Machined

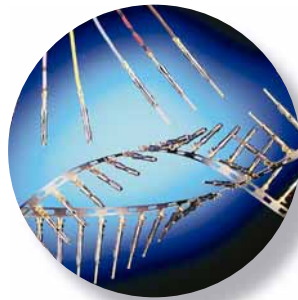

Stamped

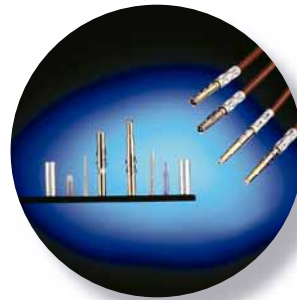

Coax

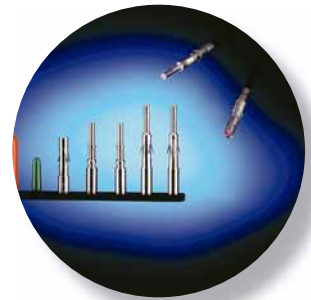

Fiber optic

➡ **Rapid crimping with TRIM TRIO® contacts**

- Reliable and trouble free crimping
- Hand tools for maintenance and production
- Semi automatic bench press & applicators
- Stripper crimpers
- Contacts to be ordered separately
- Refer to TRIM TRIO® catalogue



➡ **Rapid assembly of contacts**

- Push the contact in the cavity until it clicks»
- Selective loading
- Easy to repair

➡ **Rapid assembly of backshell**

- Limited number of components
- Integrated cable gland
- Backshell suitable for a wide range of cables

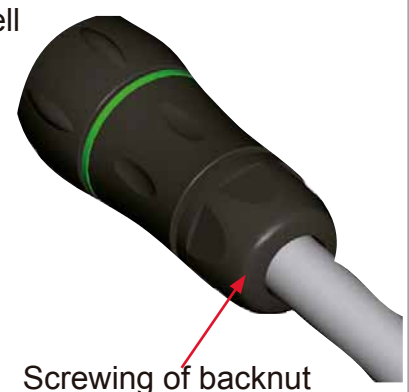
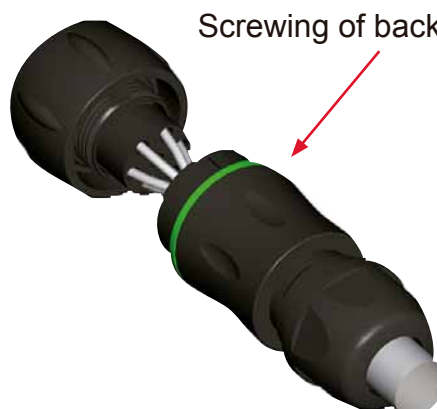
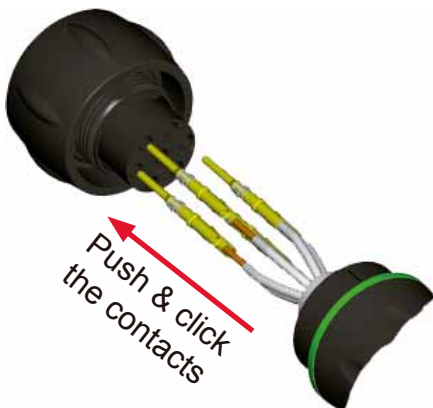

UTS : Your first choice in waterproof connectors !

UTS - Major features and benefits



Rapid and secure locking system

- ➡ Confidence that the connector is properly mated
- ➡ Easy to connect in difficult places
- ➡ Minimalised operator fatigue
- ➡ Labor saving

Rapid mating with 1/3 turn
with an audible & sensitive "click"

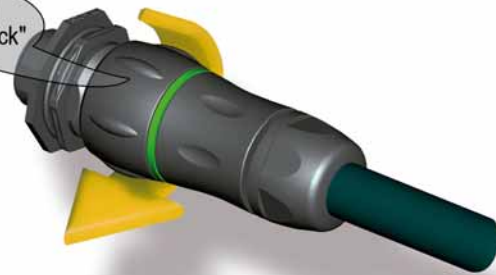

Rapid and trouble free service

- ➡ Fast delivery of samples, quotes and production volumes

Worldwide network of:

- Sales units
- Distributors
- Agents



UTS : Your first choice in waterproof connectors !



UTS - Major features and benefits



Extreme environmental sealing performance

➡ IP68 / IP69K sealing ... even in dynamic situations

➡ Dynamic IP68*

Connector will remain IP68 even when:

- Pulling on the cable
- Bending the cable

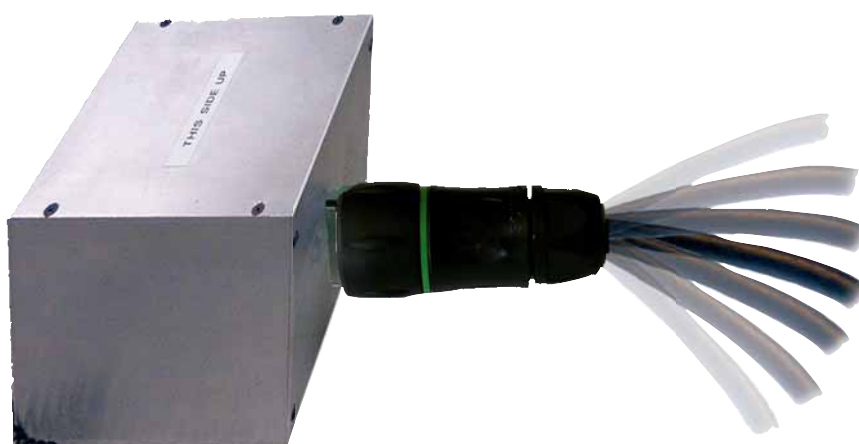

➡ Dynamic IP69K*

Connector withstands high pressure water cleaning

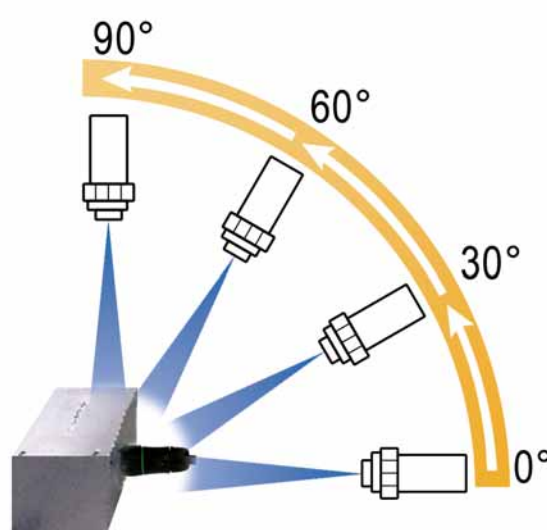

* See table page 16 for more details

UTS : Your first choice in waterproof connectors !

UTS - Major features and benefits



Multiple contact arrangements with VDE 0110 performances

- ➡ **Multiple contact arrangements within same connector size**
 - Different levels of current and rated voltages per VDE 0110
 - Available in male and female gender
 - Custom version upon request such as:
 - Mixed contact sizes
 - Power versions
 - High speed versions (RJ45, USB, BNC), upon request
- ➡ **UTS insert arrangements, contact size, rated voltage per VDE 0110 & current ratings**

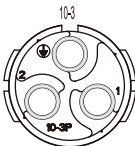
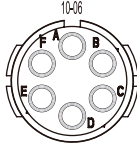
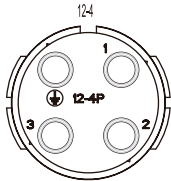
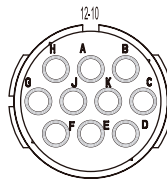
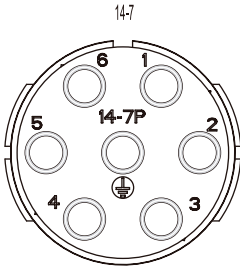
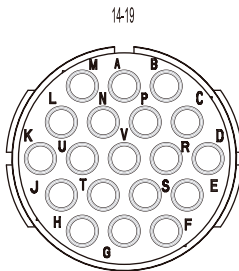
| Contact size | # 16 (dia. 1.6mm) | | #20 (dia. 1.0mm) |
|---------------------------|--------------------------|---|---|
| Rated voltage | 250 V | 125 V | 125 V |
| Overvoltage category | III | III | III |
| Pollution degree | 3 | 3 | 3 |
| Size 10 | * |  |  |
| | | | |
| | | | |
| Number of contacts | 3 (2+ grounding) | 4 | 6 |
| Max current (per contact) | 13A (machined + stamped) | 13A (machined + stamped) | 7.5A (machined) / 5A (stamped) |
| Size 12 | * |  |  |
| | | | |
| | | | |
| Number of contacts | 4 (3 + grounding) | 8 | 10 |
| Max current (per contact) | 13A (machined + stamped) | 13A (machined + stamped) | 7.5A (machined)/ 5A (stamped) |
| Size 14 | * |  |  |
| | | | |
| | | | |
| Number of contacts | 7 (6 + grounding) | 12 | 19 |
| Max current (per contact) | 13A (machined + stamped) | 13A (machined + stamped) | 7.5A (machined)/ 5A (stamped) |

* Arrangements with advanced grounding cavity.

UTS : Your first choice in waterproof connectors !



UTS - Major features and benefits



Rapid and secure panel mounting

Rear panel mount solution suitable for pre-harnessing and PCB mounting

Captive panel seal to prevent misalignment

Robust jam nut to guarantee a rapid, secure and vibration proof panel mounting

O-ring seal to guarantee sealing between receptacle and plug

D-shape panel cut to ensure correct mounting and to prevent the connector from rotating

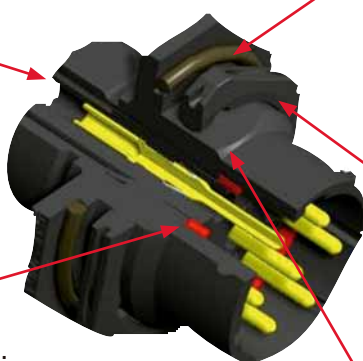

Assembly procedure of jam nut receptacle

Step 1

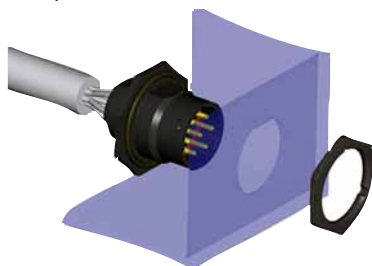

Step 2

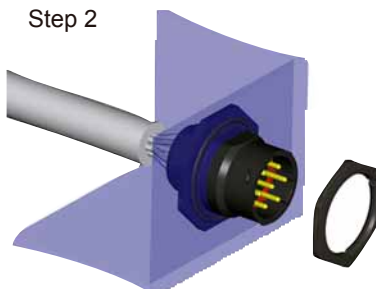

Step 3

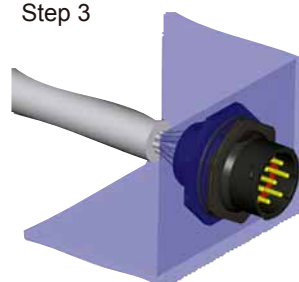

PCB receptacle...low profile with rapid installation features

Low profile housing to limit space between panel and PCB

Metal hold down clips

- to lock the connector easily on the PCB and to release stress on solder joints
- Suitable for soldering in a metallised hole

Pre-assembled PCB contacts

- machined or stamped versions available
- different solder tail lengths possible
- different plating options

Stand-offs to allow cleaning after soldering

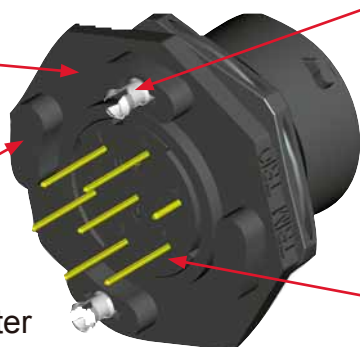

UTS : Your first choice in waterproof connectors !



UTS - Major features and benefits



Ergonomic plug design with maximized cabling space and minimized connector length

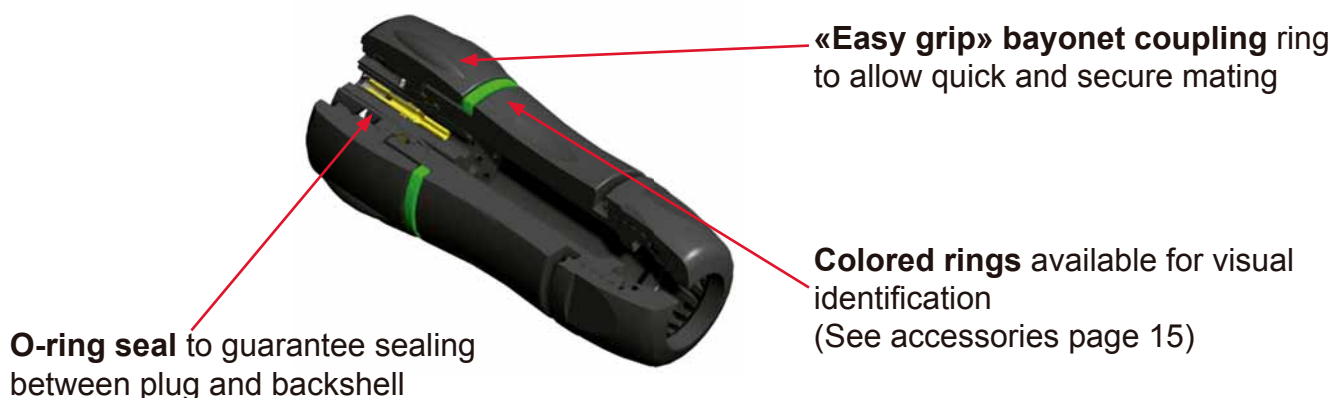

Backshells...accepting a wide range of cables

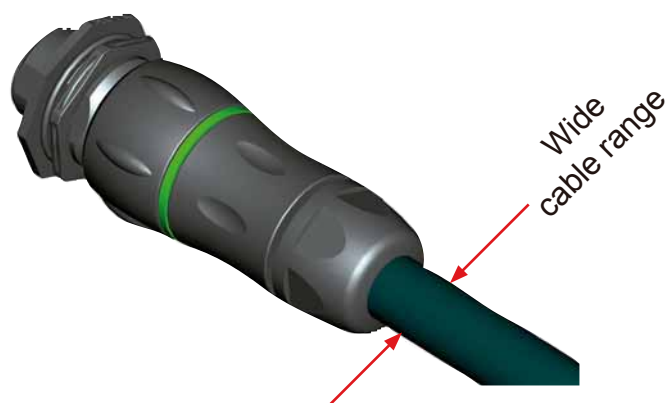

| | |
|---------|----------------|
| Size 10 | 2.5 to 8.0 mm |
| Size 12 | 3.0 to 12.0 mm |
| Size 14 | 5.0 to 14.0 mm |

Low installed cost with reduced number of components



Sealing caps...easy to install...at any time

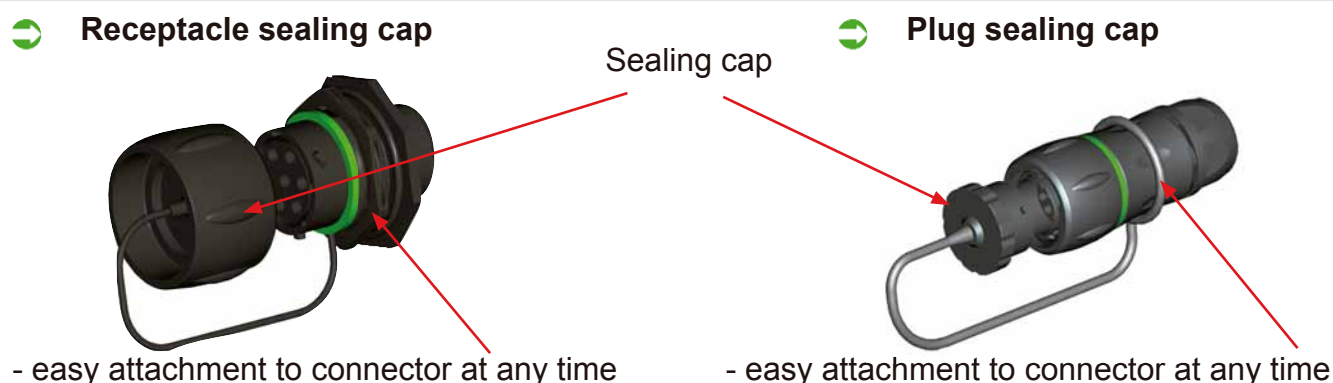

UTS : Your first choice in waterproof connectors !



Technical characteristics

MECHANICAL

- Durability: 250 matings & unmatings
- Vibration resistance: Per CEI 60512-4
- Thermal shock: Per MIL-STD1344 method 1003

ELECTRICAL

- Insulation resistance: 5000 MΩ min
- Test potential: 2000 VAC
- As per VDE specifications (see page 8 for more details)

ENVIRONMENTAL

- Operating temp: -40°C to + 105°C
- Flammability rating: UL94V0 and NFF16101 level 2
- Sealing (mated): Dynamic IP68 – 10m under water for 1 week per IEC60529
Dynamic IP69K per DIN40050
- UV resistant: No mechanical degradation or important variation of color after 5 years of exposure in natural environment (equivalence exposure to sun and moisture as per ISO 4892)
- Salt spray: 500 hours



MATERIAL

- Connectors + Backshell: Thermoplastic

PLATING (only for PCB version)

- Plating for machined contacts: min 0.4 μ gold all over
- Plating for stamped contacts: Min 0.4 μ gold in contact area
3 – 5 μ tin on solder tail

Other platings upon request

CONTACT ACCOMMODATION

- “UTS” connectors accept TRIM TRIO® size 16 or size 20 (depending on arrangement)
removable snap-lock contacts
- Contacts to be ordered separately (except PCB versions)
- Refer to TRIM TRIO® catalog for details or visit our website:
www.souriau.com → products → by connector type → TRIM TRIO® → contacts

In accordance with UL requirements

UTS : Your first choice in waterproof connectors !



Cable plug with backshell for pin and socket contacts (UTS6JC...P / UTS6JC...S)

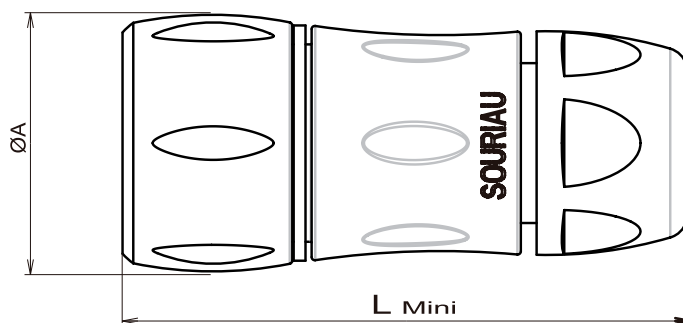

Each plug has 2 seals to cover the specified cable range (See table below).
The standard seal is preassembled
The second seal is supplied as loose piece together with a plug.

| PN pin contact | PN socket | Nb of contacts x contact Ø | Shell size | L | Ø A | Ø Cable range |
|----------------|-------------|-------------------------------|---------------|------|------|---------------------------------------|
| UTS6JC103P | UTS6JC103S | 3 x 1.6 mm | 10 | 63.2 | 26.2 | 1.5 to 5.0 2.5 to 8.00 (standard) |
| UTS6JC104P | UTS6JC104S | 4 x 1.6 mm | | | | |
| UTS6JC106P | UTS6JC106S | 6 x 1.0 mm | | | | |
| UTS6JC124P | UTS6JC124S | 4 x 1.6 mm | 12 | 66.7 | 29.7 | 3.0 to 9.0 5.0 to 12.0 (standard) |
| UTS6JC128P | UTS6JC128S | 8 x 1.6 mm | | | | |
| UTS6JC1210P | UTS6JC1210S | 10 x 1.0 mm | | | | |
| UTS6JC147P | UTS6JC147S | 7 x 1.6 mm | 14 | 71.5 | 34.6 | 5.0 to 12.0 7.0 to 14.0 (standard) |
| UTS6JC1412P | UTS6JC1412S | 12 x 1.6 mm | | | | |
| UTS6JC1419P | UTS6JC1419S | 19 x 1.0 mm | | | | |

For more detail on contact arrangements, see page 8.

Coloured ring supplied as optional extra (See page 15).

Contacts to be ordered separately.

For more details about TRIM TRIO® connectors, refer to TRIM TRIO® catalogue or visit our website:
www.souriau.com → products → by connector type → TRIM TRIO® → contacts

Note: All dimensions are in mm.

Dimensions are not contractual and may be subject to modifications.

UTS : Your first choice in waterproof connectors !



Jam nut receptacle (wire version) for pin and socket contacts (UTS7...P / UTS7...S)

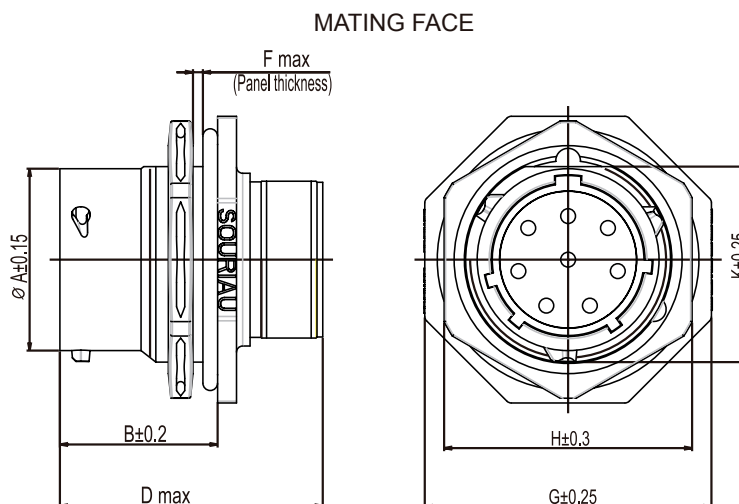

PANEL CUT OUT

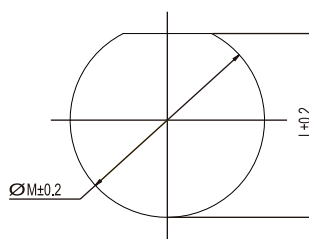

| PN pin contact | PN socket | Nb of contacts x contact Ø | Shell size | Ø A | B | D Max | F Max | G | H | K | L | Ø M |
|----------------|-----------|-------------------------------|---------------|--------|------|----------|----------|------|------|------|------|------|
| UTS7103P | UTS7103S | 3 x 1.6 mm | 10 | 14.9 | 19.3 | 33.9 | 3.2 | 27.0 | 22.2 | 16.6 | 16.5 | 17.7 |
| UTS7104P | UTS7104S | 4 x 1.6 mm | | | | | | | | | | |
| UTS7106P | UTS7106S | 6 x 1.0 mm | | | | | | | | | | |
| UTS7124P | UTS7124S | 4 x 1.6 mm | 12 | 19.0 | 19.3 | 33.9 | 3.2 | 31.8 | 27.0 | 20.8 | 21.2 | 22.5 |
| UTS7128P | UTS7128S | 8 x 1.6 mm | | | | | | | | | | |
| UTS71210P | UTS71210S | 10 x 1.0 mm | | | | | | | | | | |
| UTS7147P | UTS7147S | 7 x 1.6 mm | 14 | 22.2 | 19.3 | 33.9 | 3.2 | 34.9 | 30.2 | 23.9 | 24.3 | 25.7 |
| UTS71412P | UTS71412S | 12 x 1.6 mm | | | | | | | | | | |
| UTS71419P | UTS71419S | 19 x 1.0 mm | | | | | | | | | | |

For more detail on contact arrangements, see page 8.

Coloured ring supplied as optional extra (See page 15).

Contacts to be ordered separately.

For more details about TRIM TRIO® connectors, refer to TRIM TRIO® catalogue or visit our website:
www.souriau.com → products → by connector type → TRIM TRIO® → contacts

Note: All dimensions are in mm.

Dimensions are not contractual and may be subject to modifications.

For free hanging applications, connector can be equipped with the same backshell as for the plug (please consult us).

UTS : Your first choice in waterproof connectors !