

## 10 (3/8") SQUARE DRIVE

10 3/8 10 3/8

## RATCHETS 10 (3/8")

[www.gedore.com](http://www.gedore.com)

### 3093 U-20

#### REVERSIBLE RATCHET 3/8"

- Acc. to DIN 3122, ISO 3315
- Small, drop shaped head for confined areas
- Fine-toothed, with lever change and push-button release
- Non-slip 2-component handle with hanging hole
- For hand-operated sockets and accessories with square drive as per DIN 3120 - C 10, ISO 1174, ball locking device
- GEDORE vanadium steel 31CrV3, chrome-plated



10  
3/8"

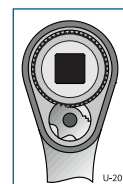
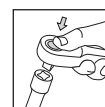

Code	No.	□"	□	□°	□mm	□	□	□	£
1556800	<b>3093 U-20</b>	3/8	10	6	200	29.7	292	5	

### 3093 U-10

#### REVERSIBLE RATCHET 3/8"

- Acc. to DIN 3122, ISO 3315
- With lever change, locks in middle position, oval head
- Push-button release
- For hand-operated sockets and accessories with square drive as per DIN 3120 - C 10, ISO 1174, ball locking device
- GEDORE vanadium steel 31CrV3, chrome-plated



10  
3/8"

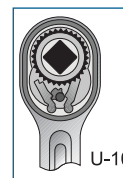
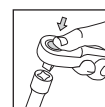

Code	No.	□"	□	□°	□mm	□	□	□	£
6236950	<b>3093 U-10</b>	3/8	10	11,25	200	30.2	254	5	

### 3093 U-10 HL

#### REVERSIBLE RATCHET 3/8" HI-LOK®

- Especially for Hi-Lok® bolts (scrivets) in the aerospace industry
- Lever change ratchet with magnetic locking, from GEDORE vanadium steel 31CrV3
- With lever change, oval head
- For hand-operated sockets
- Hi-Lok® = reg. trademark of Hi-Shear Corporation, Ca. USA



10  
3/8"



Code	No.	□"	□	□°	□mm	□	□	□	£
2226286	<b>3093 U-10 HL</b>	10	11,25	200	28.0	250	1		



### 3093 ALU-10

#### ALUMINIUM REVERSIBLE RATCHET 3/8"

- Design spec. similar to DIN 3122, ISO 3315
- Made from special-purpose drop-forged and hardened aluminium
- The mechanism as in all U-10 ratchets is made from high quality steel
- With lever change
- Push-button release
- Locks in the middle position: When the lever is flipped, it automatically engages for clockwise or counterclockwise operation
- For hand-operated sockets and accessories with square drive as per DIN 3120 - C 10, ISO 1174, ball locking device
- Extremely lightweight - just 160 g



10  
3/8"

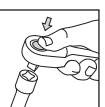

Code	No.	□"	□	□°	□mm	□	□	□	£
1900005	<b>3093 ALU-10</b>	3/8	10	11,25	200	30.2	160	1	



**3/8"****GEDORE****3093 U-3****REVERSIBLE RATCHET 3/8"**

- Acc. to DIN 3122, ISO 3315
- With non-slip metal disc change, fine-toothed and robust
- For hand-operated sockets and accessories with square drive as per DIN 3120 - C 10, ISO 1174, ball locking device
- GEDORE vanadium steel 31CrV3, chrome-plated

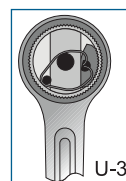
**10**  
**3/8"**

U-3

Code	No.	■"	■	°	mm	mm	mm	mm	£
6237090	<b>3093 U-3</b>	3/8	10	5	200	33.5	244	5	

**3093 GU-3****SWIVEL HEAD REVERSIBLE RATCHET 3/8"**

- Swivels through 180°, with joint lock
- With non-slip metal disc change, fine-toothed and robust
- Max. torque 200 N-m
- For hand-operated sockets and accessories with square drive as per DIN 3120 - C 10, ISO 1174, ball locking device
- GEDORE vanadium steel 31CrV3, chrome-plated

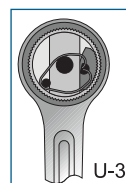
**10**  
**3/8"**

U-3

Code	No.	■"	■	°	mm	mm	mm	mm	£
6237170	<b>3093 GU-3</b>	3/8	10	5	282	33.5	525	5	

**3093 Z-94****RATCHET HANDLE WITH COUPLER 3/8"**

- Acc. to DIN 3122, ISO 3315
- With square coupler, medium-fine toothed, extremely rugged
- For hand-operated sockets and accessories with square drive as per DIN 3120 - C 10, ISO 1174, ball locking device
- GEDORE vanadium steel 31CrV3, chrome-plated

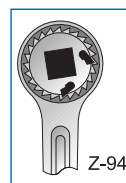
**10**  
**3/8"**

Z-94

Code	No.	■"	■	°	mm	mm	mm	mm	£
6237680	<b>3093 Z-94</b>	3/8	10	10	200	18	223	5	

**3093 U-10 K****PLASTIC RATCHET 3/8"**

- For fast and easy tightening of bolted connections up to max. 70 N-m
- Very handy and compact, housing and handle form one unit
- Return angle 11.25°
- Made from sturdy compound material with a steel mechanism
- Dimensions: 44 x 145 x 39 mm
- Available in five colours
- European-Patent-No. 1136187

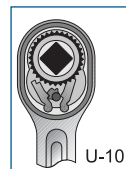
**10**  
**3/8"**

U-10

Code	No.	Colour	■"	■	mm	°	mm	mm	£
6242090	<b>3093 U-10 K SCHWARZ</b>	signal-black	3/8	10	145	11,25	197	5	
6244970	<b>3093 U-10 K GRÜN</b>	moss-green	3/8	10	145	11,25	197	5	
6248100	<b>3093 U-10 K GRAU</b>	anthracite-grey	3/8	10	145	11,25	197	5	
6248290	<b>3093 U-10 K BLAU</b>	sky-blue	3/8	10	145	11,25	197	5	
1505394	<b>3093 U-10 K SIGNALGRAU</b>	signal-grey	3/8	10	145	11,25	197	1	

**3093 U-3 T****RATCHET WITH T-HANDLE 3/8"**

- Two-wing T-handle
- Ergonomic design for comfortable working
- For hand-operated sockets and accessories with square drive as per DIN 3120 - C 10, ISO 1174, ball locking device
- The danger of the tool canting, when carrying out work with extensions, is reduced by the central positioning of the square drive

**10**  
**3/8"**

Code	No.	■"	■	°	mm	mm	mm	£
1973320	<b>3093 U-3 T</b>	3/8	10	5	140	68	1	