

This document is the property of Amphenol Corporation and is delivered on the express condition that it is not to be disclosed, reproduced or used, in whole or in part, for manufacture or sale by anyone other than Amphenol Corporation without its prior consent, & that no right is granted to disclose or to use any information in this document.

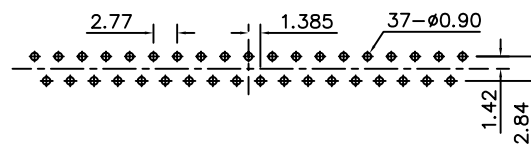

RECOMMENDED P.C.B LAYOUT  
(TOLERANCE  $\pm 0.03$ )

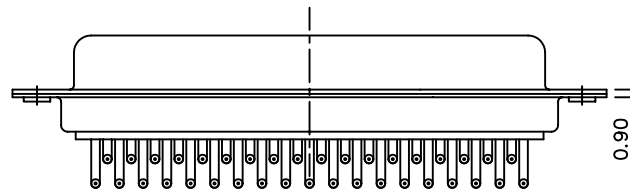
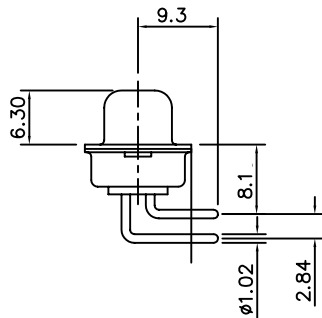
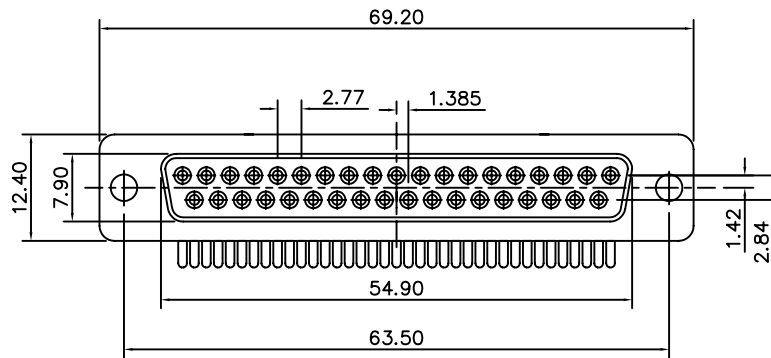

REVISIONS				
SYM	ECN	DESCRIPTION	DATE	APPROVED
A			26/01/07	

### D-SUB TECHNICAL DATA

SHELL :Steel 2.5um(100u") min tin over 1.25um(50u") min nickel  
BODY : Glass filled thermoplastic.  
Flame retardant to UL94 V-0 Color Black  
CONTACTS : Brass  
0.1um(4u") min gold over 1.25um(50u") min nickel  
ELECTRICAL : Voltage rating : 300 V RMS at 50 Hz  
Current rating 7.5A.  
Insulation resistance >5000 M Ohms  
Contact resistance 8.5 mOhms max.  
CLIMATIC : Temperature range -55 °C up to 85°C  
Damp heat 21 days(40 °C-95% HR)  
MECHANICAL : mating force 0.341kg max  
unmating force 0.021kg min  
MARKING : Amphenol...(Series No.)  
Commercial reference  
Manufacturing date

### PRODUCT CODE

L 77D C 37 S C

L: RoHS Compliance

77D: tinned shell for receptacle

Shell Size :C

right angle connector:  
C=tail  $\phi 1.02$ mm

Contact type:  
S:Female  
P: Male

Configuration: 37

UNLESS OTHERWISE SPECIFIED TOLERANCES		APPROVAL	DATE
U.S.	METRIC	DRAWN	Helen Jiang 26/01/07
.X $\pm$	0.50	CHECKED	lik.wang 26/01/07
.XX $\pm$	0.30	CHECKED	
.XXX $\pm$	0.20		
FRACTIONS $\pm$			
ANGLES $\pm$	2°		
FOR MATERIALS AND FINISHES SEE NOTES		DRAWING FILE :	
REMOVE SHARP EDGES		ANGLE OF PROJECTION	
DIMENSIONS			
U.S.	INCHES		
METRIC	MM		

Amphenol		TITLE	
		machined contacts connector, D series	
SIZE	DRAWING NO.	REV.	
A4	C L77DA15SC	A	
SCALE	NONE	SHEET 1 OF 1	

# Mouser Electronics

Authorized Distributor

Click to View Pricing, Inventory, Delivery & Lifecycle Information:

[Amphenol:](#)

[L77DC37SC](#)