

# Male Disconnect Terminal



## Specifications:



Connector Type	: Male Disconnect
Insulator Colour	: Red
Termination Method	: Crimp
Stud/Tab Size	: 0.187 × 0.02"
Wire Size (AWG)	: 22-18
Barrel Seam	: Butted with insulation grip
Maximum Voltage Rating	: 600V building wire 1,000V signs or fixtures (Luminaries)
Maximum Temperature Rating	: 221°F (105°C)
Maximum Current	: Same as wire
Insulator Material	: Nylon
Terminal Material	: ETP copper
Insulation Grip Material	: Brass
Plating	: Tin

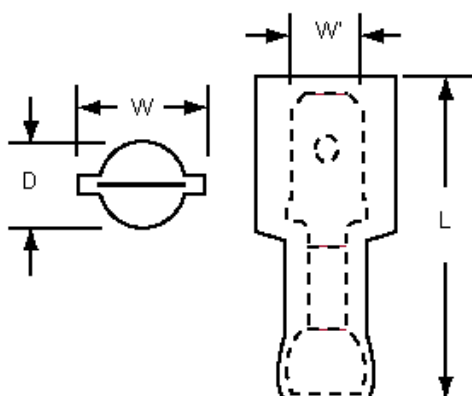

Barrel Crimp (Electrical)

Insulation Crimp (Mechanical)

## Dimension Table

Wire Range (AWG)	L	W	D	Male Tab Width (W') × Thickness	Barrel Length	Barrel I D	Maximum Insulation Diameter
22 - 18	0.87	0.37	0.3	0.187 × 0.02	0.24	0.08	0.145

Dimensions : Inches

# Male Disconnect Terminal



## Installation Information:

Turn power before installing or removing terminal.  
Strip away the end 3/8 inch of wire insulation.  
Suitable for factory application on steel or brass tabs.  
Suitable for field application on brass tabs, strain relief required.

## Engineering Specification:

Crimp-type male quick disconnect shall, electrically and mechanically connect permanently to a pre-stripped end of a stranded copper wire and, have a flat rectangular tongue portion for mating to a female quick disconnect in a separable, reusable manner, forming a quick connect wiring connection.

The connector line shall offer tongue variations (size  $0.187 \times 0.02$  per ANSI / NEMA DC-2) and barrel variations in wire size 22 - 18 AWG and construction of non-insulated, vinyl insulated, nylon fully insulated, etc.

The nylon fully insulated male quick disconnect

The nylon fully insulated male quick disconnect with insulation grip shall be tin plated 0.02" thick copper, with a 0.187" blade conforming to ANSI / NEMA DC-2 dimensions and a 0.24" long barrel with a tin plated brass insulation grip covered by a moulded nylon funnel entry sleeve which extends to cover the tongue, colour coded, and sized for a specified (AWG) wire range (22 - 18).

Insulated connectors for 600V maximum, building wire : 1,000V maximum, signs and fixtures (luminaries). The connector shall be temperature rated 221°F (105°C) maximum.

Quick disconnect connectors shall be suitable for field or factory wiring.

## Important Notice:

Before using this product, you must evaluate it and determine if it is suitable for your intended application.

## Part Number Table

Description	Part Number
Terminal, Male Disconnect, 0.187", Red	CMS-DF-1818

**Important Notice :** This data sheet and its contents (the "Information") belong to the members of the Premier Farnell group of companies (the "Group") or are licensed to it. No licence is granted for the use of it other than for information purposes in connection with the products to which it relates. No licence of any intellectual property rights is granted. The Information is subject to change without notice and replaces all data sheets previously supplied. The Information supplied is believed to be accurate but the Group assumes no responsibility for its accuracy or completeness, any error in or omission from it or for any use made of it. Users of this data sheet should check for themselves the Information and the suitability of the products for their purpose and not make any assumptions based on information included or omitted. Liability for loss or damage resulting from any reliance on the Information or use of it (including liability resulting from negligence or where the Group was aware of the possibility of such loss or damage arising) is excluded. This will not operate to limit or restrict the Group's liability for death or personal injury resulting from its negligence. Multicomp is the registered trademark of the Group. © Premier Farnell plc 2012.