

THE INFORMATION CONTAINED IN THIS DRAWING IS THE SOLE PROPERTY OF  
BUD INDUSTRIES INC. ANY REPRODUCTION IN PART OR WHOLE WITHOUT  
THE WRITTEN PERMISSION OF BUD INDUSTRIES INC. IS PROHIBITED.

DWG. NO.	AN-2900	
ISSUE	REVISIONS	
A	UPDATED DRAWING 8-8-08 DAB	

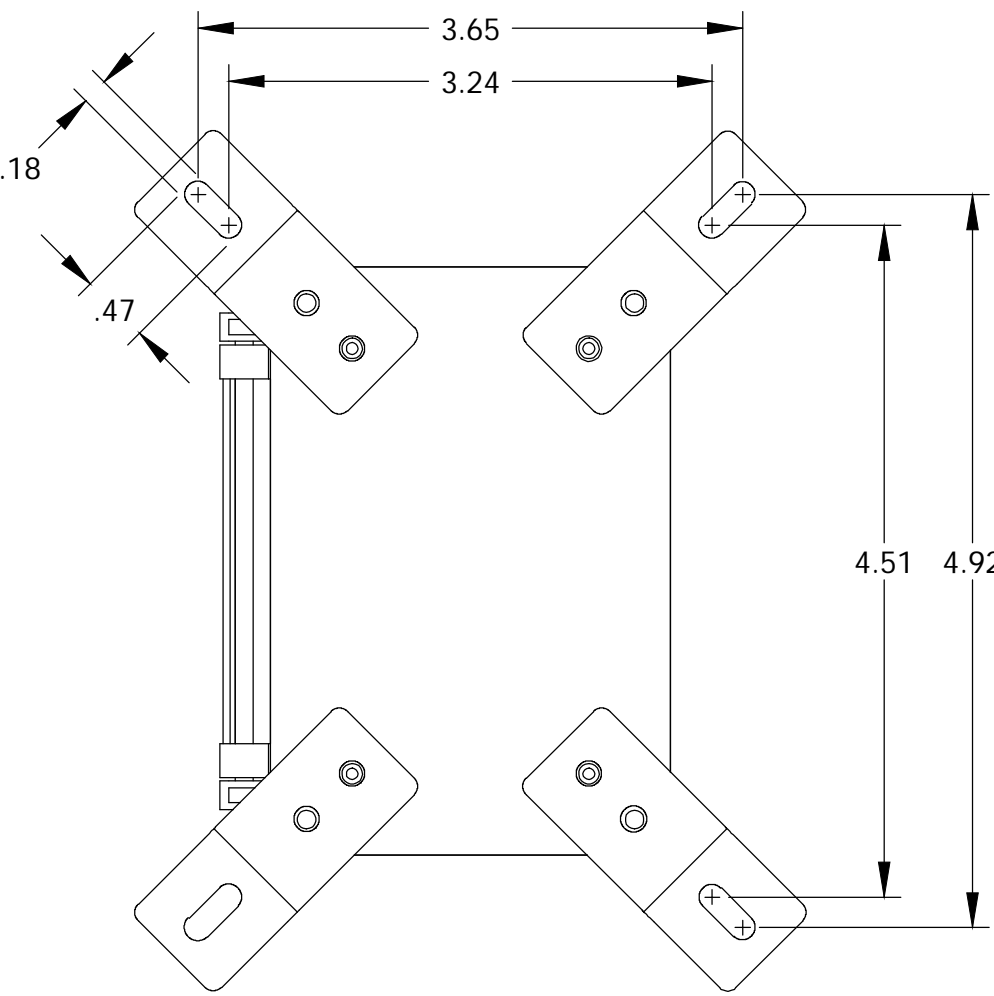

REFERENCE SHOWN WITH MOUNTING BRACKETS  
ASSEMBLED (SHIPPED UNASSEMBLED AND  
SUPPLIED WITH M4x.7 x .33" LG. PAN HD. SCREWS)

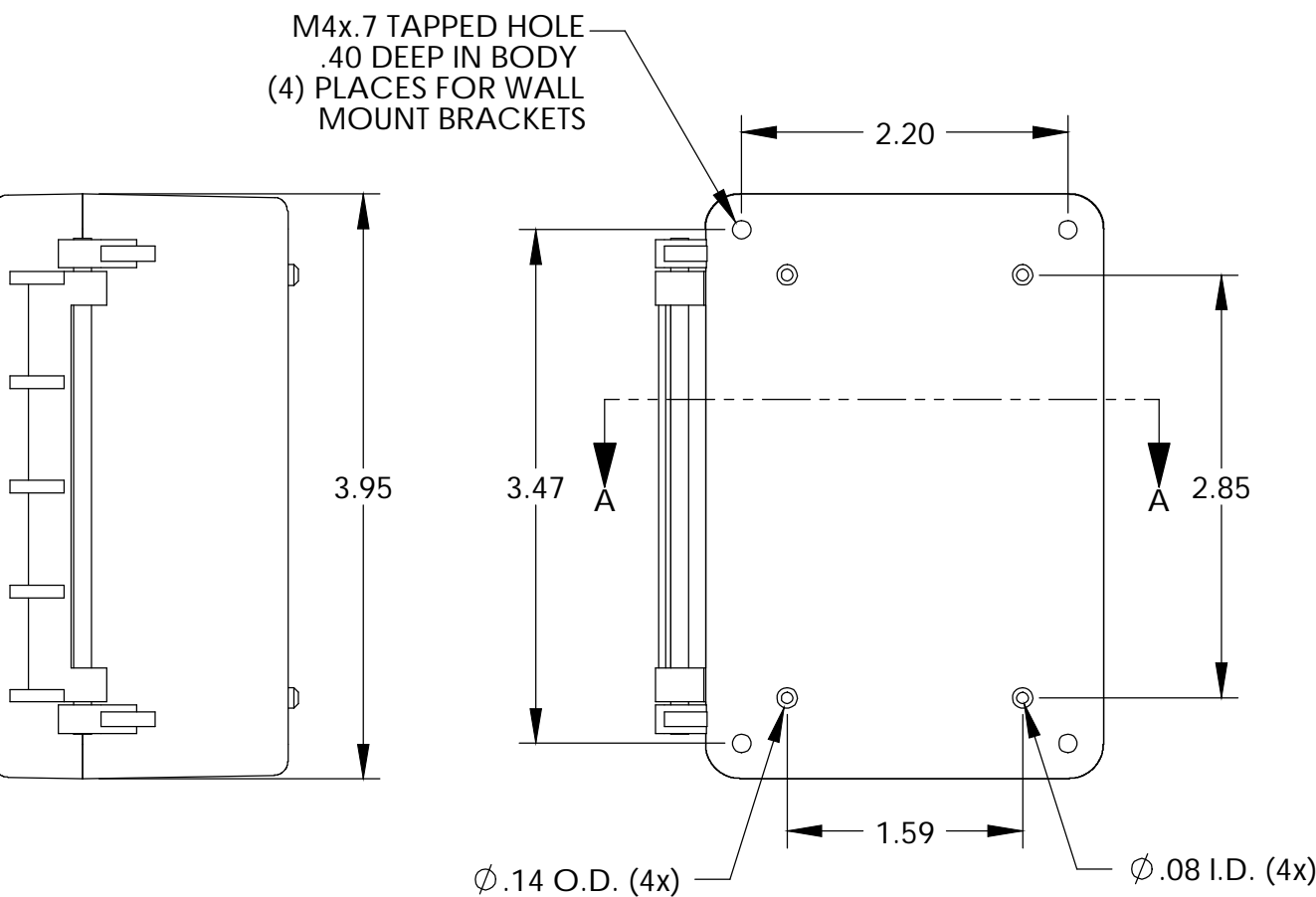
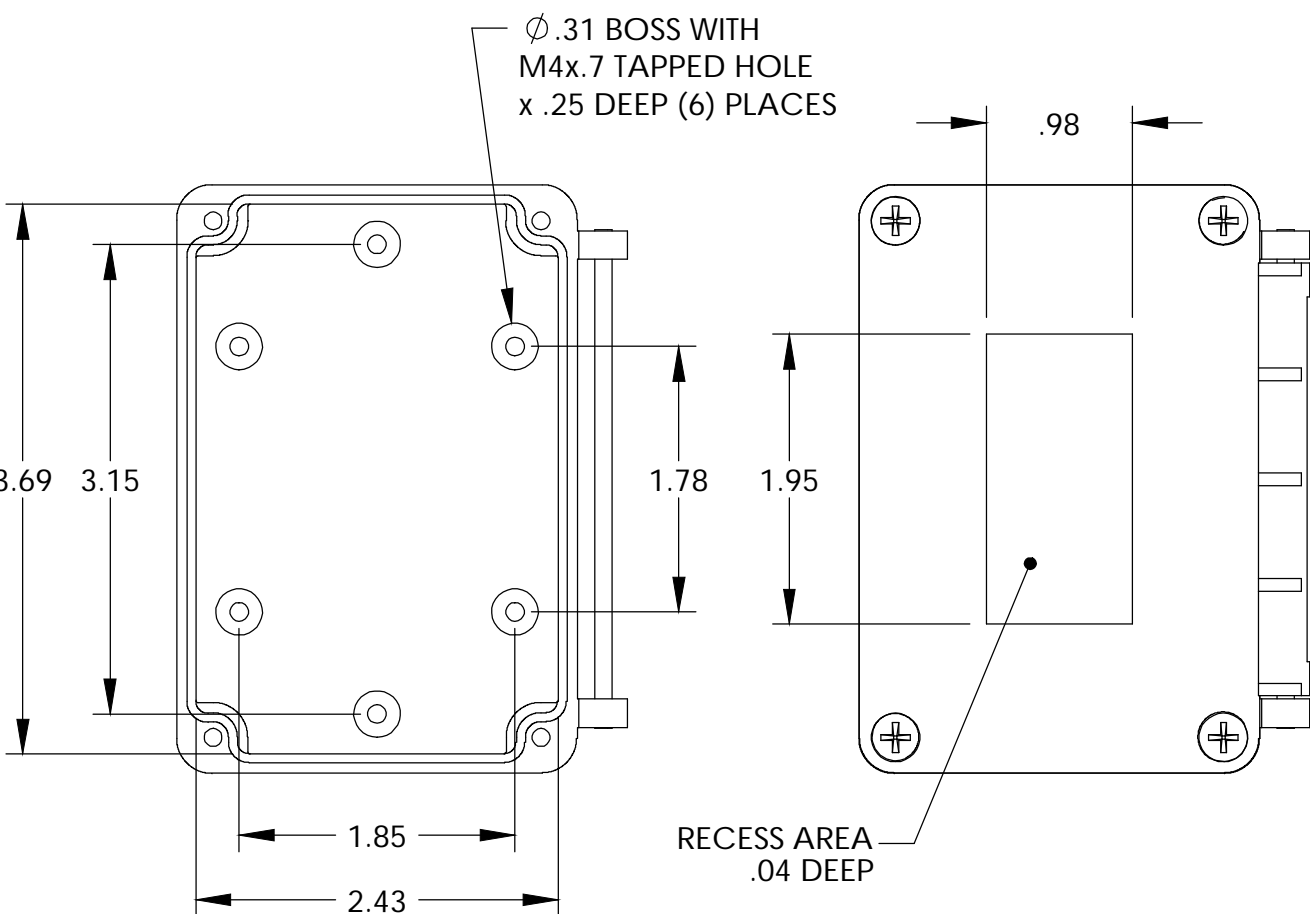
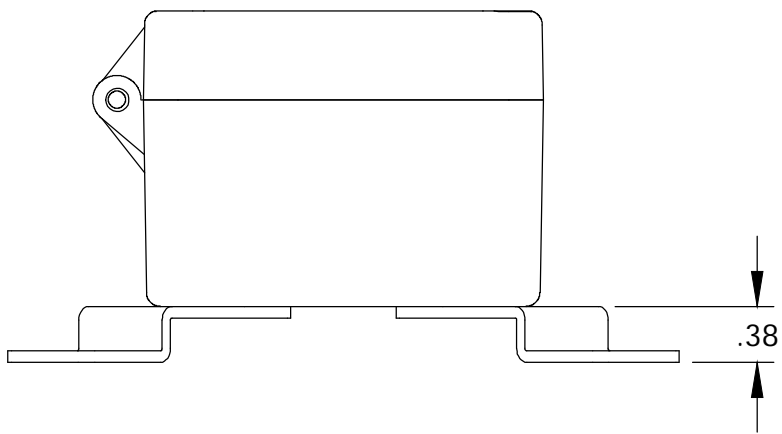
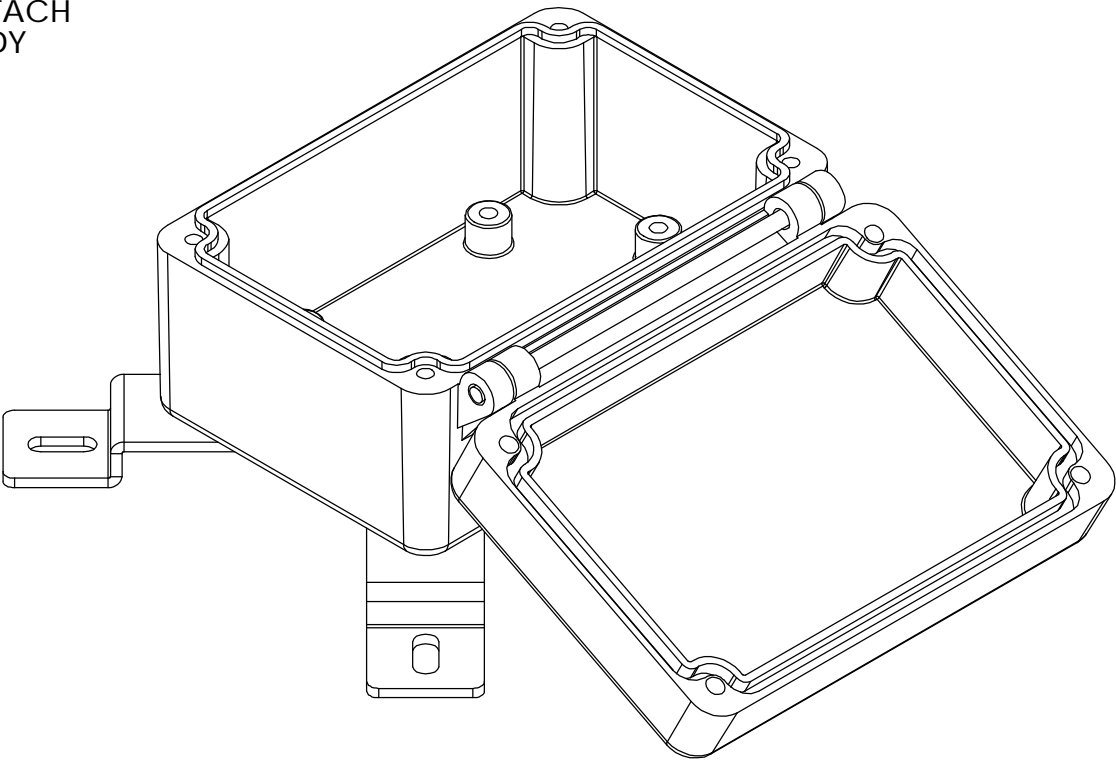
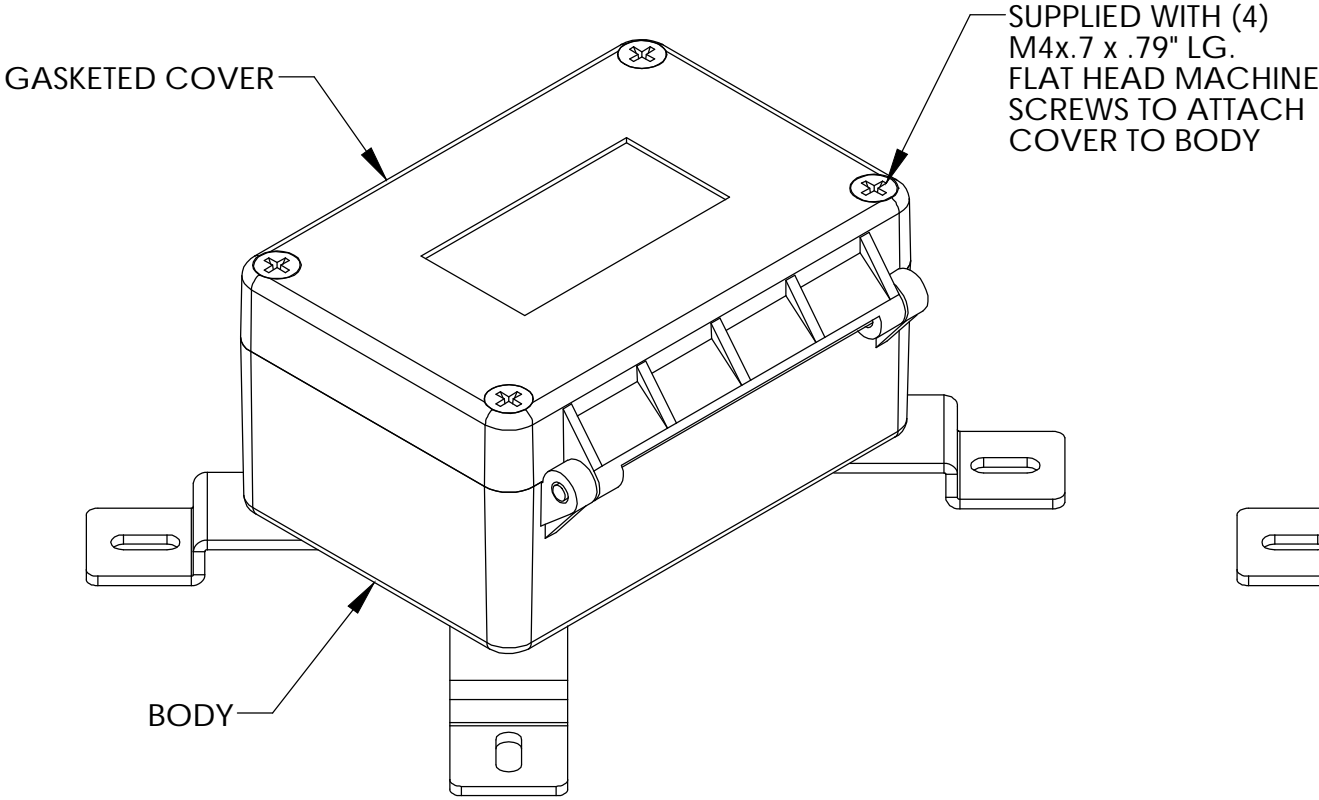
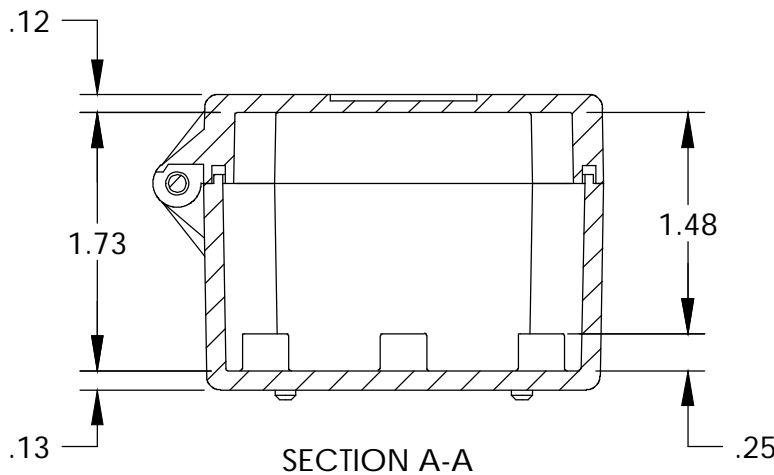
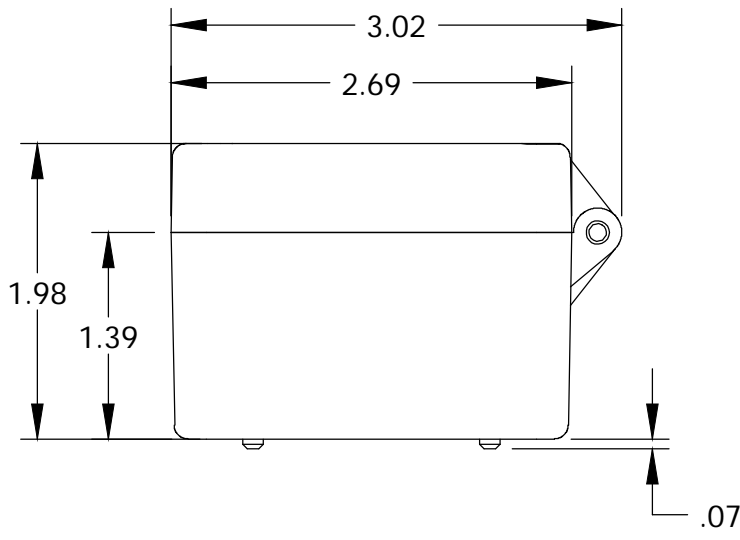

MATERIAL: ALUMINUM ADC-12  
FINISH: SMOOTH BLACK POWDERCOAT

PARTS LIST											
+/- .005 BETWEEN HOLE CENTERS +/- .015 FROM SHEARED EDGE +/- .032 FROM A BENT SURFACE +/- .062 BETWEEN ASSEMBLED SURFACES UNLESS OTHERWISE SPECIFIED MATERIAL FINISH AS NOTED AS NOTED DO NOT SCALE DRAWING				CAD GENERATED DRAWING. DO NOT MANUALLY UPDATE		BUD INDUSTRIES INC.					
				APPROVALS		DATE		NEMA HINGED BOX			
				DRAWN		5/31/05					
				CHECKED							
QTY.				USED ON		C		DWG. NO. AN-2900		REV.	
						SCALE		CAD FILE:		SHEET 1 OF 1	

# Mouser Electronics

Authorized Distributor

Click to View Pricing, Inventory, Delivery & Lifecycle Information:

[Bud Industries:](#)

[AN-2900](#)