

## 2N7002KA

## N-Channel MOSFET

### Features

- Epoxy meets UL 94 V-0 flammability rating
- Moisture Sensitivity Level 1
- High density cell design for low  $R_{DS(ON)}$
- Voltage controlled small signal switch
- Rugged and reliable
- ESD Protected up to 2.5KV (HBM)
- Halogen free available upon request by adding suffix "-HF"

### Maximum Ratings @ 25°C Unless Otherwise Specified

Symbol	Rating	Rating	Unit
$V_{DS}$	Drain-source Voltage	60	V
$V_{GS}$	Gate-source Voltage	$\pm 20$	V
$I_D$	Drain Current	340	mA
$P_D$	Total Power Dissipation	350	mW
$T_J$	Operating Junction Temperature	-55 to +150	°C
$T_{STG}$	Storage Temperature	-55 to +150	°C
$R_{thJA}$	Thermal Resistance from Junction to Ambient	357	°C/W

### Equivalent circuit

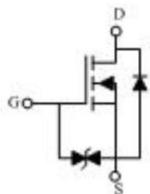

### SOT-23

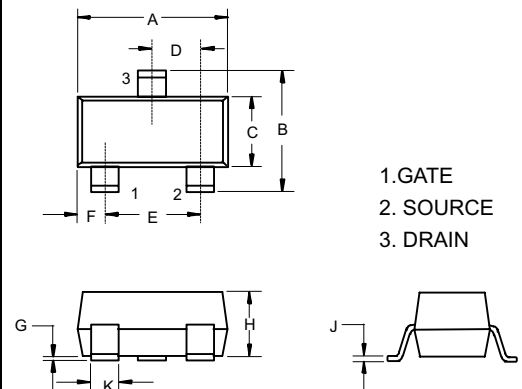

DIM	INCHES		MM		NOTE
	MIN	MAX	MIN	MAX	
A	.110	.120	2.80	3.04	
B	.083	.104	2.10	2.64	
C	.047	.055	1.20	1.40	
D	.035	.041	.89	1.03	
E	.070	.081	1.78	2.05	
F	.018	.024	.45	.60	
G	.0005	.0039	.013	.100	
H	.035	.044	.89	1.12	
J	.003	.007	.085	.180	
K	.015	.020	.37	.51	

### Suggested Solder Pad Layout

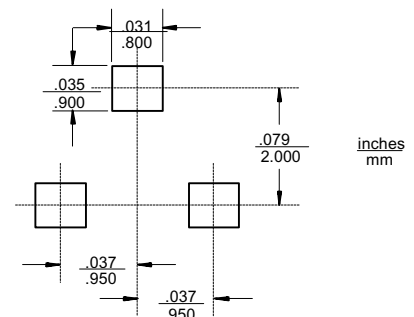

**ELECTRICAL CHARACTERISTICS**( $T_a=25^{\circ}\text{C}$  unless otherwise noted)

Parameter	Symbol	Test Condition	Min	Type	Max	Unit
Static Characteristics						
Drain-source breakdown voltage	V <sub>(BR)DSS</sub>	V <sub>GS</sub> = 0V, I <sub>D</sub> =250μA	60			V
Zero gate voltage drain current	I <sub>DSS</sub>	V <sub>DS</sub> =48V,V <sub>GS</sub> = 0V			1	μA
Gate-body leakage current	I <sub>GSS1</sub>	V <sub>GS</sub> =±20V, V <sub>DS</sub> = 0V			±10	μA
	I <sub>GSS2</sub>	V <sub>GS</sub> =±10V, V <sub>DS</sub> = 0V			±200	nA
	I <sub>GSS2</sub>	V <sub>GS</sub> =±5V, V <sub>DS</sub> = 0V			±100	nA
Gate threshold voltage*	V <sub>GS(th)</sub>	V <sub>DS</sub> =V <sub>GS</sub> , I <sub>D</sub> =250μA	1	1.4	2.5	V
Drain-source on-resistance*	R <sub>DS(on)</sub>	V <sub>GS</sub> =10V, I <sub>D</sub> =500mA		1.2	5	Ω
		V <sub>GS</sub> =4.5V, I <sub>D</sub> =200mA		1.3	5.3	
Recovered charge	Q <sub>r</sub>	V <sub>GS</sub> =0V,I <sub>S</sub> =300mA,V <sub>R</sub> =25V, dI <sub>S</sub> /d <sub>t</sub> =-100A/μS		30		nC
Dynamic characteristics**						
Input Capacitance	C <sub>iss</sub>	V <sub>DS</sub> =10V,V <sub>GS</sub> =0V,f=1MHz			40	pF
Output Capacitance	C <sub>oss</sub>				30	
Reverse Transfer Capacitance	C <sub>rss</sub>				10	
Switching Characteristics**						
Turn-on delay time	t <sub>d(on)</sub>	V <sub>GS</sub> =10 V, V <sub>DD</sub> =50V, R <sub>G</sub> =50Ω			10	ns
Turn-off delay time	t <sub>d(off)</sub>	R <sub>GS</sub> =50Ω,R <sub>L</sub> =250Ω			15	
Reverse recovery Time	t <sub>rr</sub>	V <sub>GS</sub> =0V,I <sub>S</sub> =300mA,V <sub>R</sub> =25V, dI <sub>S</sub> /d <sub>t</sub> =-100A/μS		30		
Source-Drain Diode characteristics						
Diode Forward voltage	V <sub>SD</sub>	V <sub>GS</sub> =0V, I <sub>S</sub> =300mA			1.5	V
GATE-SOURCE ZENER DIODE						
Gate-Source Breakdown Voltage	BV <sub>GSO</sub>	IGS=±1mA(Open Drain)	±21.5		±30	V

**Notes:**

\*Pulse Test: Pulse Width  $\leq 300\mu s$ , Duty Cycle  $\leq 2\%$ .

\*\*These parameters have no way to verify.

## Typical Characteristics

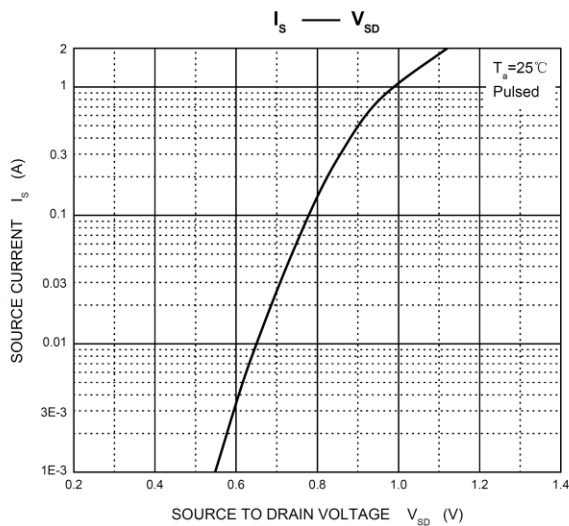
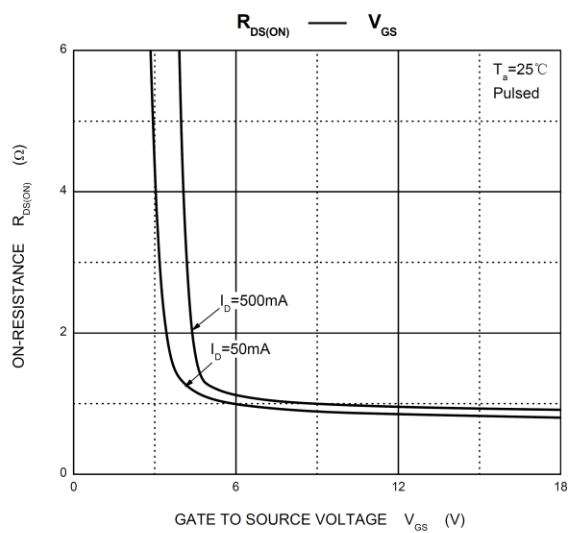
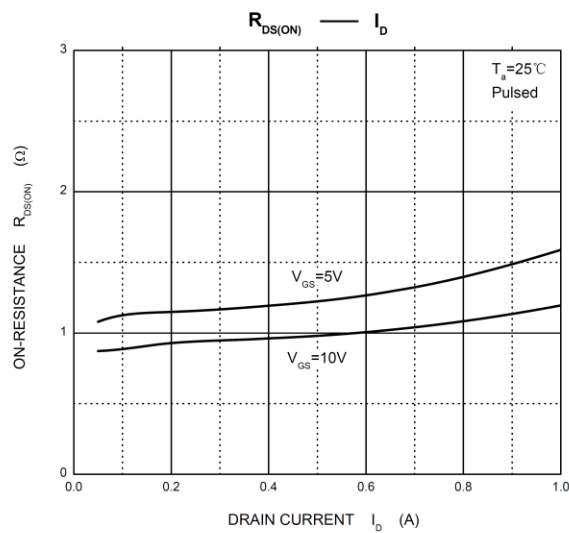
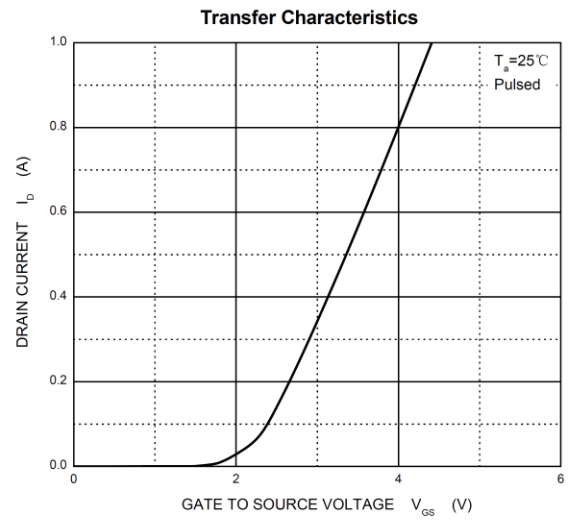
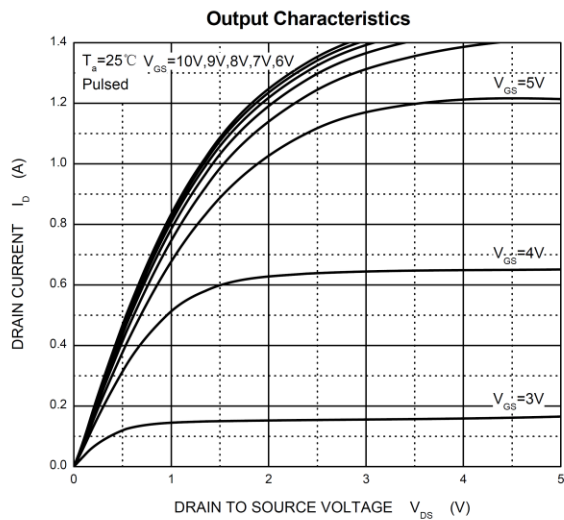

## Ordering Information :

Device	Packing
Part Number-TP	Tape&Reel: 3Kpcs/Reel

Note : Adding "-HF" suffix for halogen free, eg. Part Number-TP-HF

### \*\*\*IMPORTANT NOTICE\*\*\*

**Micro Commercial Components Corp.** reserves the right to make changes without further notice to any product herein to make corrections, modifications , enhancements , improvements , or other changes . **Micro Commercial Components Corp .** does not assume any liability arising out of the application or use of any product described herein; neither does it convey any license under its patent rights ,nor the rights of others . The user of products in such applications shall assume all risks of such use and will agree to hold **Micro Commercial Components Corp .** and all the companies whose products are represented on our website, harmless against all damages.

### \*\*\*LIFE SUPPORT\*\*\*

MCC's products are not authorized for use as critical components in life support devices or systems without the express written approval of Micro Commercial Components Corporation.

### \*\*\*CUSTOMER AWARENESS\*\*\*

Counterfeiting of semiconductor parts is a growing problem in the industry. Micro Commercial Components (MCC) is taking strong measures to protect ourselves and our customers from the proliferation of counterfeit parts. MCC strongly encourages customers to purchase MCC parts either directly from MCC or from Authorized MCC Distributors who are listed by country on our web page cited below. Products customers buy either from MCC directly or from Authorized MCC Distributors are genuine parts, have full traceability, meet MCC's quality standards for handling and storage. **MCC will not provide any warranty coverage or other assistance for parts bought from Unauthorized Sources.** MCC is committed to combat this global problem and encourage our customers to do their part in stopping this practice by buying direct or from authorized distributors.