

TYPICAL SWITCH ORDERING EXAMPLE

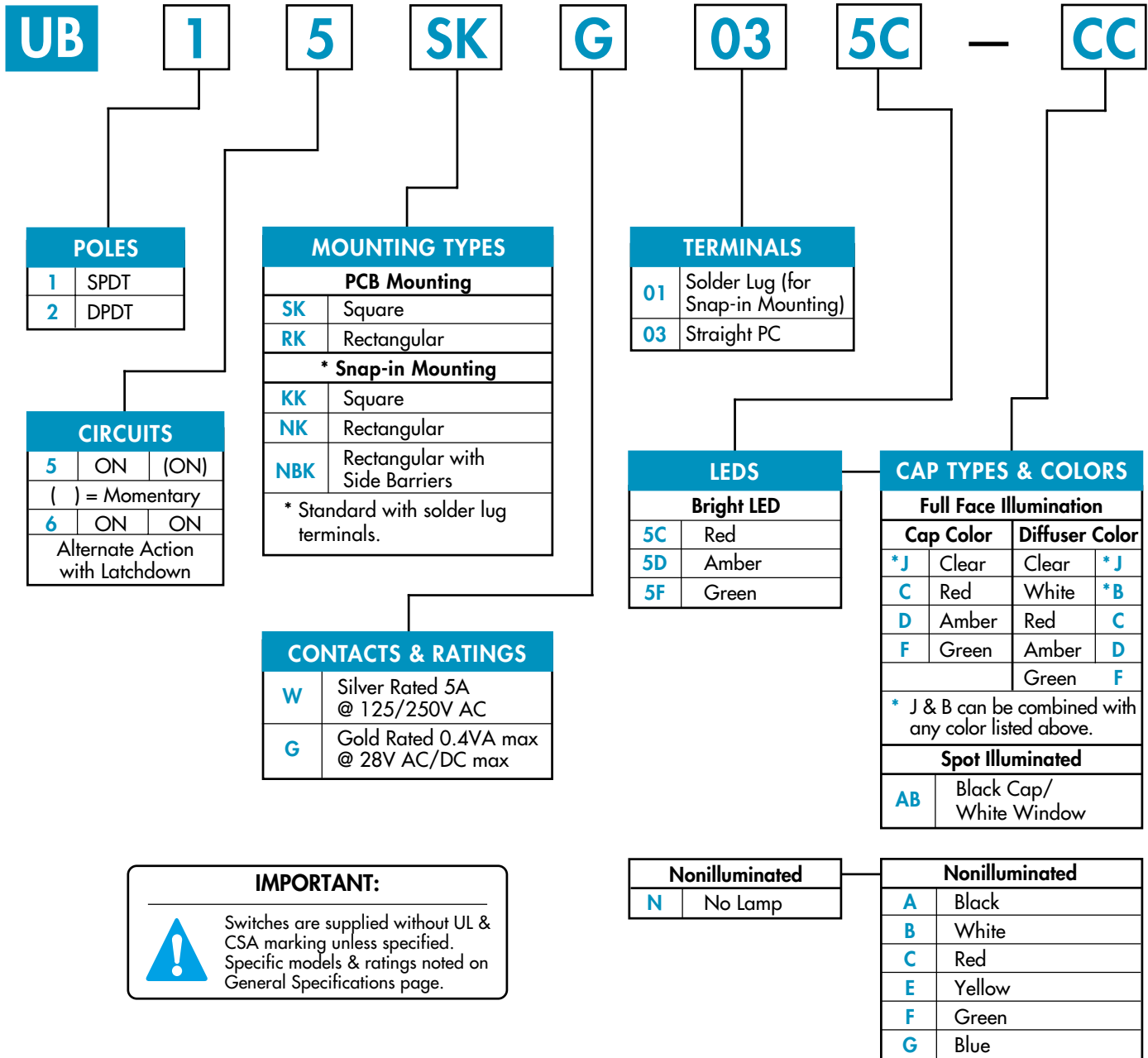

DESCRIPTION FOR TYPICAL ORDERING EXAMPLE

UB15SKG035C-CC

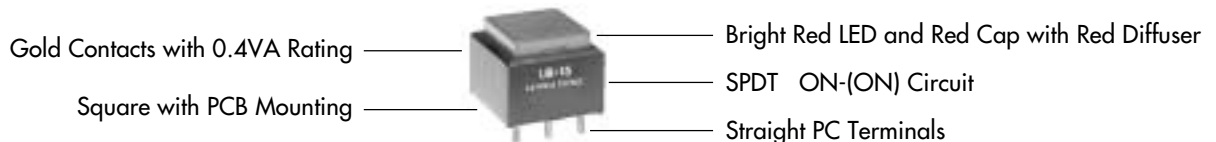

GENERAL SPECIFICATIONS

Electrical Capacity (Resistive Load)

Power Level (code W): 5A @ 125/250V AC or 5A @ 30V DC
Logic Level (code G): 0.4VA maximum @ 28V AC/DC maximum
 Note: See Supplement Index (page Z1) to find explanation of operating range.

Other Ratings

Contact Resistance: 50 milliohms maximum for silver; 100 milliohms maximum for gold
Insulation Resistance: 200 megohms minimum @ 500V DC
Dielectric Strength: 1,000V AC minimum between contacts;
 1,500V AC minimum between contacts & case
Mechanical Life: 1,000,000 operations minimum for momentary;
 200,000 operations minimum for alternate action
Electrical Life: 10,000 operations minimum for silver;
 100,000 operations minimum for silver with resistive load of 3A @ 125V AC
 200,000 operations minimum for gold
Nominal Operating Force: Single Pole: 160 grams for Square & 194 grams for Rectangular
 Double Pole: 260 grams for Square & 316 grams for Rectangular
Contact Timing: Break before make
Travel: Square: 1.7mm (.067") pretravel; 0.6mm (.024") overtravel; 2.3mm (.091") total
 Rectangular: 1.7mm (.067") pretravel; 0.7mm (.028") overtravel; 2.4mm (.095") total

Materials & Finishes

Housing/Bezel: Glass fiber reinforced polyamide
Snap-in Frame: Stainless steel
Movable Contactor: Phosphor bronze
Movable Contacts: Silver alloy or copper with gold plating over nickel
Stationary Contacts: Silver alloy or copper with gold plating over nickel
Switch Terminals: Phosphor bronze with silver or gold plating
Lamp Terminals: Brass with silver plating
Base: Glass fiber reinforced liquid crystal polymer

Environmental Data

Operating Temp Range: Illuminated: -25°C through +50°C (-13°F through +122°F)
 Nonilluminated: -20°C through +70°C (-4°F through +158°F)
Humidity: 90 ~ 95% humidity for 96 hours @ 40°C (104°F)
Vibration: 10 ~ 55Hz with peak-to-peak amplitude of 1.5mm traversing the frequency range
 & returning in 1 minute; 3 right angled directions for 2 hours
Shock: 50g acceleration (tested in 6 right angled directions, with 5 shocks in each direction)

Installation

Cap Installation Force: .77 kg (1.69 lb)
Soldering Time & Temperature: 3 seconds @ 350°C or 5 seconds @ 270°C
Process Seal: Not available

Standards & Certifications

Flammability Standards: UL94V-0 housing/bezel of GFR polyamide & base of GFR liquid crystal polymer
UL Recognized: All single & double pole models recognized at 5A @ 125/250V AC or
 0.014A @ 28V DC; UL File No. E44145
CSA Certified: All single & double pole models certified at 5A @ 125/250V AC or 5A @ 30V DC or
 0.4VA maximum @ 28V AC/DC maximum; CSA File Nos. LR23535

POLES & CIRCUITS

		Plunger Position () = Momentary		Connected Terminals		Throw & Power/Lamp Schematics
Pole	Model	Normal	Down	Normal	Down	
SP	UB15 UB16*	ON ON	(ON) ON	1-3	1-2	Notes: Switch is marked with NC, NO, COM, L+ & L-. Lamp circuit is isolated and requires external power source. SPDT
DP	UB25 UB26*	ON ON	(ON) ON	1-3 4-6	1-2 4-5	DPDT

* When in latchdown position for the alternate circuit, cap position is 1.0mm (.039") above the housing.

SHAPES & MOUNTING TYPES

PCB Mounting

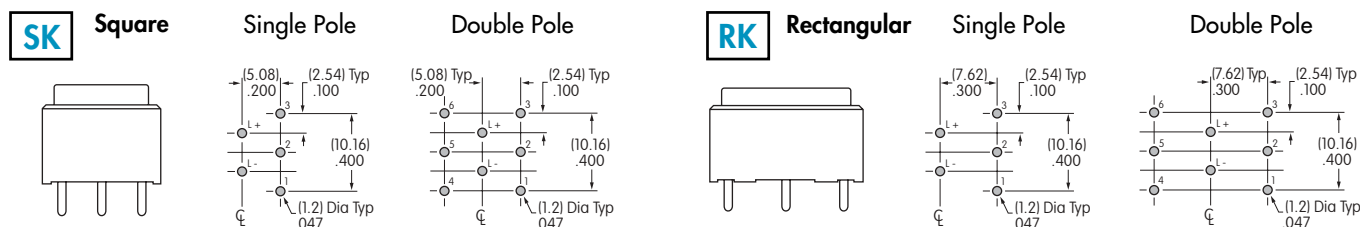

Nonilluminated models have no lamp terminals.

Snap-In Mounting

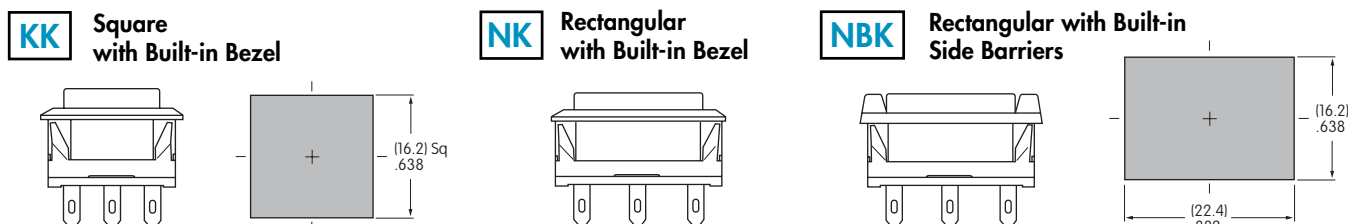

Snap-in Mounting with Solder Lug terminals is the standard combination. Panel Thickness: 1.0 ~ 3.2mm (.039 ~ .126")

CONTACT MATERIALS & RATINGS



Silver Contacts

Power Level

5A @ 125V AC & 250V AC



Gold Contacts

Logic Level

0.4VA maximum @ 28V AC/DC maximum

See Supplement Index (page Z1) for complete explanation of operating range.

TERMINALS

01

Solder Lug

The .032" x .063" oblong hole accommodates two solid or stranded 24-gauge wires.

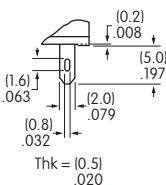

03

Straight PC

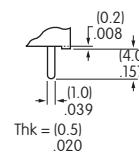

LED COLORS & SPECIFICATIONS

Electrical specifications are determined at a basic temperature of 25°C.
LED circuit is independent of switch operation. If the source voltage is greater than rated voltage, a ballast resistor is required.
The ballast resistor calculation and more lamp detail are shown in the Supplement; see Supplement Index (page Z1).

Bright LED

LEDs are an integral part of the switch and not available separately.		Color	5C	5D	5F	Unit
			Red	Amber	Green	
			30	30	25	
			20	20	20	
			1.85	2.0	2.25	
			5	5	5	
			0.40	0.42	0.46	

N Code N indicates that no lamp is used.

CAP TYPES & COLOR COMBINATIONS

Transparent Cap with Diffuser for Full Face Illuminated

Caps		Diffusers	
J Clear	AT4074 Square	J Clear (for square only)	AT4075 Diffuser for AT4074 Square Cap
C Red		B White	
D Amber	AT4117 Rectangular	C Red	AT4118 Diffuser for AT4117 Rectangular Cap
F Green		D Amber	
		F Green	

Cap & Diffuser Material: Polycarbonate Lens Finish: Glossy Diffuser Finish: Textured

Note: Both cap & diffuser colors must be selected. J & B can be combined with any color.

Spot Illuminated Cap

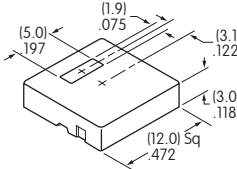
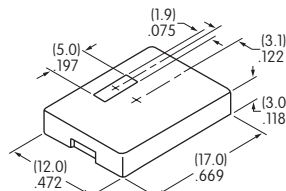
AB	AT4119 Square	AT4120 Rectangular
		
Material: Polycarbonate Finish: Matte		

Opaque Cap for Nonilluminated

Colors Available:

A Black	E Yellow
B White	F Green
C Red	G Blue

AT4073 Square

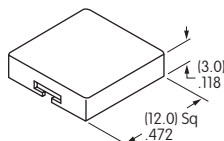

AT4116 Rectangular

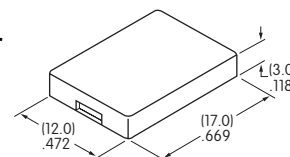

Material: Polycarbonate Finish: Glossy

TYPICAL SWITCH DIMENSIONS

Square • PCB Mount



Single & Double Pole

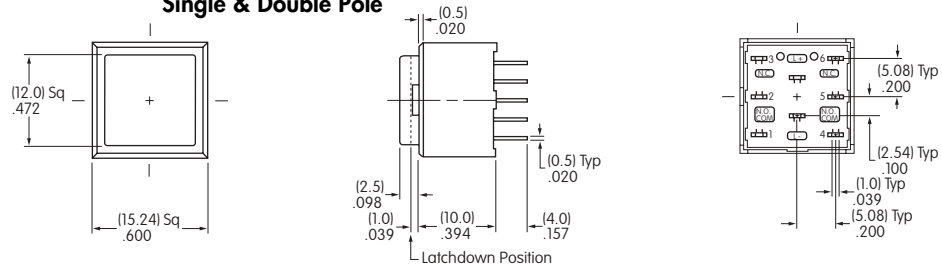

UB15SKG035C-CB

Single pole models do not have terminals 4, 5, & 6. Nonilluminated models do not have lamp terminals.

Rectangular • PCB Mount



Single & Double Pole

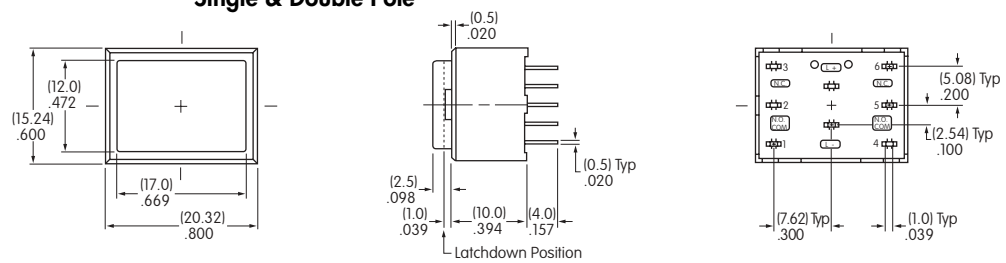

UB26RKG035D-DD

Single pole models do not have terminals 4, 5, & 6. Nonilluminated models do not have lamp terminals.

Square • Snap-in Mount • Built-in Bezel



Single & Double Pole

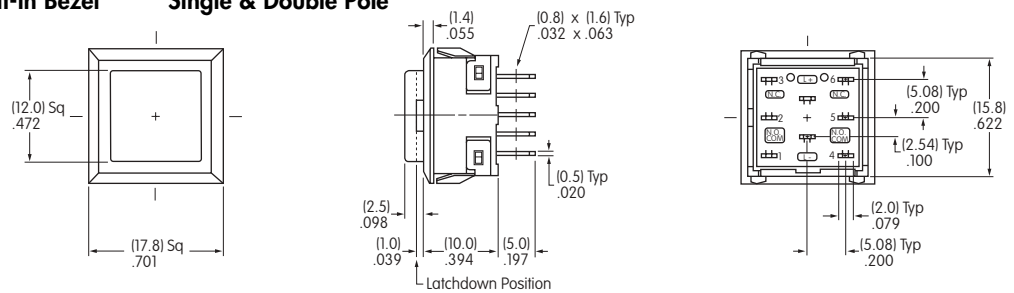

UB25KKW015C-CB

Single pole models do not have terminals 4, 5, & 6. Nonilluminated models do not have lamp terminals.

Rectangular • Snap-in Mount • Built-in Bezel

Single & Double Pole

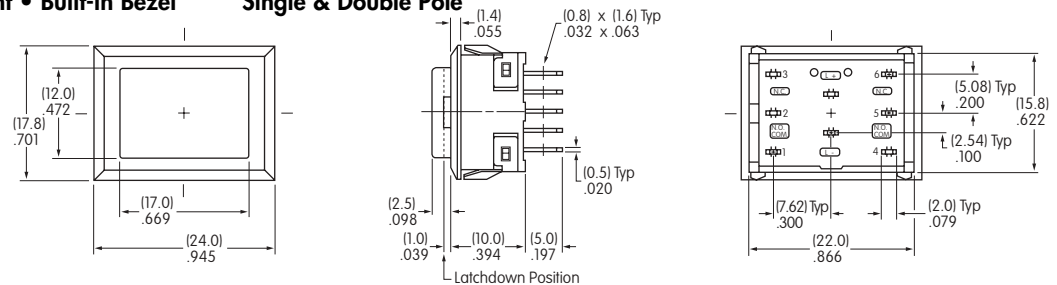

UB26NKG015F-FF

Single pole models do not have terminals 4, 5, & 6. Nonilluminated models do not have lamp terminals.

Rectangular • Snap-in Mount • Built-in Side Barriers

Single & Double Pole

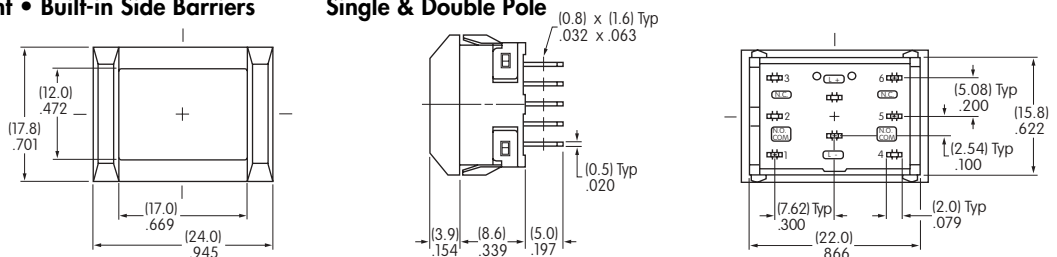

UB25NBKW015F-FB

Single pole models do not have terminals 4, 5, & 6. Nonilluminated models do not have lamp terminals.

OPTIONAL ACCESSORIES

Splash Covers

AT4001
Square

Not for use with barrier type models.

AT4011
Rectangular

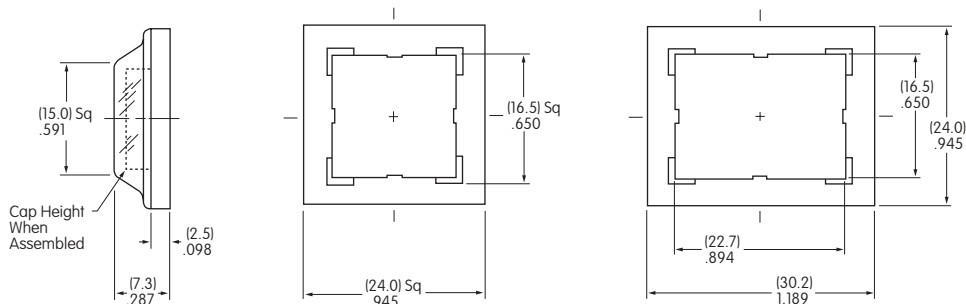
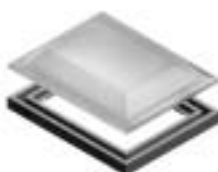
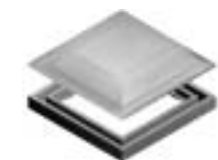

Materials:

PVC with polyethylene gasket

(PVC loses pliability below 0°C (32°F).)

Panel Thickness 1.0mm ~ 2.5mm (.039" ~ .098")