

SPECIFICATIONS



Model Number: CR0424HB-C50
Part Number: 032628

May 17, 2005

Mechanical Drawing:

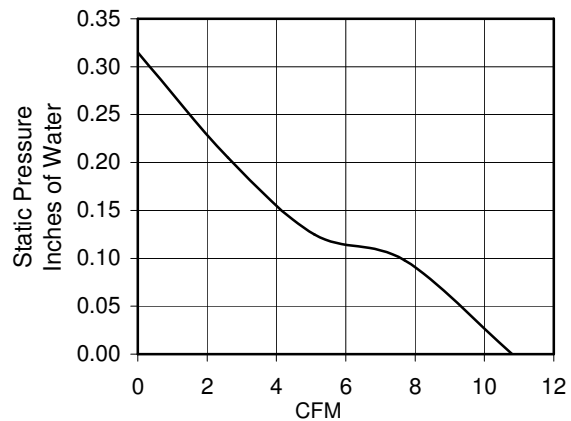
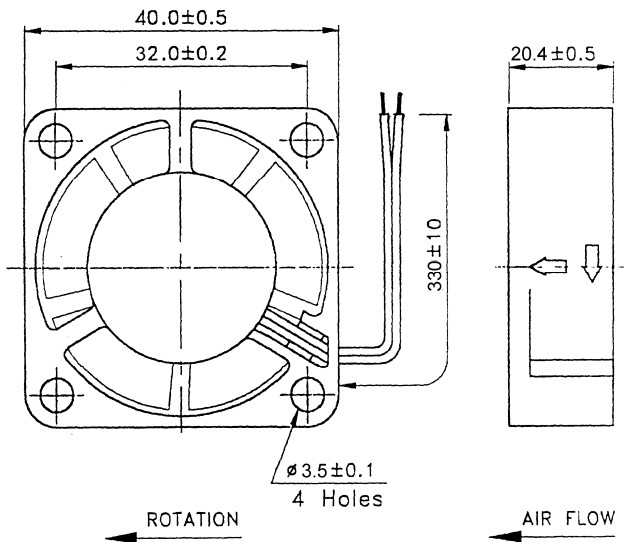

Motor:

Nominal Voltage	= 24 vdc
Operating Voltage Range	= 21.6 – 26.4 vdc
Nominal Running Current	= 0.090 amps
Locked Running Current	= 0.125 amps
Running Power	= 2.16 watts
Average Speed	= 7800 rpm
Bearings	= Ball
Air Flow	= 10 cfm
Acoustic	= 31.9 dBA

Construction:

Venturi: Plastic, Black, UL 94V-0
Propeller: Plastic, Black, UL 94V-0

Life Expectancy:

This fan is designed for continuous duty life of 50,000 hours at 25°C.

Additional Features:

Brushless DC Motor
Locked Rotor Protection
Polarity Protected
Automatic Restart Capability
Operating Temperature: -10°C to 70°C
Storage Temperature: -40°C to 75°C

Agency Approvals:

UL, cUL, TUV, CE

Termination:

330 mm Lead wires, AWG 24, UL 1007

Red = Power (+)

Black = Return (-)