

Quad Chokes

SMD

Rated voltage 42 Vac/80 Vdc
Rated current 300 to 600 mA
Rated inductance 0,47 to 4,7 mH



Construction

- Current-compensated ring core quad choke with ferrite core
- Bifilar winding

Features

- Case flame-retardant as per UL 94 V-0
- Suitable for reflow soldering

Applications

- Suppression of asymmetrical interference coupled in on lines, whereas data signals up to some MHz can pass unaffectedly
- Use e.g. in telecom applications and RF equipment

Terminals

- Tinned

Marking

Manufacturer, ordering code,
date of manufacture (month, year)

Delivery mode

Blister tape, reel packing
For details on taping, packing and packing units [see page 302](#)

Quad Chokes

SMD

Dimensional drawing

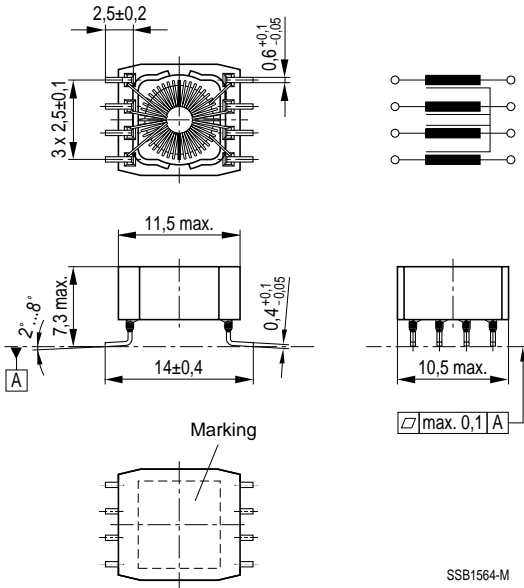

Layout recommendation

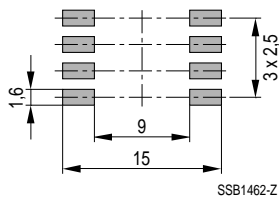

Quad Chokes



General technical data

| | |
|------------------------------------|--|
| Rated voltage V_R | 42 Vac (50/60 Hz) 80 Vdc |
| Rated current I_R | Referred to 50 Hz and 60 °C ambient temperature |
| Rated inductance L_R | Measured with HP 4275A at $L \leq 1 \text{ mH} = 100 \text{ kHz}, 10 \text{ mV}$ $L > 1 \text{ mH} = 10 \text{ kHz}, 10 \text{ mV}$ (specified per winding) |
| Inductance tolerance | – 30/+ 50 % |
| Inductance decrease $\Delta L/L_0$ | < 10 % at dc magnetic bias with I_R |
| Stray inductance L_S | Measured at $L \leq 1 \text{ mH} = 100 \text{ kHz}, 10 \text{ mV}$ $L > 1 \text{ mH} = 10 \text{ kHz}, 10 \text{ mV}$ |
| DC resistance R_{typ} | Typical values, measured at 20 °C ambient temperature |
| Solderability | (215 3) °C, (3 0,3) s wetting of soldering area $\geq 95 \%$ in accordance with IEC 60068-2-58 |
| Climatic category | 40/125/56 (– 40 °C/+ 125 °C/56 days damp heat test) in accordance with IEC 60068-1 |
| Weight | Approx. 2 g |

Characteristics and ordering codes

| L_R mH | L_S, typ nH | I_R mA | R_{typ} Ω | V_T Vdc, 2 s | Ordering code |
|-------------|------------------|-------------|-----------------------|-------------------|-------------------|
| 0,47 | 200 | 600 | 0,25 | 750 | B82792-C2474-N315 |
| 1,0 | 250 | 500 | 0,30 | 750 | B82792-C2105-N365 |
| 4,7 | 450 | 300 | 0,80 | 750 | B82792-C2475-N365 |

Quad Chokes



Insertion loss α_e (typical values at $Z = 50 \Omega$)

———— asymmetrical, all branches in parallel (common mode)

- - - - - symmetrical (differential mode)

B82792-C2474-N315

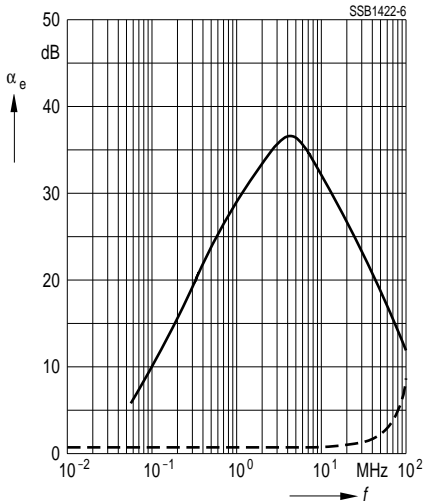

B82792-C2105-N365

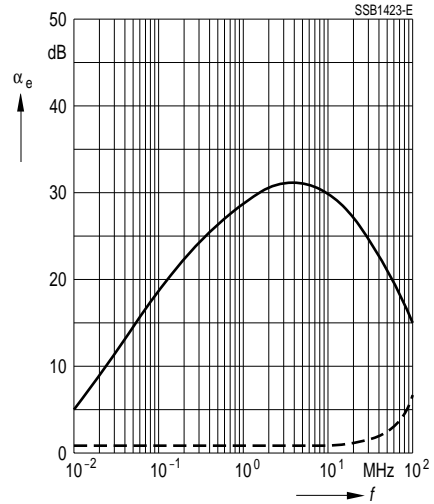

B82792-C2475-N365

