

PRODUCT NUMBER

71600-YXXLF

LEAD FREE, SEE NOTE 6

TOTAL NB OF POSITION 04 TO 64  
SEE SHEET 2

OPTIONAL STRAIN RELIEF  
SEE SHEET 2

TRIANGLE INDICATES  
POSITION 1  
NOTE 5

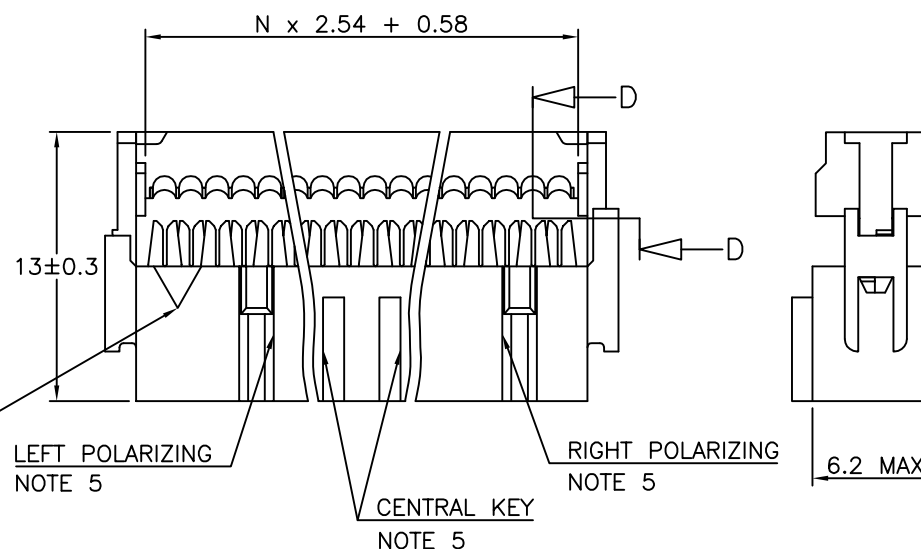

NOTES:

- 1 - PLASTIC MAT'L : GLASS FILLED HIGH TEMPERATURE THERMOPLASTIC. UL94V-0 COLOR: GREY
- 2 - PIN MATERIAL : PHOSPHOR BRONZE
- 3 - PRODUCT PACKAGED IN TUBES.
- 4 - TO DETERMINE DIMENSIONS :  
N = NUMBER OF POSITIONS PER ROW  
EXAMPLE : 8 POS  $N \times 2.54 = 20.32\text{mm}$
- 5 - 2x5, 2x6, 2x7 HAVE NO LEFT POLARIZING SLOT.  
- 2x2, 2x3 WITH CENTRAL KEY HAVE NO TRIANGLE, NO LEFT AND RIGHT POLARIZING SLOT.  
- 2x2 WITHOUT CENTRAL KEY HAS NO LEFT AND RIGHT POLARIZING SLOT.  
- 2x3, 2x4 WITHOUT CENTRAL KEY HAVE NO LEFT POLARIZING SLOT  
- 2x4 WITH CENTRAL KEY HAVE NO LEFT AND RIGHT POLARIZING SLOT
- 6 - THIS PRODUCT MEETS EUROPEAN UNION DIRECTIVES AND OTHER COUNTRY REGULATIONS AS PER GS-22-008.  
PACKAGING SPECIFICATION AS PER GS-14-920.

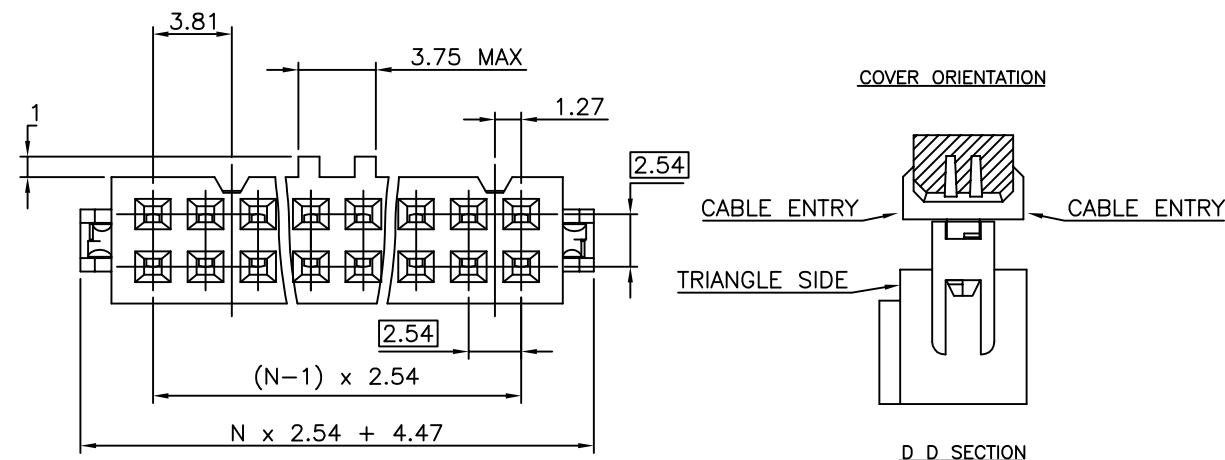

mat'l. code SEE NOTES				surface ISO 1302	tolerance ISO 406 ISO 1101	projection mm	product family 2.54MM IDC
ltr	ecn no	dr	date	tolerances unless otherwise specified			title
AP	F12-0046	LMU	12.04.25	angles	X.X ±0.3		QUICKIE III FEM
AR	B-17851	LMU	14.06.05	linear	X.XX ±0.13		0.76µm Au
					X.XXX ±0.05	scale 5:1	
AK	F05-0180	LMU	05.04.22	dr	D.LE 01.01.24		dwg no
AL	F06-0270	LMU	06.09.12	engr	P.NZ 01.01.24		sheet 1 of 2
AM	F06-0274	LMU	06.09.25	chr	JF.N 01.01.24		size
AN	F09-0233	LMU	09.12.15	appd	P.NZ 01.01.24		A3
sheet	revision	AR	AF				type
index	sheet	1	2				CUSTOMER Drawing



Copyright FCI

STRAIN RELIEF OPTION AVAILABILITY	Nbr OF POSITIONS
1/6	04
0/1/2/3/6	06
0/1/2/3/6	08
0/1/2/3/6	10
0/1/2/3/6	14
0/1/2/3/6	16
0/1/2/3/6	18
0/1/2/3/6	20
0/1/3	24
0/1/2/3/6	26
0/1/2/3/6	30
0/1/2/3/6	34
0/1/2/3/6	40
0/1/2/3/6	50
0/1/2/3/6	60
0/1/2/3/6	64
PLATING 0.76µm GOLD ON CONTACT AREA 1.27 µm Ni REMAINDER OF PRODUCT	

624
304
204 / 224
004
DASHES NOT AVAILABLE

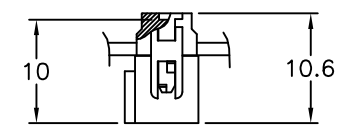

WITHOUT STRAIN RELIEF

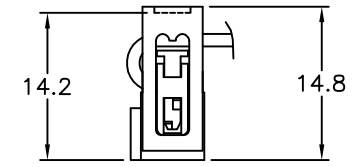

WITH LOW PROFILE STRAIN RELIEF

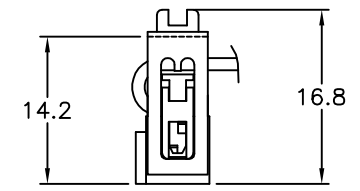

WITH STANDARD STRAIN RELIEF

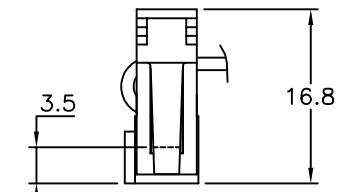

WITH LATCHING STRAIN RELIEF

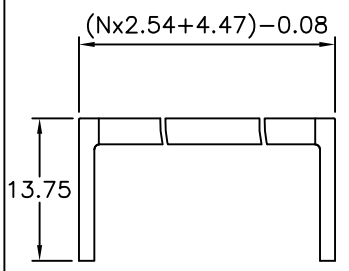

LOW PROFILE STRAIN RELIEF

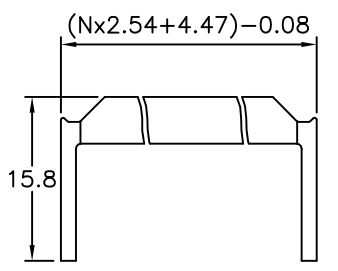

STANDARD STRAIN RELIEF

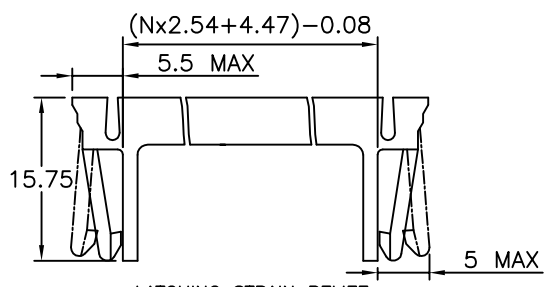

LATCHING STRAIN RELIEF FOR SLIM HEADER

71600-6YYLF	●					●
71600-3YYLF		●	●			
71600-2YYLF	●			●		
71600-1YYLF	●				●	
71600-0YYLF	●		●			
PRODUCT NUMBER	WITH	WITHOUT	STANDARD	WITHOUT	LOW PROFILE	LATCHING
	CENTRAL KEY		STRAIN RELIEF			

mat'l. code				surface	tolerance	projection	product family
ltr	ecn no	dr	date	ISO 1302	ISO 406	ISO 1101	QUICKIE
AF	B-17851	LMU	14.06.05	tolerances unless otherwise specified			
AA	F10199	GCO	01.04.26	angles	linear	mm	title
AB	F03019	DLE	03.01.23				IDC RECEPT DR
AC	F05-0180	LMU	05.04.22	engr	P.NZ		dwg no
AD	F06-0270	LMU	06.09.12	chr	JF.N		71600
AE	F06-0274	LMU	06.09.25	appd	P.NZ		sheet 2 of - size
sheet index	revision sheet						A3
							type
							CUSTOMER Drawing