

Product Data Sheet



ST722B25XX (back mount)

Replace "XX" with 02 through 06 for number of poles

**Studded Power Block
Feed Thru
175 Amps, 300 Volts AC/DC**



Wire Range:

2/0 - #8 AWG Copper Stranded Wire

2-pole shown

Mounting Screws Included

Accommodates Two Hole Compression Lugs on .625" centers – wires #2 and larger may require narrow lugs.

.73" Centers

Electrical Ratings:

- 175A (Based on NEC Table 310-16, 75°C columns)
- 300 Volts AC/DC (UL 1059 Class B – Commercial Appliances and C - General Industrial)
- Short Circuit Current Rated for 10,000 Amps.
- Factory and Field Wiring

Mechanical Ratings:

- Insulator base temperature rating: -40°C/F to 125°C (257°F) UL RTI
- Flammability rating of insulator base: UL 94 V-0
 - Use outside these ratings needs to be judged in the end-use application.

Materials:

- Studs: Brass, Nickel plated
- Hardware: Steel, zinc plated
- Insulator base: Glass-filled polycarbonate (Thermoplastic)

Agency Approvals:

- UL Recognized, UL 1059 Terminal Block Standard, File No. XCFR2.E62806
- CSA Certified to CSA C22.2 No. 158, File No. LR19766
- CE compliant to IEC 60947-7-1
- RoHS Compliant

Application Torque: 50 in-lbs. (5.6 N·m)

- Panel mountable: #6 fastener, torque to 20 in. lbs. (2.3 N·m)

Hardware Options:

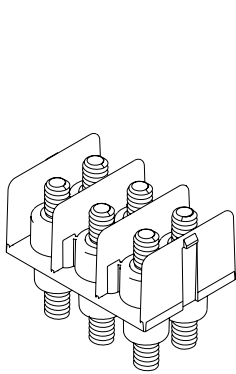

- ST722B25XX**
- No Hardware Included
 - Mounting Screws packed loose

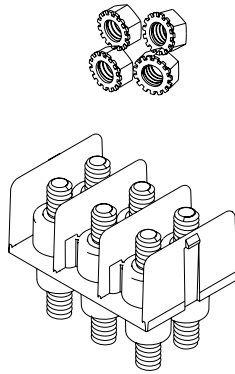

- ST722B25XXUH**
- (4) Nuts per line packed loose
 - Mounting Screws packed loose

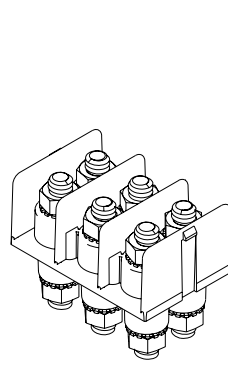

- ST722B25XXAH**
- (4) Nuts per line assembled
 - Mounting Screws packed loose

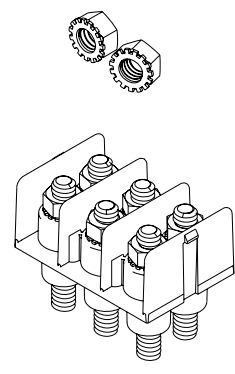

- ST722B25XXDL**
- (2) Nuts per line assembled barrier side
 - (2) Nuts per line packed loose bottom side
 - Mounting Screws packed loose

Accessories:

- Cover: order C722XX (XX = line length 1 through 6)

Mounting Cutout:

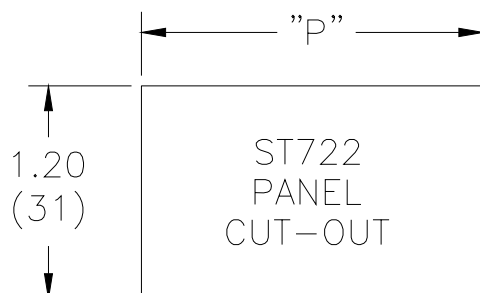

LENGTH	"P"	
	ENG.	MET.
1-LINE	.62	15.7
2-LINE	1.35	34.3
3-LINE	2.08	52.8
4-LINE	2.81	71.4
5-LINE	3.54	89.9
6-LINE	4.27	108.5

Product Dimensions:

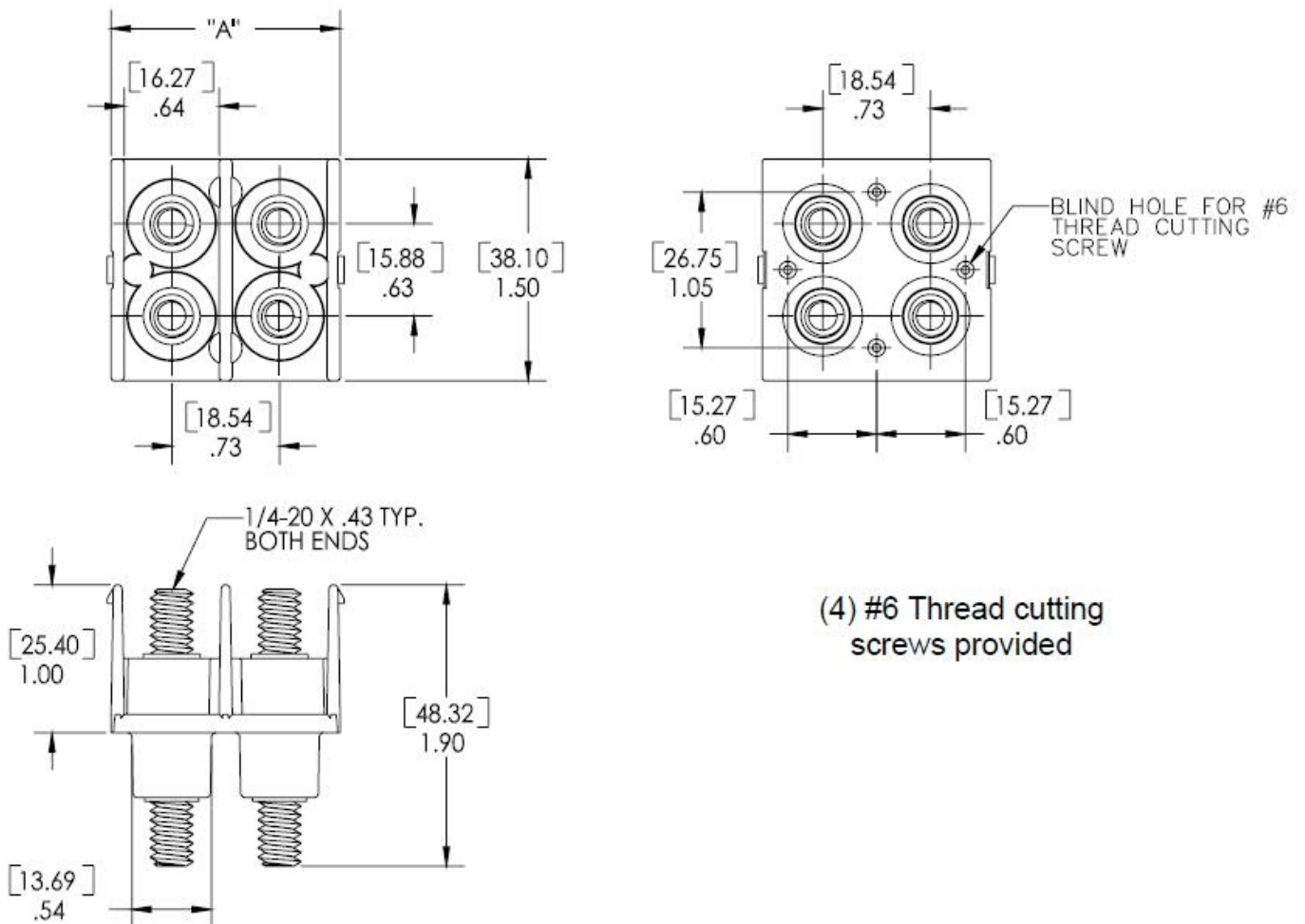

Catalog #	# of Poles	A	Metric
722	2	1.55	(39.37)
722	3	2.28	(57.91)
722	4	3.01	(75.45)
722	5	3.74	(95.00)
722	6	4.47	(113.54)

WWW.MARATHONSP.COM
1-419-352-8441